



1.5HP ABOVE GROUND POOL SAND FILTER W/ PUMP

ITEM # 75112



OWNER'S MANUAL AND SAFETY INSTRUCTIONS

SAVE THIS MANUAL. KEEP THIS MANUAL FOR SAFETY WARNINGS, PRECAUTIONS, ASSEMBLY, OPERATION, INSPECTION, MAINTENANCE AND CLEANING PROCEDURES. WRITE THE PRODUCT'S SERIAL NUMBER ON THE BACK OF THE MANUAL, OR THE MONTH AND YEAR OF PURCHASE IF PRODUCT HAS NO SERIAL NUMBER

FOR QUESTIONS, PLEASE CALL CUSTOMER SERVICE: 909.628.0880

WARNING

Read all safety warnings and instructions. Failure to follow the warnings and instructions may result in injury and/or property damage. Save all warnings and instructions for future reference.

The warning and safety instructions in this manual are not meant to cover all possible conditions and situations that may occur. Common sense, caution and care must be exercised when operating or cleaning tools and equipment. Always contact your dealer, distributor, service agent or manufacturer about problems or conditions you do not understand before operating the product.

- The sand filters are designed to work with water at temperature >than 0°C and <than 45°C. The filter should never be operated outside of these temperatures or damage may occur.

- The installation should be carried out in accordance to the safety instructions of swimming pools and the specific instructions for each facility

- The user should make sure that the installation is carried out by qualified authorized persons and that these persons have first carefully read the following instructions. Incorrectly installed equipment may fail, causing severe injury or property damage

- The operating safety of the filter is only guaranteed if the installation and operation instructions are correctly followed.

- To reduce the risk of injury, do not permit children to use this product.

- Chemical spills and fumes can weaken Swimming Pool/ Spa. Corrosion can cause filters and other equipment to fail, resulting in severe injury or property damage. Do not store pool chemicals near your equipment.

- Any modification of the filter requires the prior consent from the supplier's original replacement parts and accessories authorized by the manufacturer ensure a high level of safety. The supplier assumes no liability for the damage and injuries caused by unauthorized replacement parts and accessories.

- In the event of defective operation or fault, contact the supplier or its nearest authorized service agent.

Sand Filtration working principle

Incoming water from the piping system is automatically directed by the Multiport Valve to the top of the filter bed. As the water is pumped through the filter sand, dirt and debris are trapped by the filter bed, and filtered out. The filtered water is returned from the bottom of the filter tank, through the Multiport Valve and back through the piping system

Preparation before installation

1. Position the filter as close to the Swimming Pool/ Spa as possible.
2. The filter should be placed on a level concrete slab, very firm ground, or equivalent. Ensure that the ground will not subside, preventing any strain from the attached plumbing.
3. Position the filter under consideration of the piping connections, so that it is convenient for operating and servicing.
4. Ensure that the compliance label is facing the front to allow easy identification in the case of service difficulties.

How to install the filter tank

- 1 Put the filter tank on the base, turn right to tight up. Position the outlet drain plug is facing outside for easy operation.
2. Before filling the filter media into the filter vessel, do a visual check of the laterals. Replace the broken or loose laterals if necessary. (The laterals of side-mount valve sand filter are all installed). And then install the laterals, match the Raised Point of laterals to Folding Umbrella lateral holder, insert the laterals and turn 90° clockwise, after hearing the sound, the lateral is well installed. Please refer to the following picture.

INSTALLATION

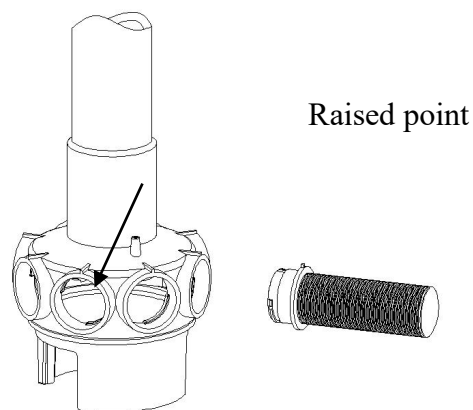

3. Check the air release hose are fixed well on the body of lateral holder, and another end of the air release hose must be out of the sand. DO NOT embedding the air release hose in the sand.
 4. To eliminate stress on the laterals, fill the filter vessel with enough water to provide a cushioning effect when the filter sand is poured in.
 5. Using the clear clamshell cover to protect the filter top mount and make sure the central stem pipe had been fully covered.
 6. Carefully pour the sand into the filter vessel and make sure to prevent sand from entering the stem pipe. And meantime do not damage the filter top mount or it will cause the leakage. And please pour the quantity of sand according to the filter tank label.
 7. Cleaning the filter top mount put the O-ring on the top mount valve and then installs the valve on the filter vessel. Make sure that the stem pipe had fixed well with the top mount valve, and tight the flange clamp to fix the valve.
- NOTE:** the flange clamp should be well fixed, or it will cause the people injures.
8. Using screws from the pump hardware pack to fix the pump on the base, please reference the pump installation to operate the pump.
 9. Adjust the valve position, using the white pressure hose to connect the pump output and input of the top valve "TO PUMP" are curve on the valve of input end.
 10. The other two connection ends of the valve, one is connection to swimming pool (it curved "TO POOL" on it) and another one is connect with drain outlet hose.

INSTALLATION NOTES

1. Make sure the filter is worked under the work pressure, and using a pressure control valve when the system using a booster pump.
2. If the pump position is higher than the water level, it requires installing the back water control valve.
3. If the pump position is lower than the water level, it requires installing an isolation valve. It could stop the water return back when people do the general inspection.
4. Reducing the connect adaptors and hose connecting bending as less as possible. Decreasing the water flow scrub, it could reach the maximum effective.
5. Ensure solvents are not excessively applied to fittings as this could run into O-ring and create sealing problems.
6. Do not over tighten fittings or adaptors

HOW TO USE

Inspect all the connections have been made correct and are secure.

OPERATION

2. Depress top mount valve handle and rotate to BACKWASH position.
3. Prime and start pump according to pump instructions.

NOTE: All suction and discharge valves must be opened when starting the system. Failure to do so could cause severe personal injury. Make sure the filter vessel is full with water before starting the pump or else it can damage the pump.

4. Once water flow is steady out the waste line, run the pump for at least 2 minutes. The initial back-washing of the filter is recommended to remove any impurities of fine sand particles in the sand media.
5. Turn pump off and set valve to RINSE position. Start pump and operate until water in sight glass is clear---about .5 to 1 minute. Turn pump off, set valve to FILTER position and restart pump. Your filter is now operating in the normal filter mode, filtering particles from the pool water.

NOTES:

1. Note the initial pressure gauge reading when the filter is clean. (It will vary from pool depending upon the pump and general piping system). As the filter removes dirt and impurities from the pool water, the accumulation in the filter will cause the pressure to rise and flow to diminish. When the pressure gauge reading is 8-10 PSI(0.55-0.69 BAR) higher than the initial "clean" pressure you noted, it is the time to backwash (clean) the filter.
2. **IMPORTANT:** To prevent unnecessary strain on piping system and valving, always shut off pump before switching filter control valve position.
3. To prevent damage to the pump and filter and for proper operation of the system, clean pump strainer and skimmer baskets regularly.

FILTER CONTROL VALVE FUNCTIONS:

Filter:

FILTER - Set valve to FILTER for normal filtering. Also use for regular vacuuming.

Backwash:

BACKWASH – For cleaning filter. When filter pressure gauge rises 8-10 PSI (0.55-0.69 BAR) above start-up (clean pressure):

Stop the pump, set valve to BACKWASH. Start pump and backwash until water in sight glass is clear.

Approximately 2 minutes or less depending on dirt accumulation. Proceed to RINSE.

Rinse:

RINSE – After backwashing, with pump off, set valve to RINSE. Start pump and operate for about 1/2 to 1 minute. This ensures that all dirty water from backwashing is rinsed out of the filter to waste, preventing possible return to the pool. Stop pump, set valve to FILTER and start pump for normal filtering.

Waste:

WASTE – To bypass filter for draining or lowering water level and for vacuuming heavy debris directly to waste.

Re-circulate:

RECIRCULATE: Water is recirculated through the pool system, bypassing the filter.

Closed:

CLOSED – Shuts off flow from pump to filter.

SPECIFICATIONS

Model No.:	Flow rate		MAX. PRESURE		FILTER AREA		MEDIA REQUIRED		
	GPM	M ³ /H	PSI	BAR	ft ²	m ²	TYPE		
							FILTERSAND*	LBS	KG
75112	49	11	50	3.5	2.0	0.19	0.45-0.56mm (0.018-0.022in)	175	75

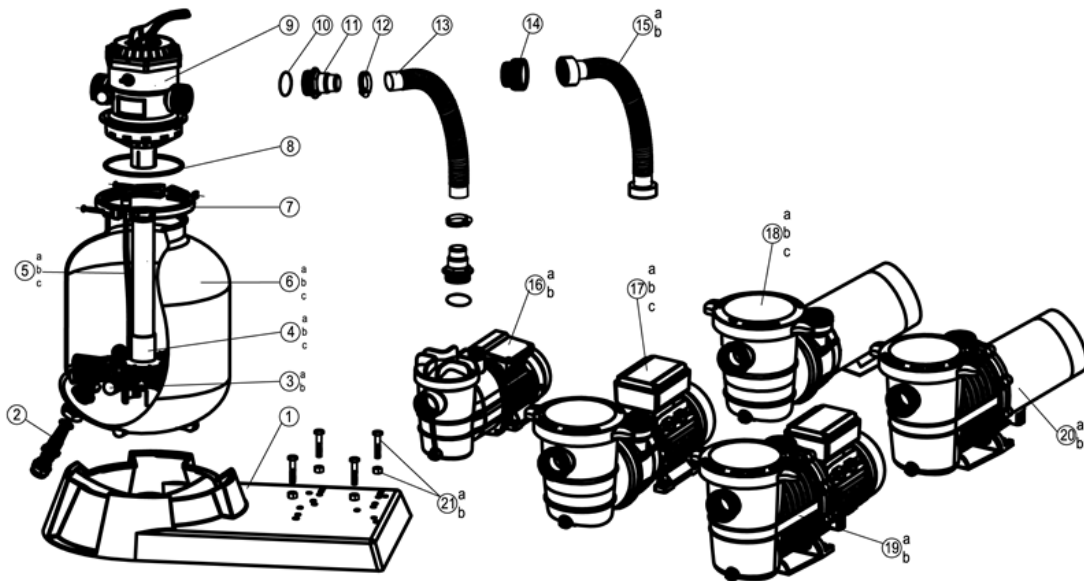

Parts Listing: 72229

Ref. No.	Part No.	Description	QTY
1	647201801080	Sand filter support for 73050	1
2	647304073	Drain plug	1
3a	647304017	Lateral for 73050	8
4b	647305071	center pipe for 73050	1
5b	647305173	Air release assembly for 73050	1
6b	647305008	Filter tank for 73050	1
7	647304072	Flange clamp	1
8	65431012080	O-ring	1
9	647304071	6-way valve	1
14	647201802001	Adaptor for 72229	1
15	647202871	PVC hose for 72229	1
18b	72729	1.0HP SPL Pump (115V-60HZ) for 72229	1
21b	65862026000	Screw M8X35 and Nut M8 for 72229	4

DISCLAIMER

PLEASE READ THE FOLLOWING CAREFULLY

THE MANUFACTURER AND/OR DISTRIBUTOR HAS PROVIDED THE PARTS LIST AND ASSEMBLY DIAGRAM IN THIS MANUAL AS A REFERENCE TOOL ONLY. NEITHER THE MANUFACTURER OR DISTRIBUTOR MAKES ANY REPRESENTATION OR WARRANTY OF ANY KIND TO THE BUYER THAT HE OR SHE IS QUALIFIED TO MAKE ANY REPAIRS TO THE PRODUCT, OR THAT HE OR SHE IS QUALIFIED TO REPLACE ANY PARTS OF THE PRODUCT. IN FACT, THE MANUFACTURER AND/OR DISTRIBUTOR EXPRESSLY STATES THAT ALL REPAIRS AND PARTS REPLACEMENTS SHOULD BE UNDERTAKEN BY CERTIFIED AND LICENSED TECHNICIANS, AND NOT BY THE BUYER. THE BUYER ASSUMES ALL RISK AND LIABILITY ARISING OUT OF HIS OR HER REPAIRS TO THE ORIGINAL PRODUCT OR REPLACEMENT PARTS THERETO, OR ARISING OUT OF HIS OR HER INSTALLATION OF REPLACEMENT PARTS THERETO.

Record Product's Serial Number Here: _____

Note: If product has no serial number, record month and year of purchase instead.

Note: Some parts are listed and shown for illustration purposes only and are not available individually as replacement parts.

The material in this manual is for informational purposes only. The product(s) it describes are subject to change without prior notice, due to the manufacturer's continuous development program. XtremePowerUS makes no representations or warranties with respect to this manual or with respect to the products described herein. XtremePowerUS shall not be liable for any damages, losses, costs or expenses, direct, indirect or incidental, consequential or special, arising out of, or related to the use of this material or the products described herein.

Questions, issues or missing parts?

Before returning to your retailer, our customer service team is here to help.



Call Us: 909.628.0880

Email Us: customer@xtremepowerusa.com

Hours of Operation: 9am - 3pm PST Monday - Friday