

STARK®

·U·S·A

18 PC DENT PULLER AUTO BODY REPAIR SET

ITEM: 26200



OWNER'S MANUAL AND SAFETY INSTRUCTIONS

SAVE THIS MANUAL: KEEP THIS MANUAL FOR SAFETY WARNINGS, PRECAUTIONS, ASSEMBLY, OPERATING, INSPECTION, MAINTENANCE AND CLEANING PROCEDURES. WRITE THE PRODUCT'S SERIAL NUMBER ON THE BACK OF THE MANUAL NEAR THE ASSEMBLY DIAGRAM (OR MONTH AND YEAR OF PURCHASE IF PRODUCT HAS NO NUMBER).

FOR QUESTIONS PLEASE CALL OUR CUSTOMER SUPPORT: (909) 628 0880 MON-FRI 9AM TO 3PM PST



It is important that you read the entire manual to become familiar with the unit before you begin assembly.

The Operator

Common sense and caution are factors which cannot be built into any product. These factors must be supplied by the operator. Please remember:

- Do not use the product if under the influence of alcohol or drugs.
- Read warning labels on prescriptions to determine if your judgment/reflexes might be impaired.
- Do not wear loose clothing or jewelry as they can be caught in moving parts.
- Protective gloves and non-skid footwear is recommended.
- Wear restrictive hair covering to contain long hair.
- Use eye and ear protection. Always wear: ANSI-approved impact safety goggles.
- Maintain proper footing and balance at all times.

Work Area

To avoid risk of personal injury, equipment damage, fire and shock, make sure your work area is:

- Free of damp, wet or rainy conditions
- Free of children (never let them handle tools or machinery) well-lit
- Clean and uncluttered

Before Operating

- Before using any tool, any part that appears damaged should be carefully checked to determine that it will operate properly and perform its intended function.
- Before using your Slide Hammer check for damaged parts.
- When operating keep hands and fingers out of the way of the hand weight.

Technical Specifications

Tool Name:	Slide Hammer Set
Slide Weight:	13lbs
Slide Pole Length:	24"
Slide Pole Diameter:	1"
Construction:	Heat Treated Steel

Attachments:

Rubber cover, Hasp iron ,Hasp iron ,Long tube Hasp iron ,Casting hammer, Hasp iron, Hex Nut ,Circular nut ,Right angle flat steel ,Circular pipe , Hex standard component ,Tapping Screw, Hex standard component, Connector, Hasp iron, double-barrelled connector, Hasp Iron

Assembly

- Your Slide Hammer set comes unassembled .
- It is Important that your read the entire manual to become familiar with the unit before you use the Slide Hammer, before assembling your Slide Hammer, be sure that you have all parts describe in the Parts Information on page 4,5.
- Assemble and disassemble your Slide Hammer set for each use.
- Put back all pieces in the carrying case provided and store in carrying case to ensure that no pieces are lost.

Operation

The Slide Hammer comes with a complete set of Pullers for various pulls. Each of the attachments Included in the Slide Hammer set have been designed for a specific use. Although uses differ, the Following steps for Hasp Pulling are generally applicable for all other attachments.

When operating ,keep hands and fingers out Of the way of the Castiron Hammer.

Hasp pulling

Step 1) Attach most suitable Hasp Iron (Part #2,#3,#5 or #7) to the threaded end of the Slide Hammer.

Step 2) Identify the lip area or edge of the object you will be inserting the chosen hasp into or onto.

Step 3) Place the Hasp into/onto the edge or lip of the object to be pulled.

Step 4) Push the Casting Hammer toward the object to be pulled. Forcefully pull the

castiron Hammer back towards the Handle, using the force of Castiron Hammer and the impact on the Hammer to pull out the object.

Step 5) Repeat Step 4 until the object has been pulled out.

PARTS INFORMATION

Parts Diagram

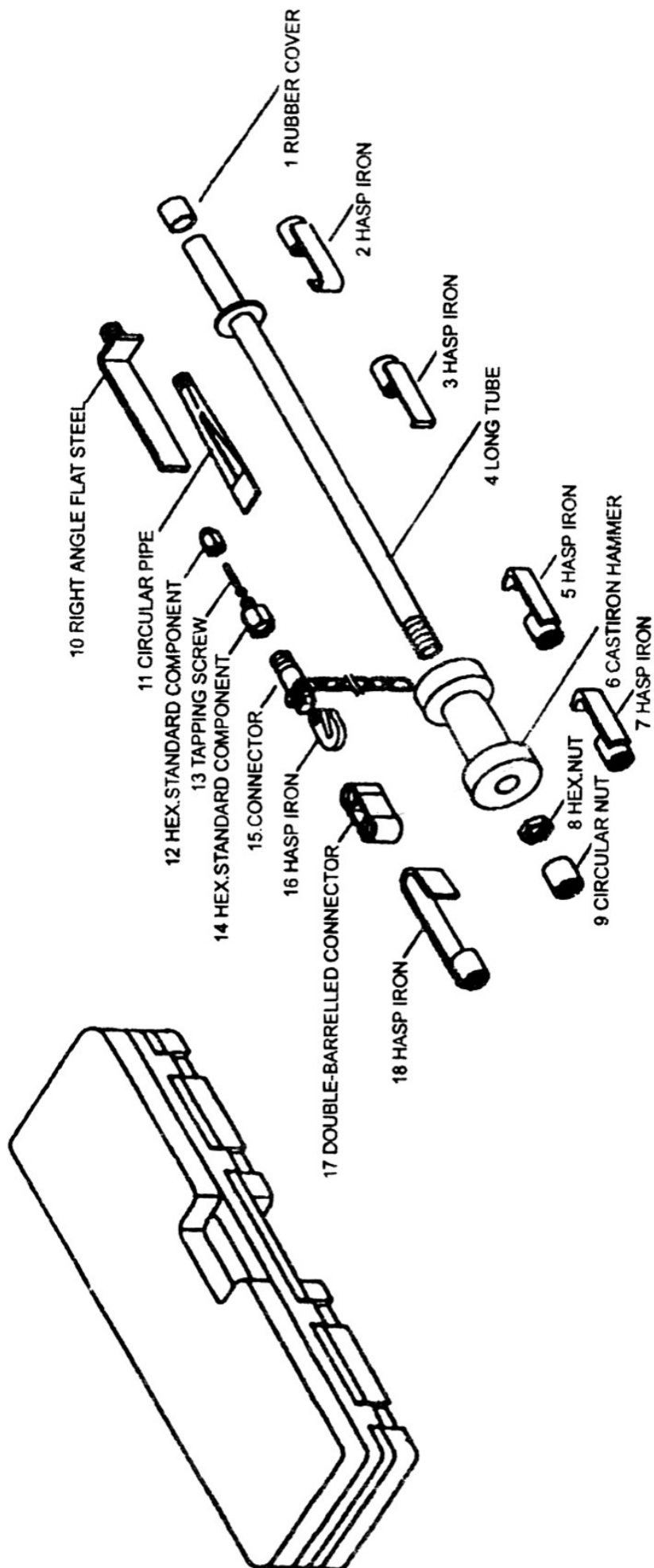

PARTS INFORMATION

Parts List

NO.	PART NAME	QTY
1	RUBBER COVER	1
2	HASP IRON (BENT 7.8x39.8)	1
3	HASP IRON (FLAT 4x39.8)	1
4	LONG TUBE	1
5	HASP IRON (GAP 7.88x30)	1
6	CASTIRON HAMMER	1
7	HASP IRON (FLAT 7.8x39.8)	1
8	HEX NUT	1
9	CIRCULAR NUT	1
10	RIGHT ANGLE FLAT STEEL	1
11	CIRCULAR PIPE	1
12	HEX STANDARD COMPONENT	1
13	TAPPING SCREW	1
14	HEX STANDARD COMPONENT	1
15	CONNECTOR	1
16	HASP IRON HOOK	1
17	DOUBLE-BARRELLED CONNECTOR	1
18	HASP IRON (BENT 7.8x39.8)	1

DISCLAIMER

PLEASE READ THE FOLLOWING CAREFULLY

THE MANUFACTURER AND/OR DISTRIBUTOR HAS PROVIDED THE PARTS LIST AND ASSEMBLY DIAGRAM IN THIS MANUAL AS A REFERENCE TOOL ONLY. NEITHER THE MANUFACTURER OR DISTRIBUTOR MAKES ANY REPRESENTATION OR WARRANTY OF ANY KIND TO THE BUYER THAT HE OR SHE IS QUALIFIED TO MAKE ANY REPAIRS TO THE PRODUCT, OR THAT HE OR SHE IS QUALIFIED TO REPLACE ANY PARTS OF THE PRODUCT. IN FACT, THE MANUFACTURER AND/OR DISTRIBUTOR EXPRESSLY STATES THAT ALL REPAIRS AND PARTS REPLACEMENTS SHOULD BE UNDERTAKEN BY CERTIFIED AND LICENSED TECHNICIANS, AND NOT BY THE BUYER. THE BUYER ASSUMES ALL RISK AND LIABILITY ARISING OUT OF HIS OR HER REPAIRS TO THE ORIGINAL PRODUCT OR REPLACEMENT PARTS THERETO, OR ARISING OUT OF HIS OR HER INSTALLATION OF REPLACEMENT PARTS THERETO.

Record Product's Serial Number Here: _____

Note: If product has no serial number, record month and year of purchase instead.

Note: Some parts are listed and shown for illustration purposes only and are not available individually as replacement parts.

Questions, issues or missing parts?

Before returning to your retailer, our customer service team is here to help.



Call Us: 909.628.4900

Email Us: info@starktoolsusa.com

Hours of Operation: 9am - 3pm PST Monday - Friday

MADE IN CHINA