

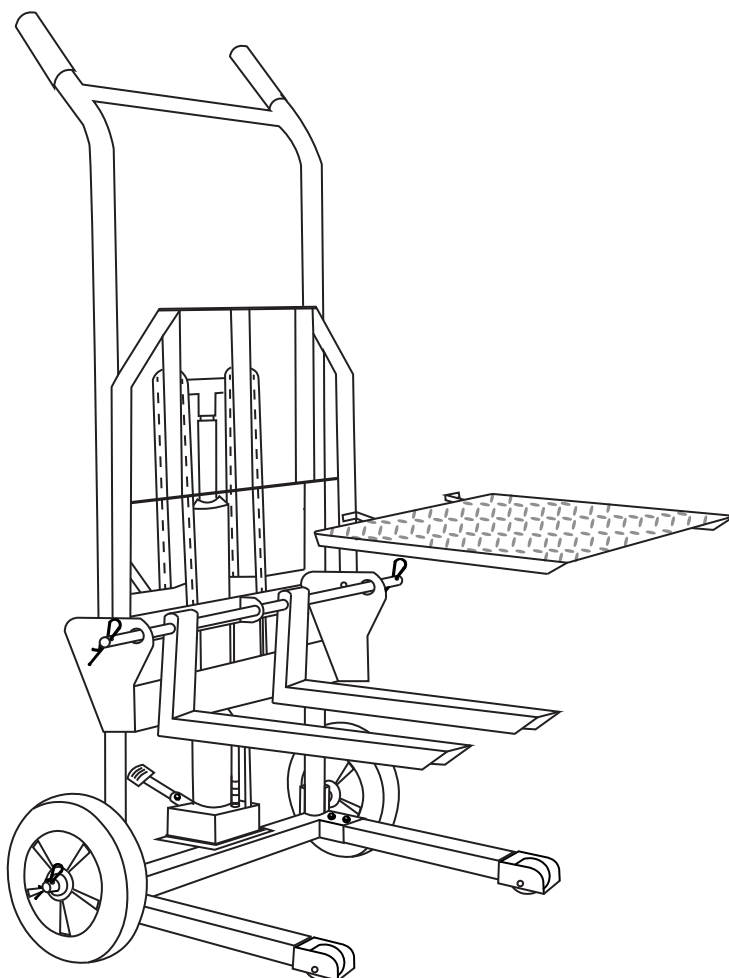

PALLET TRUCK STACKER DOLLY LIFT

WITH TABLE FORK - MAX LOAD 441 LBS

SKU: 58117



ASSEMBLY AND USER'S GUIDE

⚠ DANGER

Read all safety warnings and instructions. Failure to follow the warnings and instructions may result in serious injury. Save all warnings and instructions for future reference.

58117

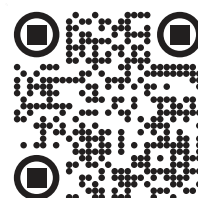

THIS PAGE INTENTIONALLY LEFT BLANK

TABLE OF CONTENTS

TABLE OF CONTENTS	1
IMPORTANT SAFETY INSTRUCTIONS	2
<i>Legends and Symbols</i>	2
GENERAL SAFETY INFORMATION.....	3
PRODUCT INFORMATION	4
OVERVIEW.....	4
INTRODUCTION.....	4
SPECIFICATION	4
PACKAGING CONTENTS.....	5
ASSEMBLY INSTRUCTIONS	6
STEP 1	6
STEP 2.....	7
STEP 3.....	8
STEP 4.....	9
STEP 5.....	10
STEP 6.....	11
STEP 7.....	12
STEP 8.....	13
STEP 9 COMPLETED WITHOUT FLAT STEEL PLATFORM.....	14
STEP 10 OPTIONAL: WITH FLAT STEEL PLATFORM.....	15
STEP 11 OPTIONAL: WITH FLAT STEEL PLATFORM.....	16
STEP 12 COMPLETED WITH FLAT STEEL PLATFORM.....	17
REPLACEMENT PARTS	18
PARTS DIAGRAM.....	18
PARTS LIST.....	19
DISCLAIMER	20
<i>Disclaimer</i>	20
<i>Customer Service</i>	20

CUSTOMER SERVICE

If you have any questions about ordering our pool pumps and replacement parts or pool products, please feel free to contact us using the following contact information:

Customer Service and Technical Support

Phone: (909) 628-0880

Email: customer@xtremepowerusa.com

Hours of Operation: Monday – Friday, 9AM – 4PM (CST)

IMPORTANT SAFETY INSTRUCTIONS

IMPORTANT SAFETY INSTRUCTIONS

This guide provides instructions for installing and using the Pallet Truck Stacker Dolly Lift. If you have any questions about the equipment, please contact XtremepowerUS.

This guide contains important information about safely installing and operating this product. After installation, make sure to share this information with the owner/operator or leave it with them for their reference.

Legends and Symbols

When you come across the safety-alert symbol on your equipment or in this manual, pay attention to the following signal words and remain vigilant about the potential for personal injury.



DANGER: Ignoring these hazards can result in death, severe personal injury, or significant property damage.



WARNING: Indicates potential hazards that can result in severe personal injury, death, or significant property damage. Ignoring these warnings presents a real danger.



CAUTION: Indicates potential hazards that can result in minor or moderate personal injury, property damage, or actions that are unpredictable and unsafe. Ignoring these cautions presents a potential hazard.



NOTE: This label indicates important special instructions that are not directly related to hazards.

USE OF NON-XTREMEPOWERUS REPLACEMENT PARTS VOIDS WARRANTY

ATTENTION INSTALLER: This manual contains vital information regarding the installation, operation, and safe use of this product. It is essential to provide this manual to the end user of the product. Failure to read and follow all instructions could lead to severe injuries.



Failure to comply with all instructions and warnings may lead to severe bodily injury or even death. For optimal safety and functionality, it is advisable to have the product installed and serviced by a certified service professional. Prior to using this product, installers, operators, and owners must carefully review these warnings and all instructions provided in the owner's manual. It is essential to leave these warnings and the owner's manual with the owner for their reference and safety.



For safety reasons, children should not be allowed to use this product. Packing materials and plastic bags are not toys. Keep them away from children to prevent the risk of suffocation.

IMPORTANT SAFETY INSTRUCTIONS

GENERAL SAFETY INFORMATION

DANGER

- Exceeding Load Capacity: Never exceed the recommended load capacity. Overloading can lead to tipping or mechanical failure, posing serious risks.
- Emergency Lowering: In case of an emergency, lower the load immediately if safe to do so.

WARNING

- Training and Competence: Ensure all operators are properly trained and competent in the safe operation of this equipment.
- Pre-Use Inspection: Conduct thorough inspections before use to check for any damage or malfunctions, particularly in the hydraulic system and lifting mechanisms.
- Operating Conditions: Operate only on flat, stable surfaces to prevent accidents. Avoid uneven terrain and slopes.
- Visibility Obstruction: Do not operate if the load obstructs the view. Use a spotter or operate in reverse if necessary.
- Avoid Riding on Forks: Riding on the forks is strictly prohibited.
- Stay Clear of Underneath Forks: Do not remain underneath the forks at any time.



CAUTION

- Stable Loading: Always ensure that loads are stable and securely positioned on the forks. Use straps or wraps to secure the load as needed.
- Clear Path: Make sure the travel path is free of obstacles and bystanders before moving.
- Speed Control: Move at a controlled speed to prevent load shifting that can lead to instability or accidents.
- Regular Maintenance: Follow the manufacturer's guidelines for routine maintenance and check all operational parts regularly.

NOTE

- Proper Storage: Keep the equipment clean and store in a dry area to avoid rust and corrosion.
- Report Issues: Immediately report any accidents or equipment malfunctions to a supervisor or maintenance team.
- Wear PPE: Always wear the appropriate personal protective equipment (PPE), including safety shoes, gloves, and, if necessary, eye and ear protection.
- Proper Use: Never use the dolly lift for riding or purposes other than its intended use.

PRODUCT INFORMATION

PRODUCT INFORMATION

OVERVIEW

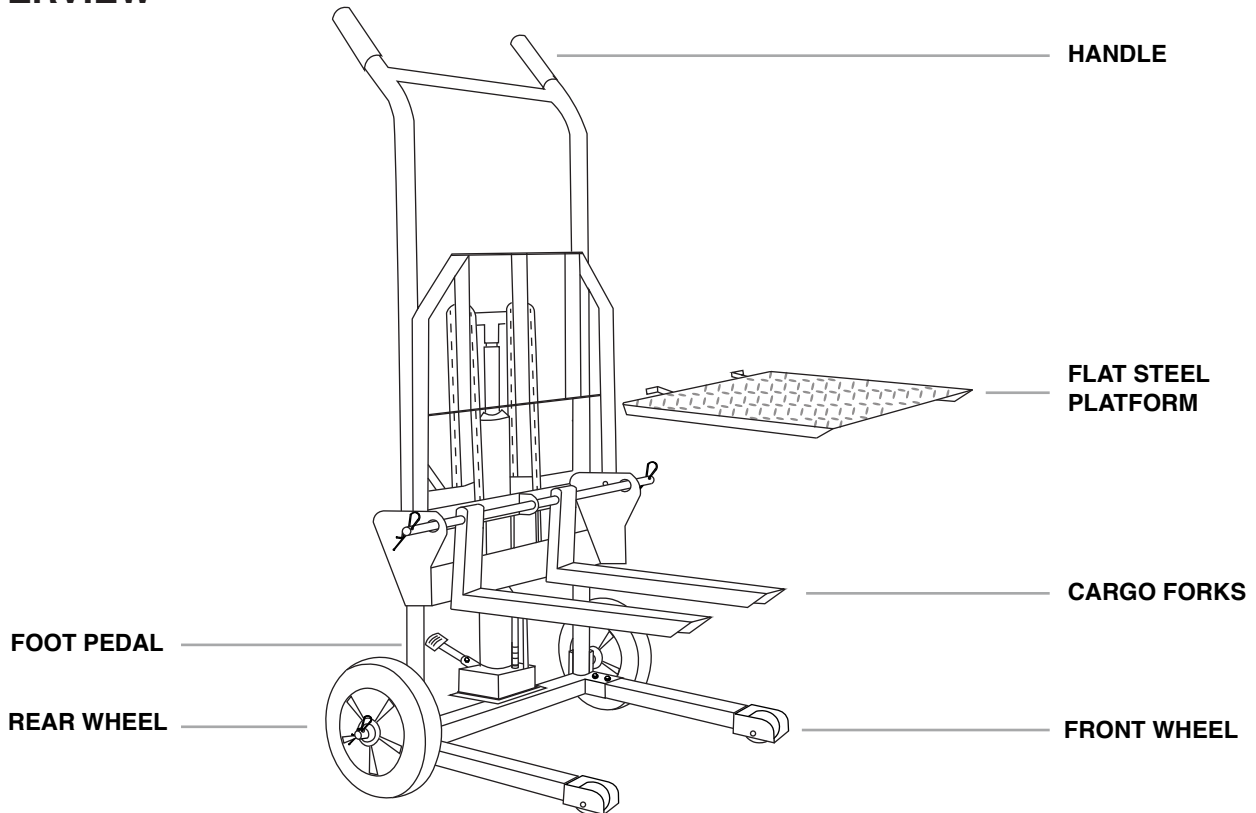

INTRODUCTION

XtremepowerUS Pallet Truck Stacker Dolly Lift with Table Fork, a versatile lifting and handling solution for warehouses and distribution centers. This robust tool combines a pallet truck and stacker, equipped with a durable table fork to manage various load sizes and types efficiently. Its design ensures stability, durability, and easy maneuverability in tight spaces, enhancing productivity and reducing physical strain for operators. Ideal for daily operations and heavy lifting tasks.

SPECIFICATION

TYPE	COMBINATION FORK & FLAT BED
MAXIMUM LOAD CAPACITY	441 LBS
FORK DIMENSIONS (L X W)	18.5" X 2.75"
FORK ADJUSTMENT RANGE	0" ~ 20"
LIFT HEIGHT RANGE	2.75" ~ 36"
OVERALL DIMENSIONS (H X W X L)	30" X 32" X 49"
WHEEL MATERIAL	RUBBER
WHEEL SIZE	FRONT: 2", REAR: 9"
BASE LEGS DIMENSIONS (W X L)	2" X 18.5"
WEIGHT WITH STEEL PLATFORM	95 LBS
WEIGHT WITHOUT STEEL PLATFORM	85 LBS
FLAT STEEL PLATFORM DIMENSIONS	18.5" X 21.7"

PRODUCT INFORMATION

PRODUCT INFORMATION

PACKAGING CONTENTS

SKU 58117

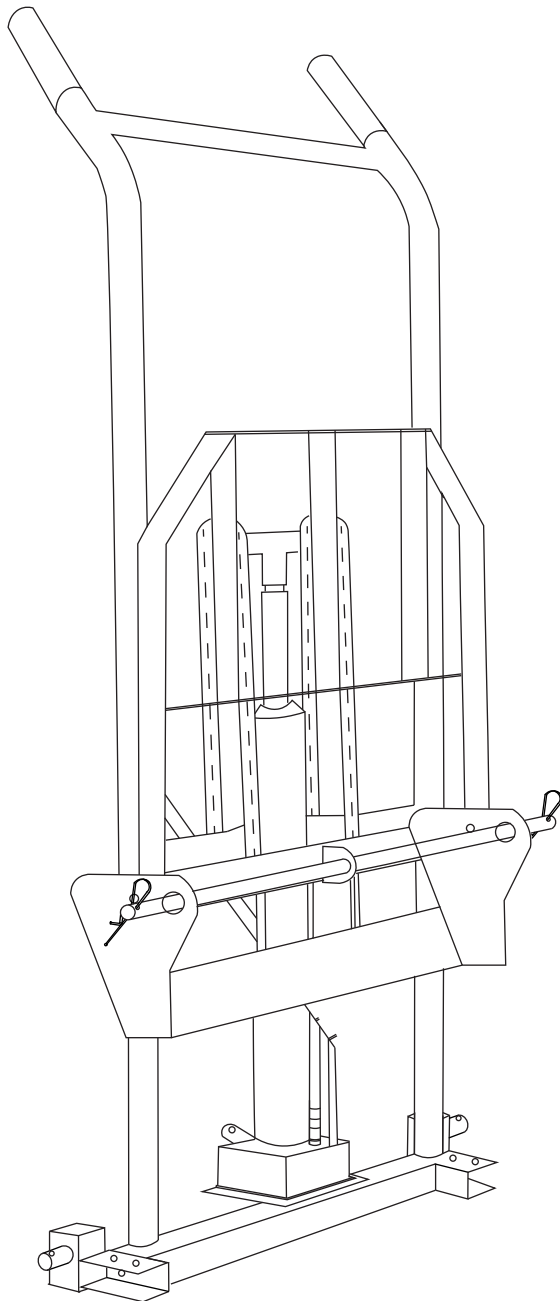

LIFT ASSEMBLY 1 PC(S)

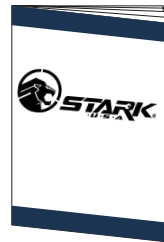

**INSTRUCTION MANUAL
1 PC(S)**

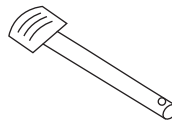

**PARTS # 2
FOOT PEDAL
1 PC(S)**

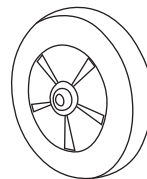

**PARTS # 3
9 INCH REAR WHEEL
2 PC(S)**

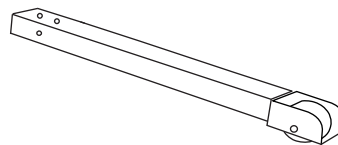

**PARTS # 4
2 INCH FRONT WHEEL
ASSEMBLY
2 PC(S)**



**PARTS # 5
FORKS
2 PC(S)**

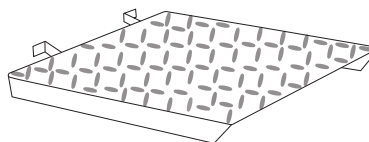

**PARTS # 7
FLAT STEEL PLATFORM
1 PC(S)**



**PARTS # 8
LOCKING PIN
2 PC(S)**



**PARTS # 9
SCREW
1 PC(S)**



**PARTS # 10
SCREW WITH WASHER
4 PC(S)**

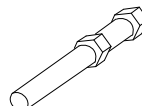

**PARTS # 11
SCREW WITH NUT
2 PC(S)**

ASSEMBLY INSTRUCTION

STEP 1

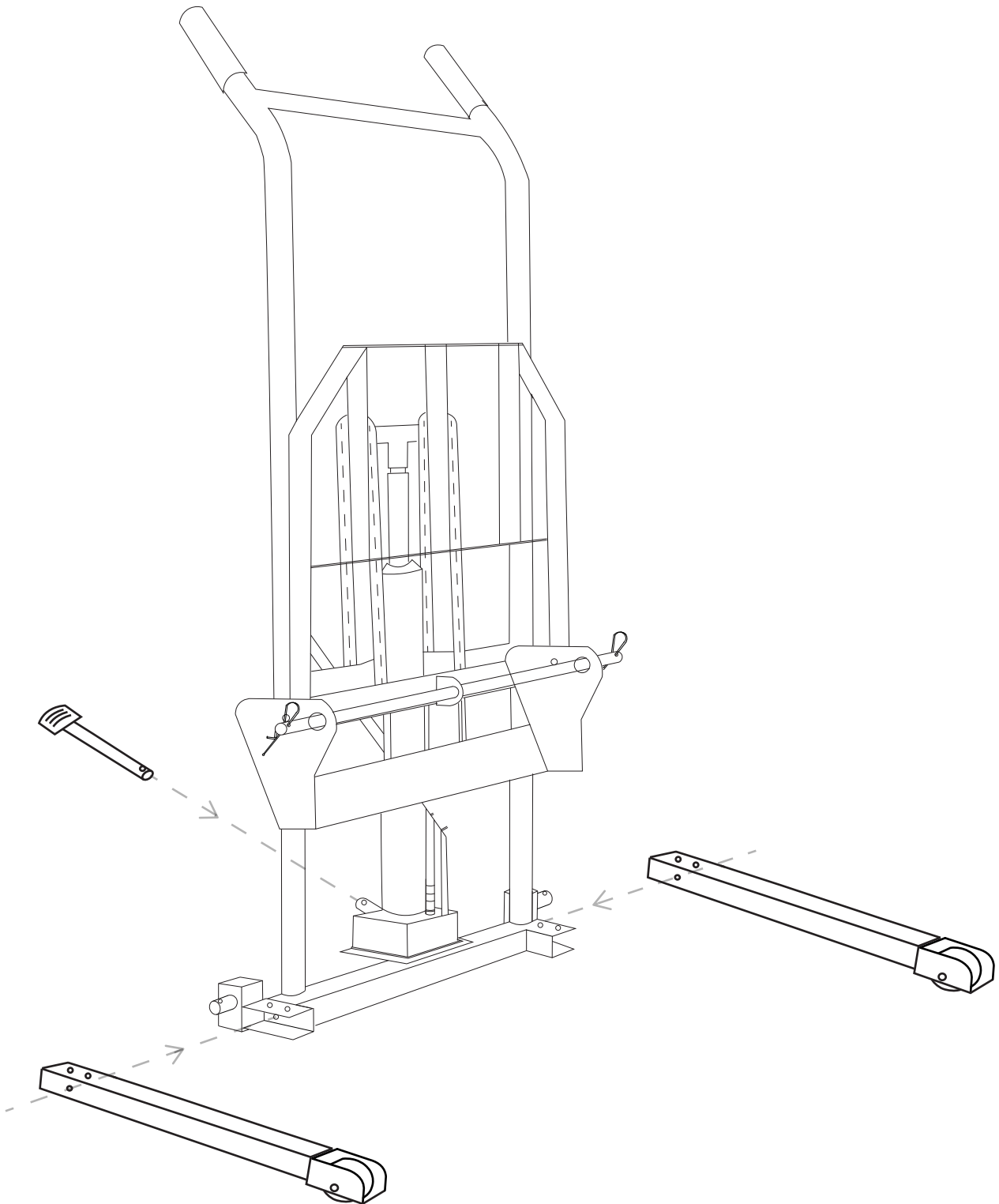

ASSEMBLY

STEP 2

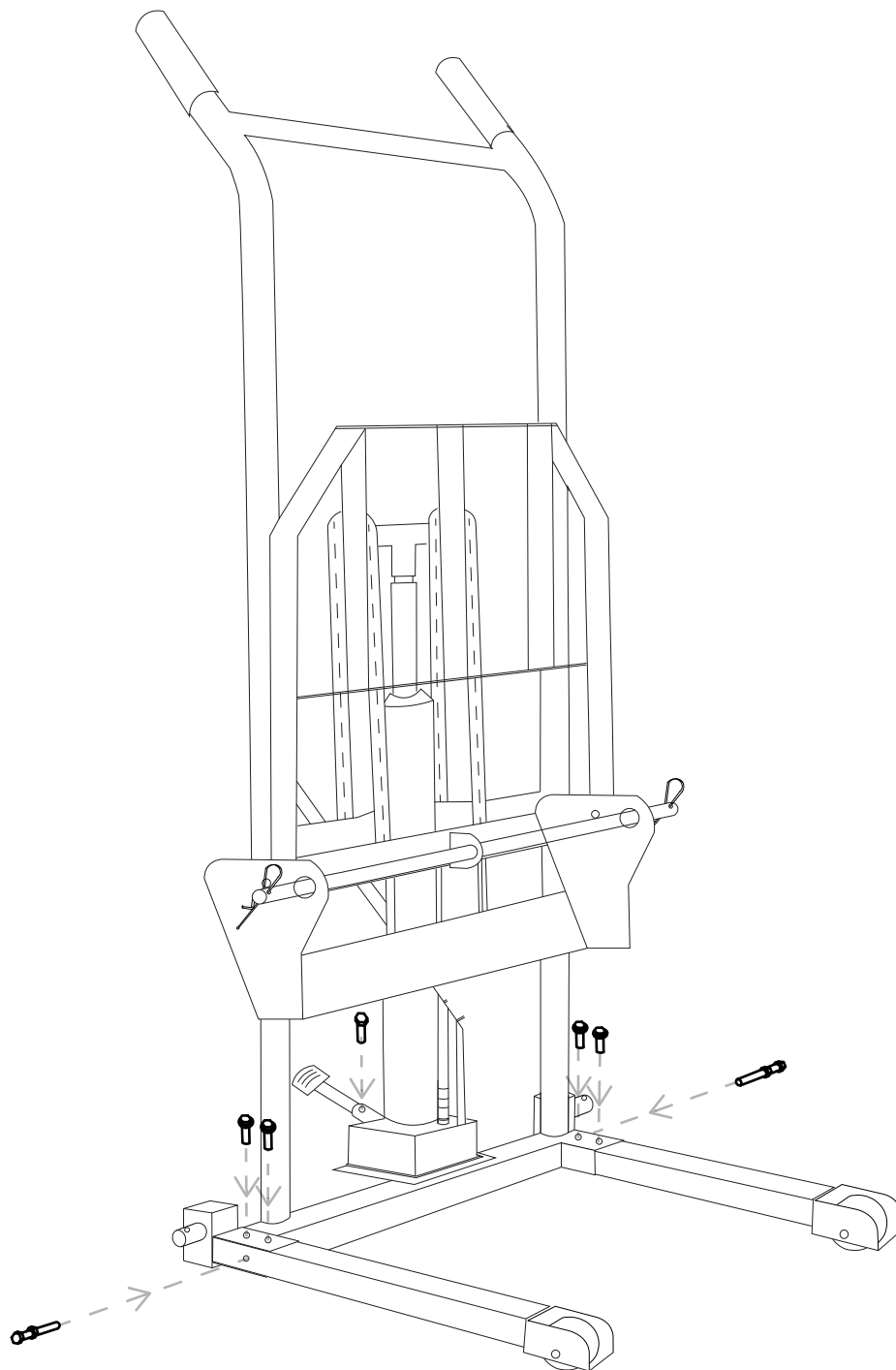

ASSEMBLY

STEP 3

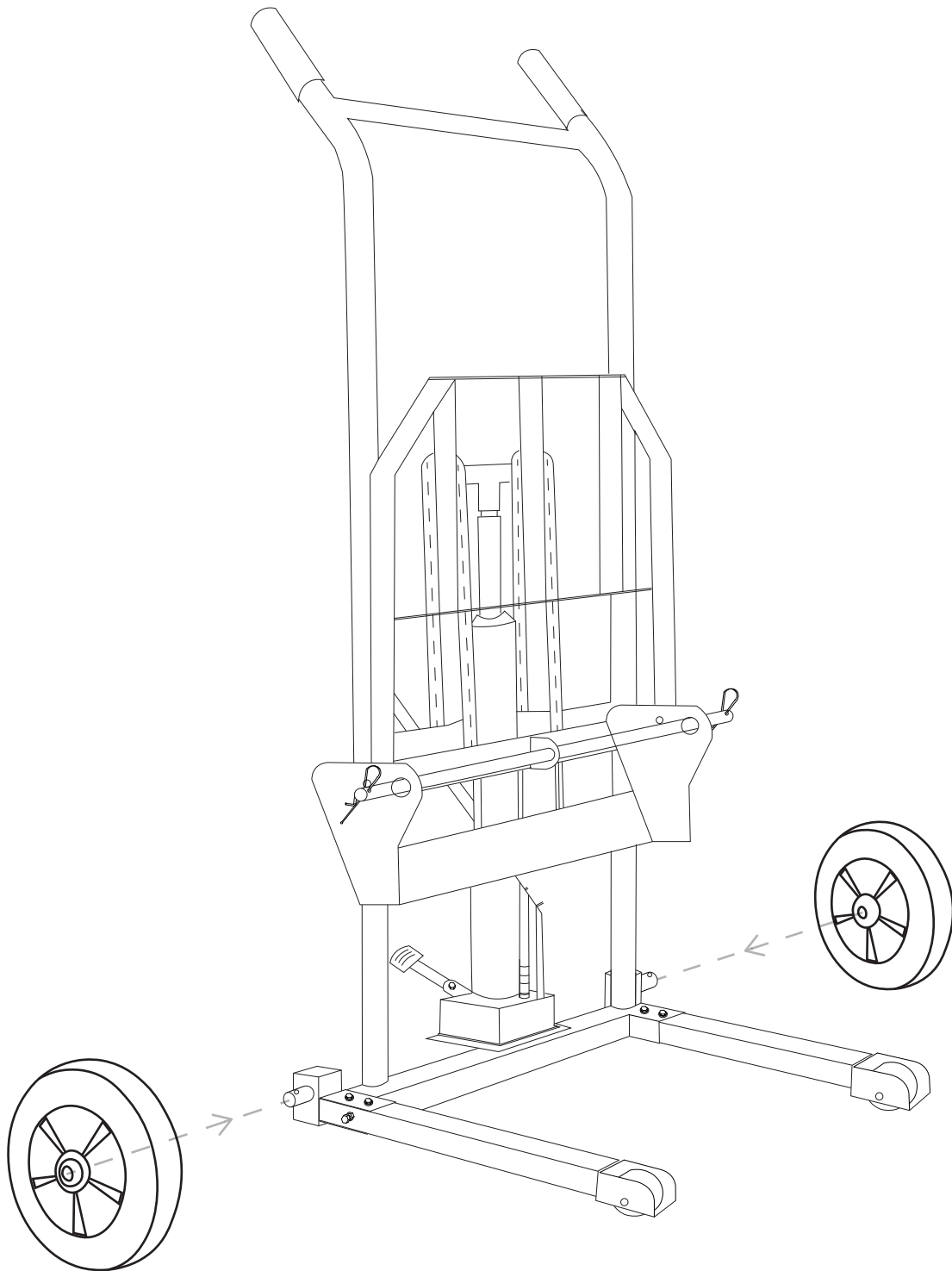

ASSEMBLY

STEP 4

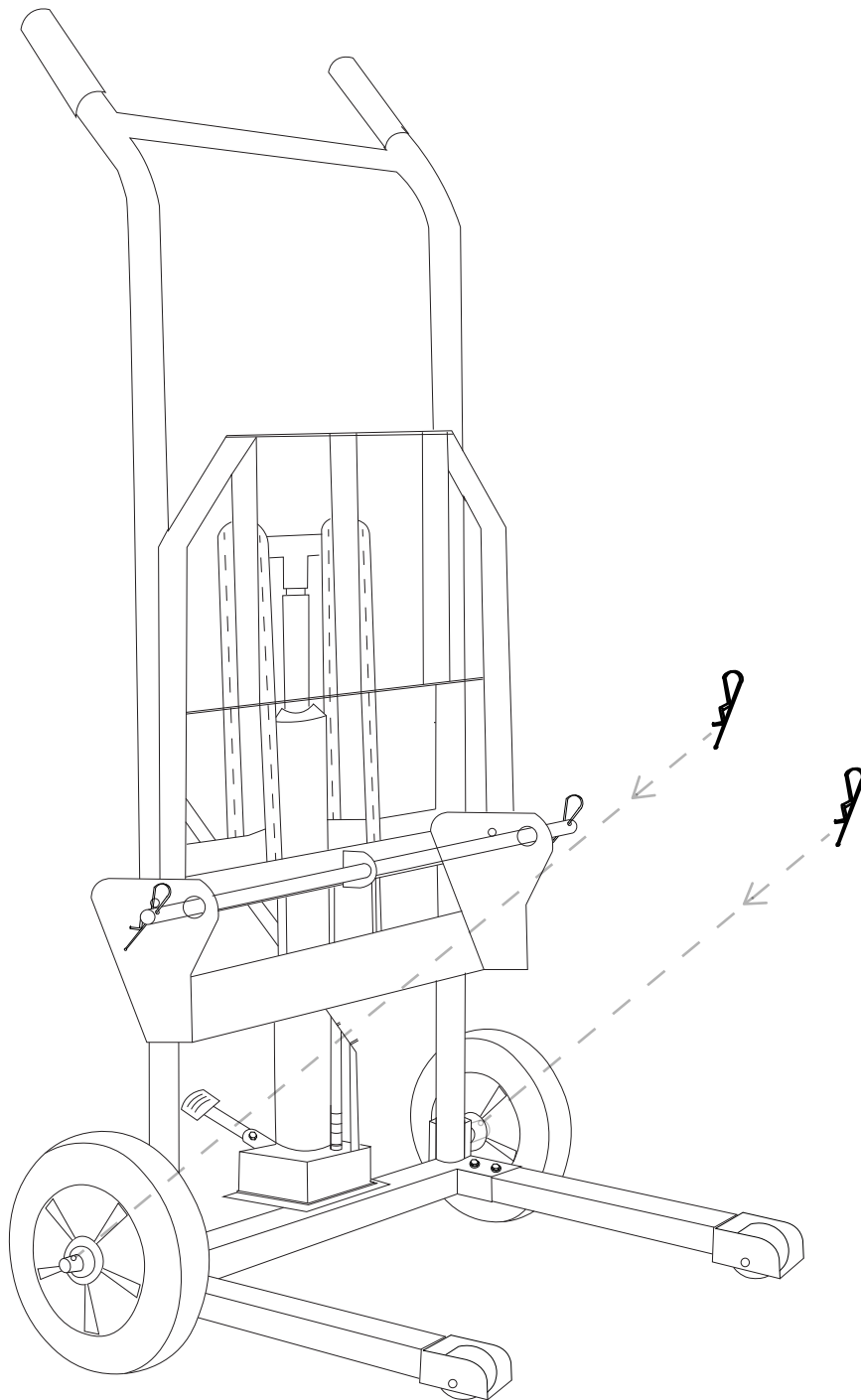

STEP 5

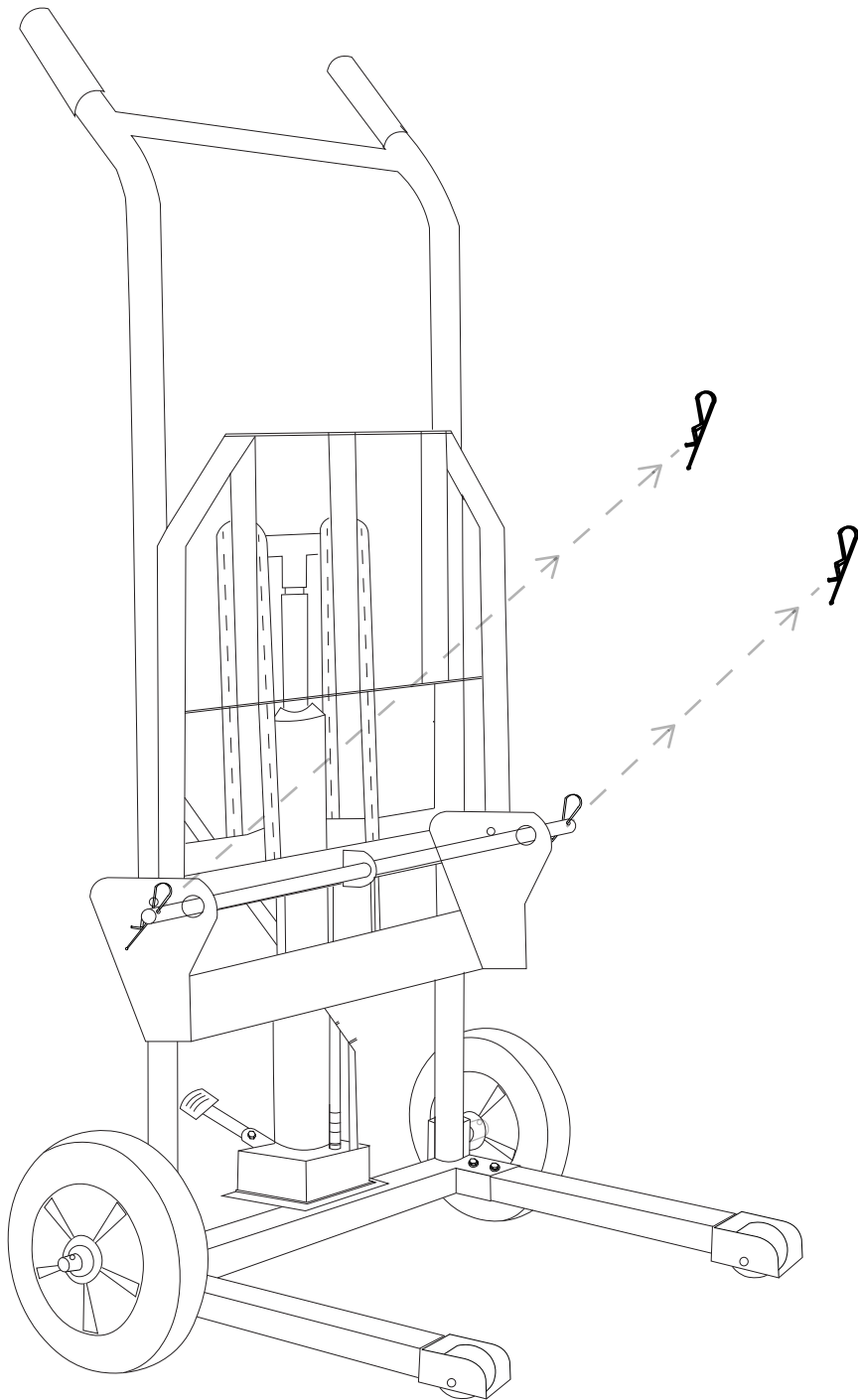

ASSEMBLY

STEP 6

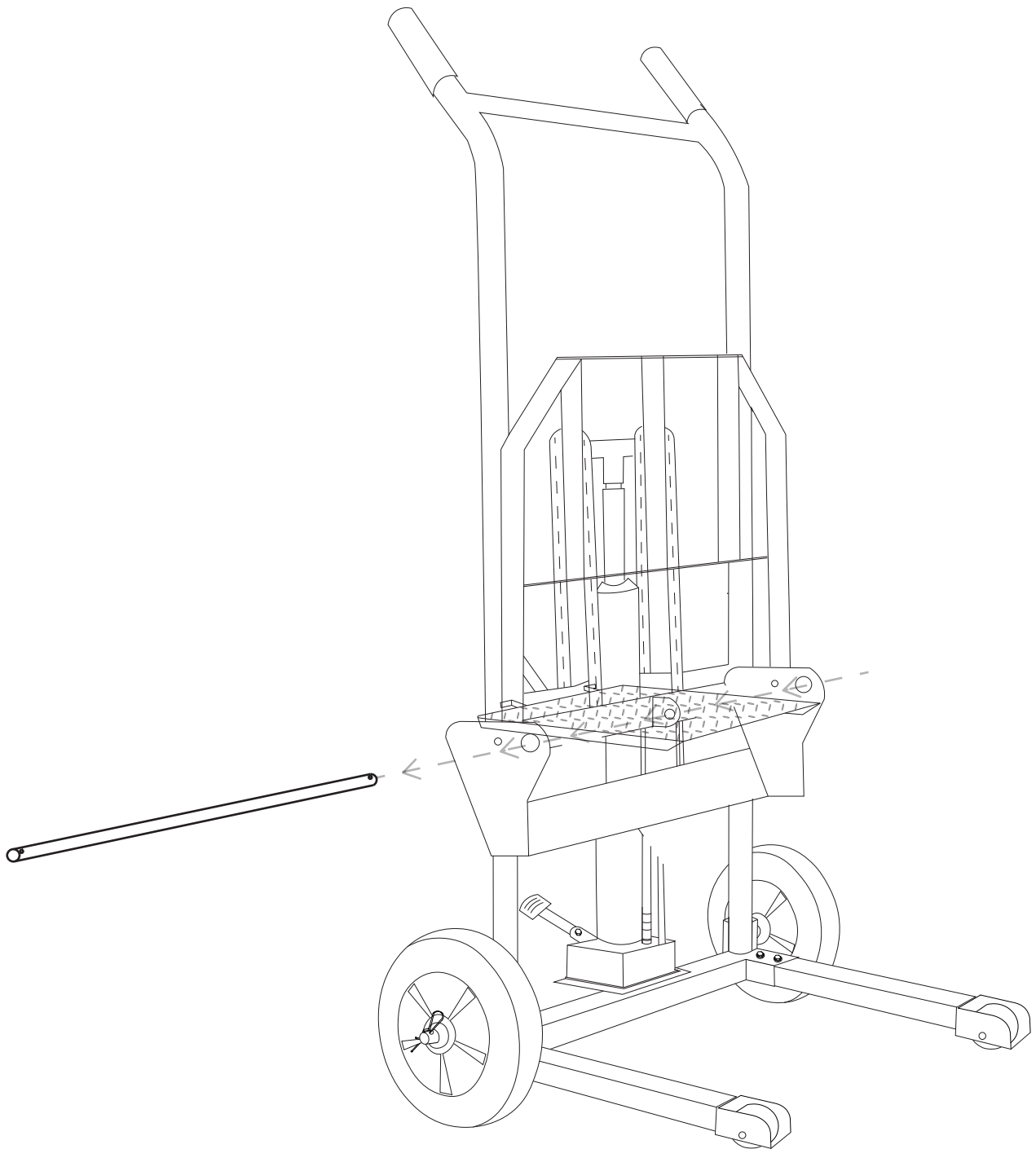

ASSEMBLY

STEP 7

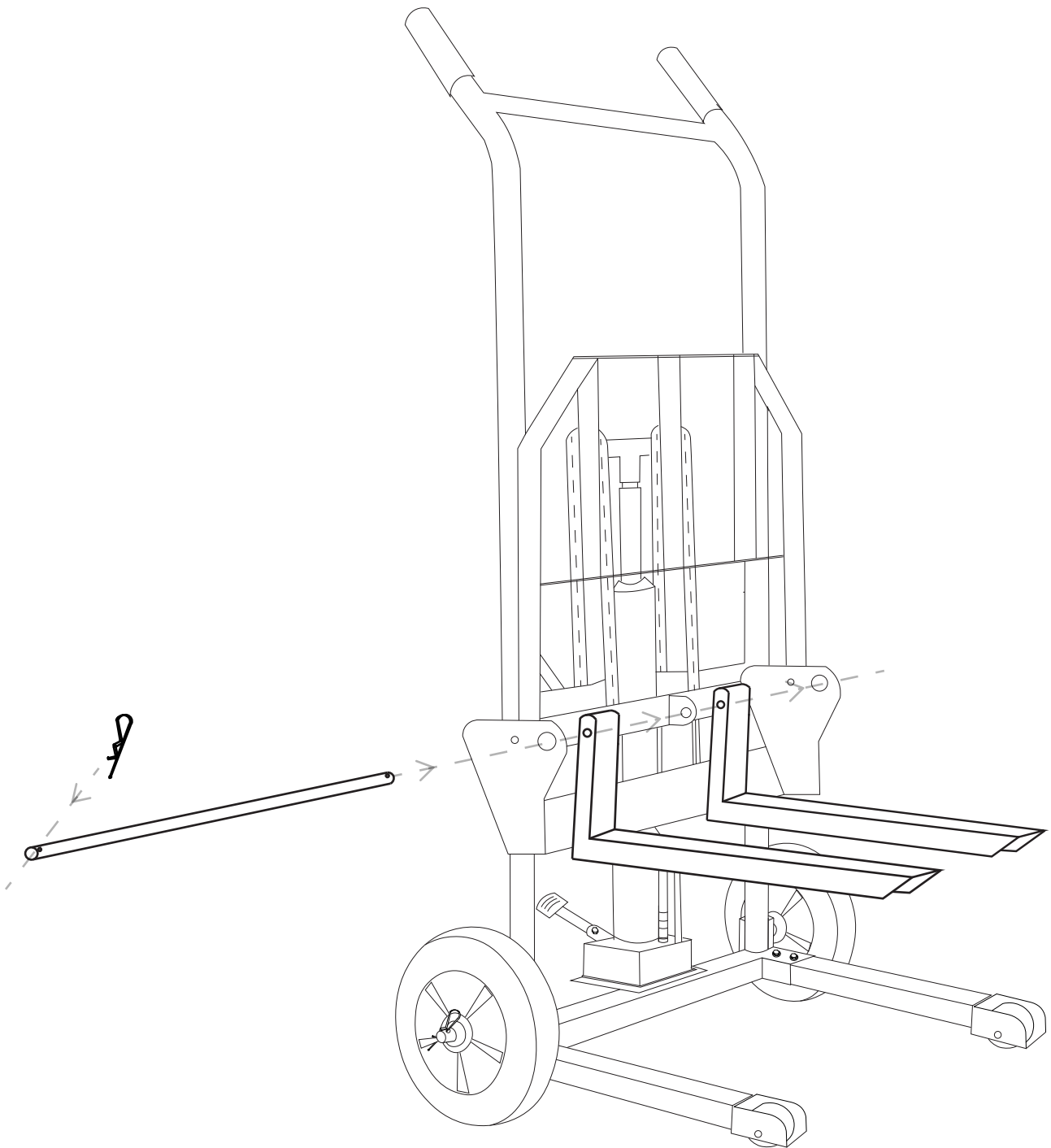

ASSEMBLY

STEP 8

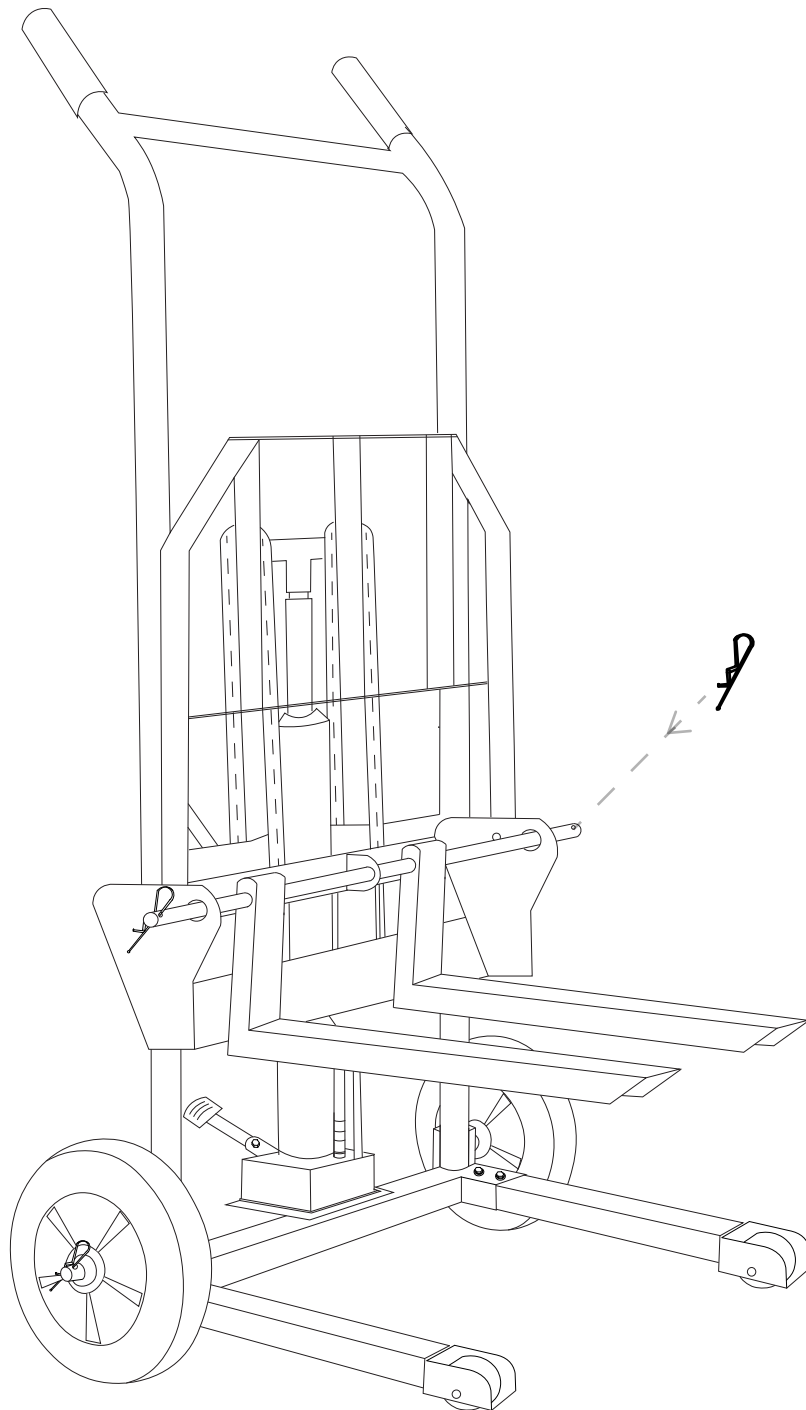

ASSEMBLY

STEP 9 COMPLETED WITHOUT FLAT STEEL PLATFORM

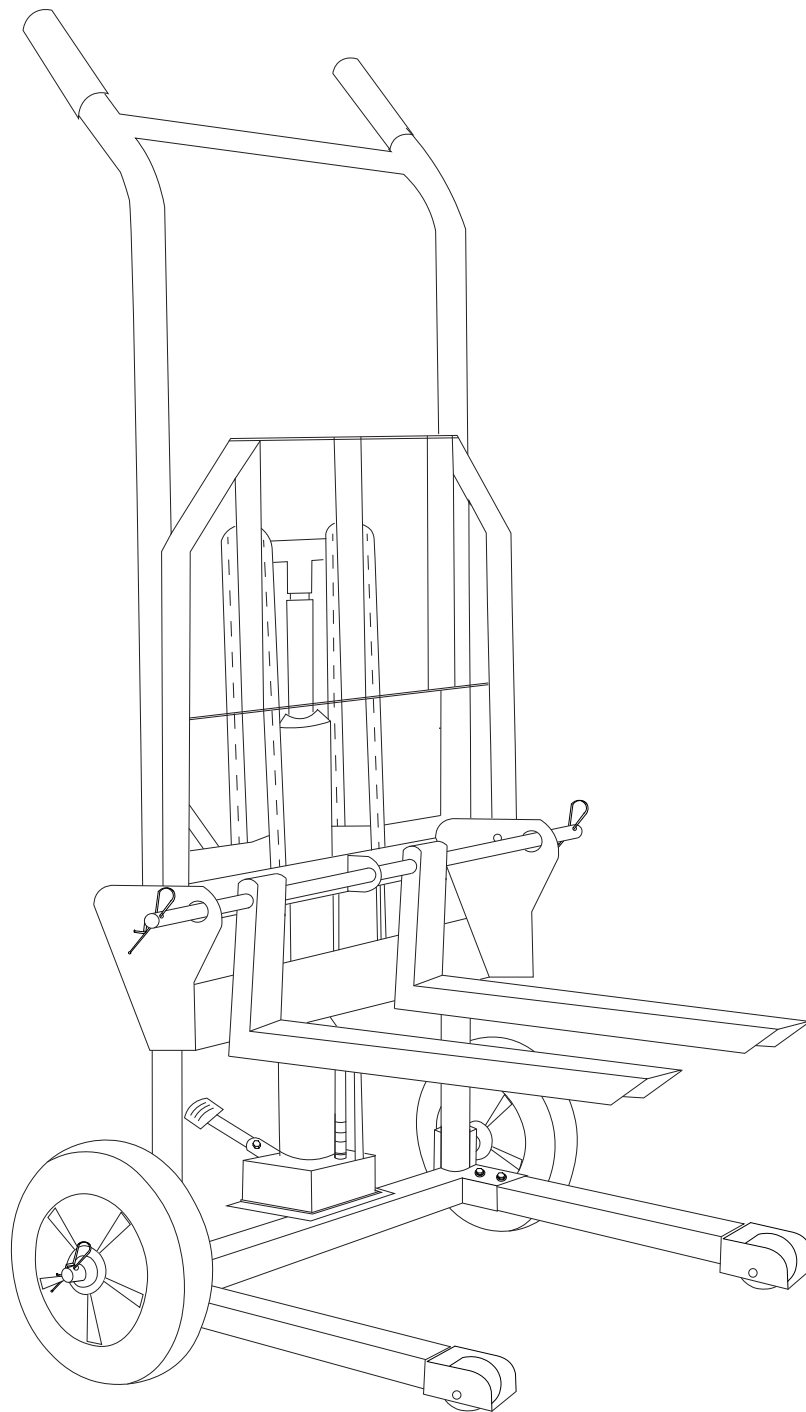

ASSEMBLY

STEP 10 OPTIONAL: WITH FLAT STEEL PLATFORM

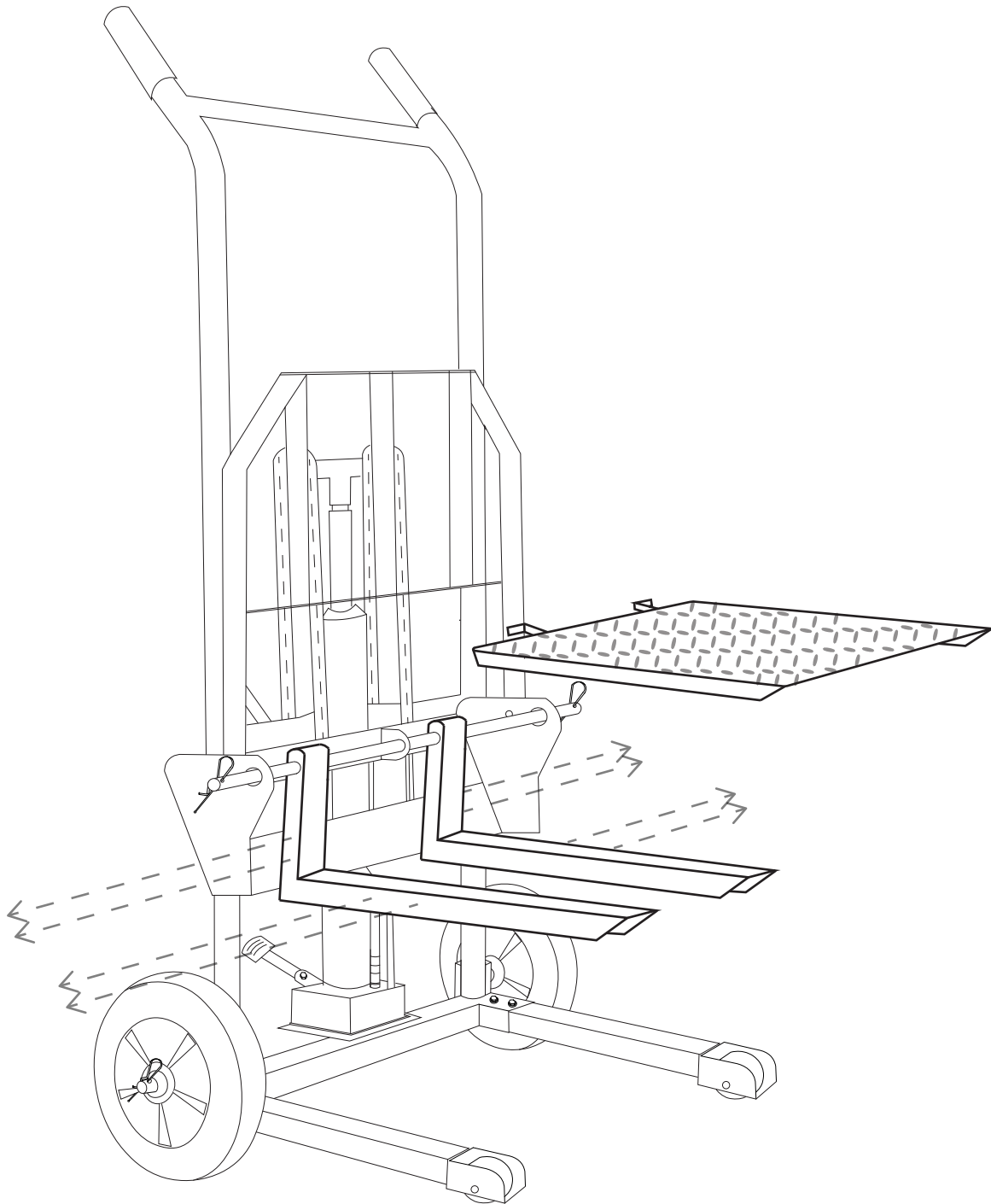

ASSEMBLY

STEP 11 OPTIONAL: WITH FLAT STEEL PLATFORM

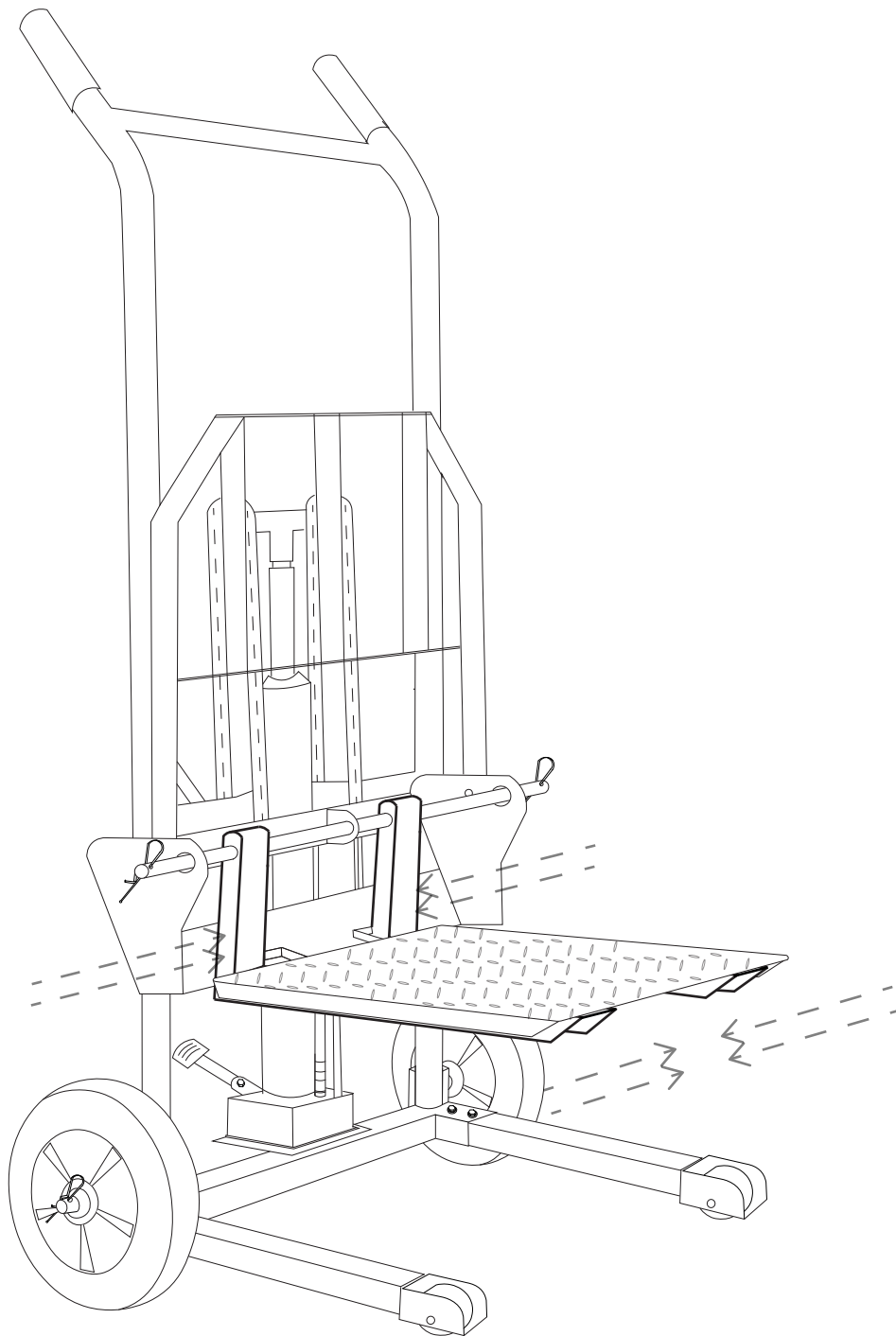

ASSEMBLY

STEP 12 COMPLETED WITH FLAT STEEL PLATFORM

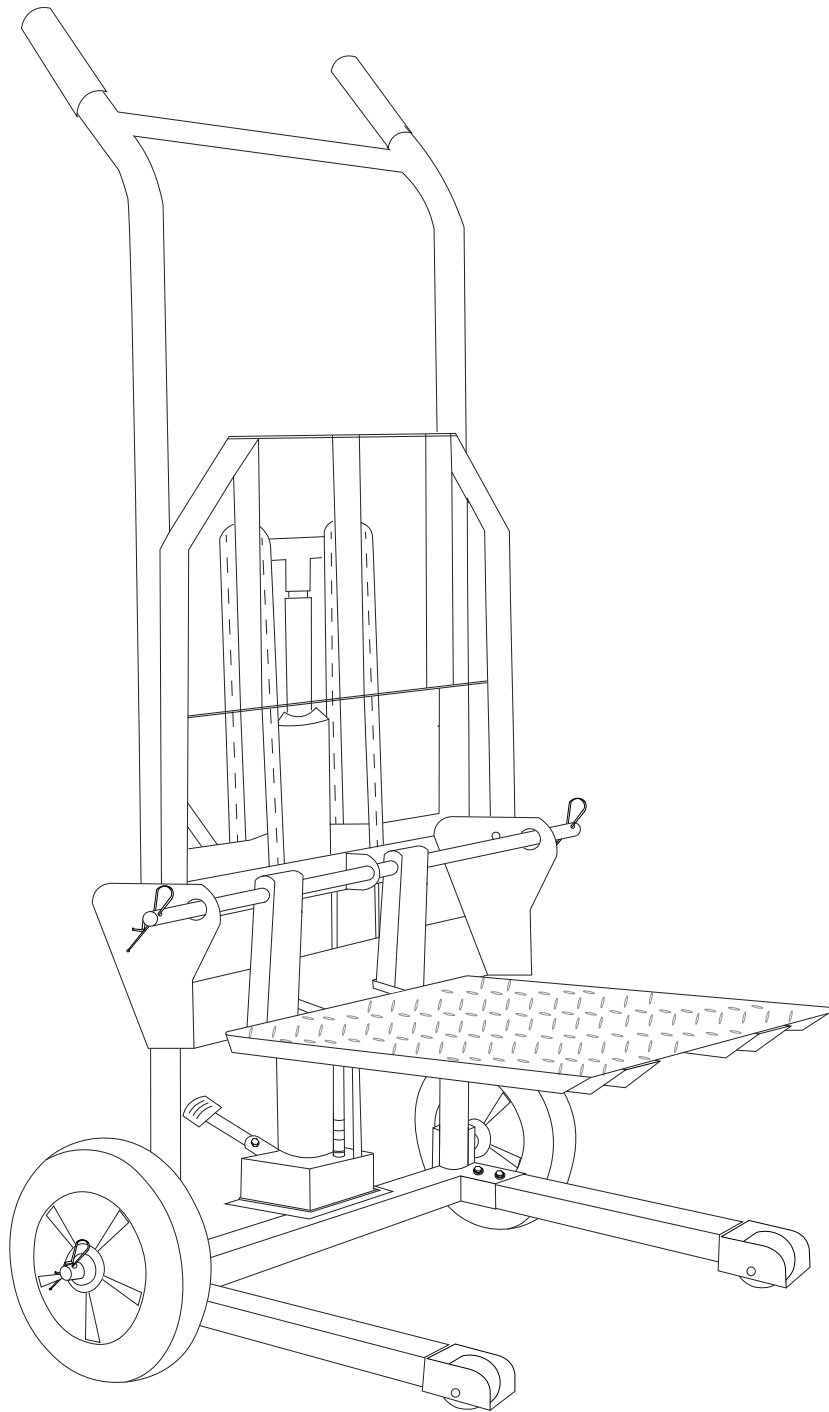

REPLACEMENT PARTS

REPLACEMENT PARTS

PARTS DIAGRAM

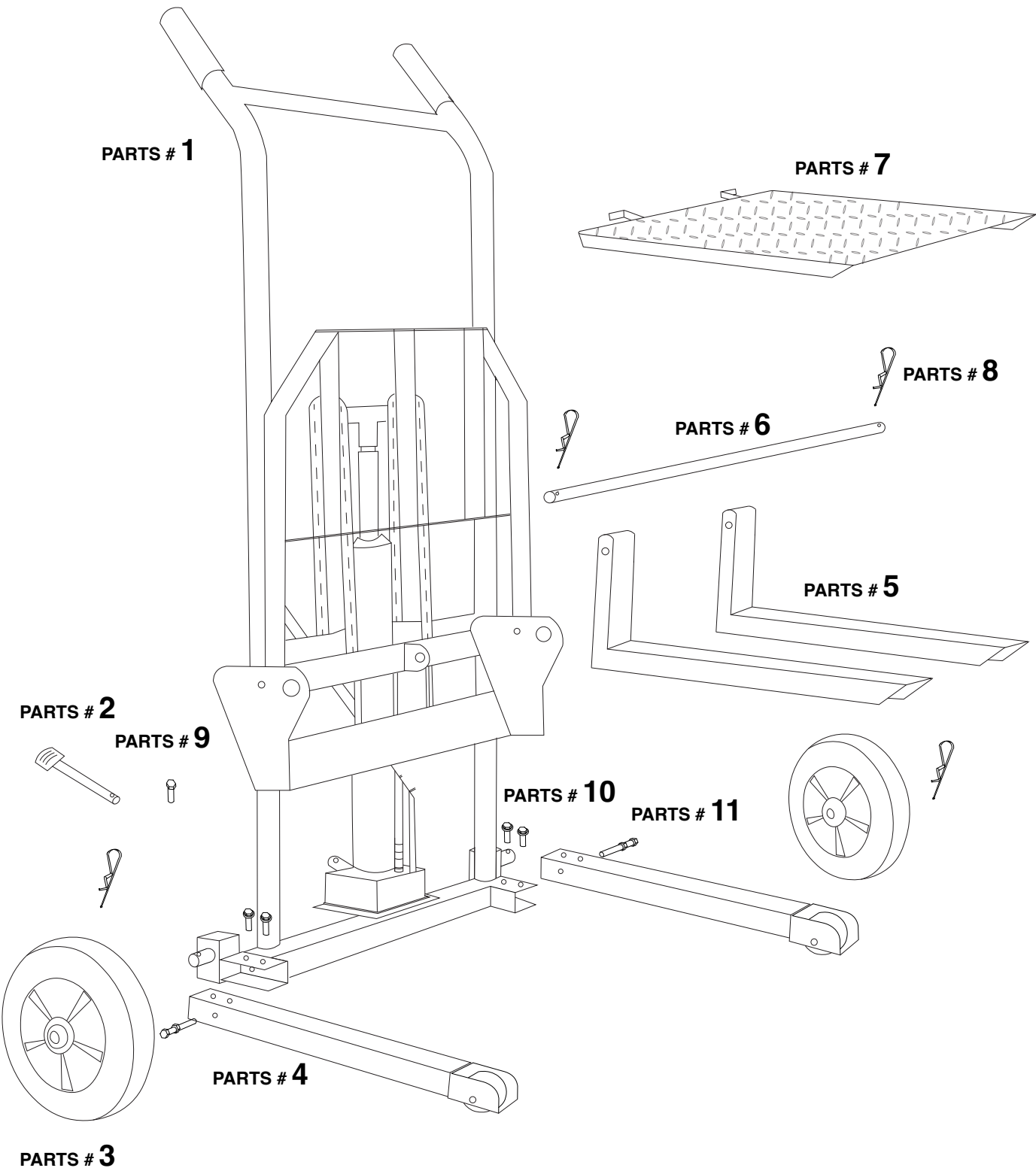

REPLACEMENT PARTS

PARTS LIST

PARTS#	DESCRIPTION	QTY
1	LIFT ASSEMBLY	1
2	FOOT PEDAL	1
3	9" REAR WHEEL	2
4	2" FRONT WHEEL ASSEMBLY	1
5	FORKS	2
6	FORK ASSEMBLY ROD	1
7	FLAT STEEL PLATFORM	1
8	LOCKING PIN	4
9	SCREW	1
10	SCREW WITH WASHER	4
11	SCREW WITH NUT	2

DISCLAIMER

PLEASE READ THE FOLLOWING CAREFULLY

The manufacturer and/or distributor have provided the parts list and assembly diagram in this manual for reference purposes only. They do not make any representation or warranty to the buyer that they are qualified to make repairs to the product or replace any parts of the product. In fact, the manufacturer and/or distributor expressly state that all repairs and parts replacements should be undertaken by certified and licensed technicians, and not by the buyer.

The buyer assumes all risk and liability arising from their repairs to the original product or replacement parts or arising from their installation of replacement parts. It is strongly advised that qualified professionals handle any repairs or replacements to ensure safety and proper functioning of the product. Improper installation and operation may result in injury, property damage, or voiding of warranty. The manufacturer and/or distributor shall not be held responsible for any accidents, damages, or malfunctions resulting from the buyer's installation and operation of the product. It is essential to follow all safety guidelines and recommendations provided in this manual and to seek professional assistance if unsure about the installation or operation procedures.

CUSTOMER SERVICE

If you have any questions about ordering our pool pumps and replacement parts or pool products, please feel free to contact us using the following contact information:

Customer Service and Technical Support

Phone: (909) 628-0880

Email: customer@xtremepowerusa.com

Hours of Operation: Monday – Friday, 9AM – 4PM (CST)
