

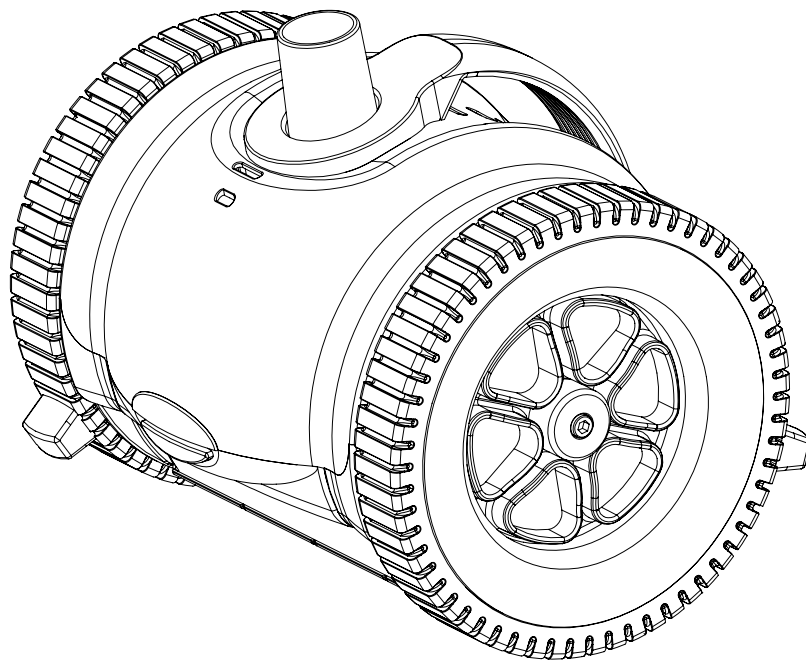

## 2-WHEEL SUCTION POOL CLEANER

ITEM: 75058



## INSTALLATION AND USER'S GUIDE

**⚠ DANGER**

Read all safety warnings and instructions. Failure to follow the warnings and instructions may result in serious injury. Save all warnings and instructions for future reference.

75058

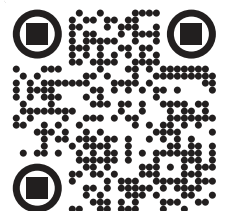

**THIS PAGE INTENTIONALLY LEFT BLANK**

# TABLE OF CONTENTS

<b>TABLE OF CONTENTS</b> .....	<b>1</b>
<b>IMPORTANT SAFETY INSTRUCTIONS</b> .....	<b>2</b>
<i>Legends and Symbols</i> .....	2
GENERAL SAFETY .....	3
<b>OVERVIEW (PRODUCT INFORMATION)</b> .....	<b>4</b>
PACKAGE CONTENTS .....	4
PRODUCT DIMENSIONS .....	5
<b>INSTALLATION</b> .....	<b>6</b>
STEP 1: PRIOR TO INSTALLATION .....	6
STEP 2: CONNECTING HOSES AND HOSE FLOAT .....	7-10
STEP 3: POOL SKIMMER / SUCTION CONNECTION .....	11
UTILIZING THE PROGRAMMABLE FEATURE .....	12
STEP 3: POOL SKIMMER / SUCTION CONNECTION (CONTINUED) .....	13-15
<b>MAINTENANCE</b> .....	<b>16</b>
ROUTINE MAINTENANCE .....	16
UNCLOGGING THE CLEANER .....	16
ADJUSTING TIRE BUMPER HEIGHT .....	16
REPLACING TIRES .....	17
<b>TROUBLESHOOTING</b> .....	<b>18</b>
<b>REPLACEMENT PARTS</b> .....	<b>19</b>
<b>DISCLAIMER</b> .....	<b>20</b>
<i>Disclaimer</i> .....	20
<i>Customer Service</i> .....	20

---

## CUSTOMER SERVICE

If you have any questions about ordering our pool pumps and replacement parts or pool products, please feel free to contact us using the following contact information:

### ***Customer Service and Technical Support***

**Phone:** (909) 628-0880

**Email:** [customer@xtremepowerusa.com](mailto:customer@xtremepowerusa.com)

**Hours of Operation:** Monday – Friday, 9AM – 4PM (CST)

---

# IMPORTANT SAFETY INSTRUCTIONS

## IMPORTANT SAFETY INSTRUCTIONS

This guide provides instructions for installing and using the product. If you have any questions about the product, please contact XtremepowerUS.

This guide contains important information about safely installing and operating this product. After installation, make sure to share this information with the owner/operator or leave it with them for their reference.

### *Legends and Symbols*

When you come across the safety-alert symbol on the product or in this manual, pay attention to the following signal words and remain vigilant about the potential for personal injury.

 **DANGER** **DANGER:** Ignoring these hazards can result in death, severe personal injury, or significant property damage.

 **WARNING** **WARNING:** Indicates potential hazards that can result in severe personal injury, death, or significant property damage. Ignoring these warnings presents a real danger.

 **CAUTION** **CAUTION:** Indicates potential hazards that can result in minor or moderate personal injury, property damage, or actions that are unpredictable and unsafe. Ignoring these cautions presents a potential hazard.

 **NOTE** **NOTICE:** This label indicates important special instructions that are not directly related to hazards.

---

## **USE OF NON-XTREMEPOWERUS REPLACEMENT PARTS VOIDS WARRANTY**

**ATTENTION INSTALLER:** This manual contains vital information regarding the installation, operation, and safe use of this product. It is essential to provide this manual to the end user of the product. Failure to read and follow all instructions could lead to severe injuries.

---

 **DANGER** Failure to comply with all instructions and warnings may lead to severe bodily injury or even death. It is strongly recommended that only a qualified pool service professional install and service this product. Prior to using this product, installers, operators, and owners must carefully review these warnings and all instructions provided in the owner's manual. It is essential to leave these warnings and the owner's manual with the pool owner for their reference and safety.

 **WARNING** For safety reasons, children should not be allowed to use this product.

# IMPORTANT SAFETY INSTRUCTIONS

## GENERAL SAFETY

### READ BEFORE USE

#### **WARNING**

- The pool cleaner is for adult use only; children should not operate it.
- Store the pool cleaner out of reach of children and away from pets.

#### **DANGER**

- Cover dedicated suction ports (vac port or automatic pool cleaner port) when not in use.
- Avoid direct contact with the cleaner or hose to prevent severe injuries.
- The suction force can trap individuals underwater, posing a drowning risk.
- Do not enter the pool while the cleaner is operational.

#### **CAUTION**

- Stop the pump before entering the pool to avoid injuries from moving parts.
- Detach the hose and move the cleaner to an unused area of the pool for swimmer safety.
- Remove the hose from the pool if it obstructs swimmers.

#### **NOTE**

- Prohibit play or use of the pool cleaner or its hose around individuals, especially children.
- Inform all pool users about the dangers associated with the hose, cleaner, and suction ports.

# OVERVIEW (PRODUCT INFORMATION)

## OVERVIEW (PRODUCT INFORMATION)

### PACKAGE CONTENTS

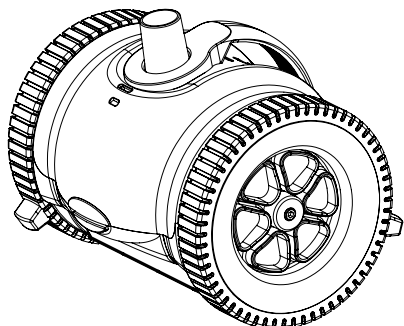

**PARTS # 1**  
**HEAD CLEANER**  
1 PC(S)

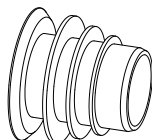

**PARTS # 6**  
**CONTROL VALVE ADAPTER**  
1 SET(S)

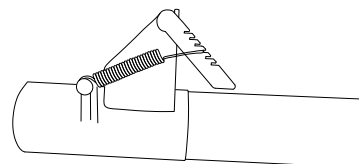

**PARTS # 7**  
**FLOW CONTROL VALVE**  
1 PC(S)

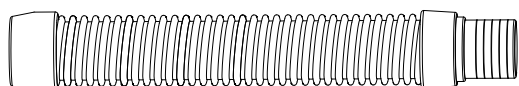

**PARTS # 3**  
**LEADER HOSE**  
1 PC(S)



**PARTS # 4**  
**FLOW GAUGE**  
1 PC(S)



**PARTS # 5**  
**HOSE FLOAT**  
2 PC(S)

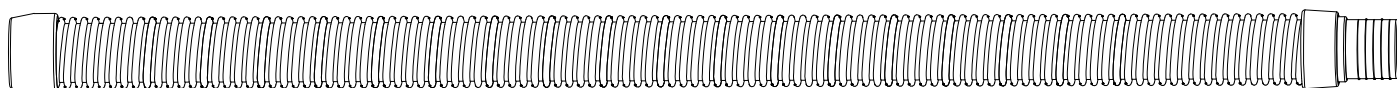

**PARTS # 2**  
**HOSE**  
14 PC(S)

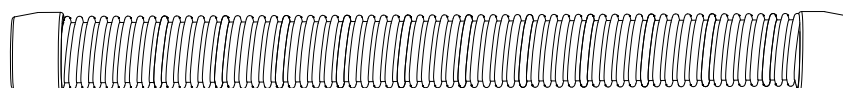

**PARTS # 8**  
**FEMALE HOSE**  
1 PC(S)

# OVERVIEW (PRODUCT INFORMATION)

## PRODUCT DIMENSIONS

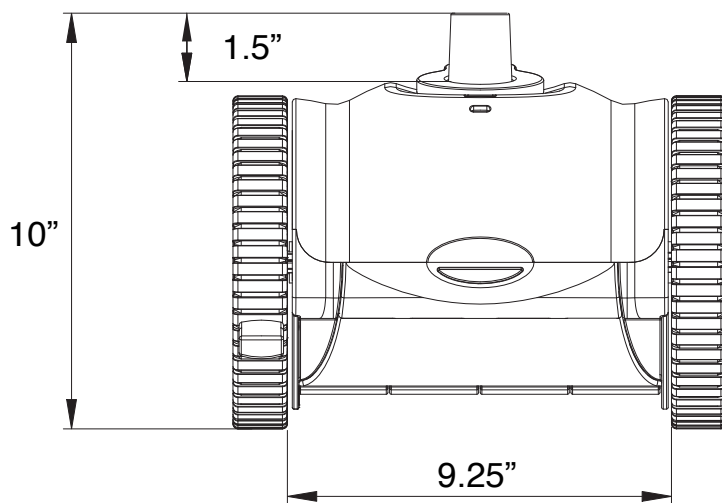
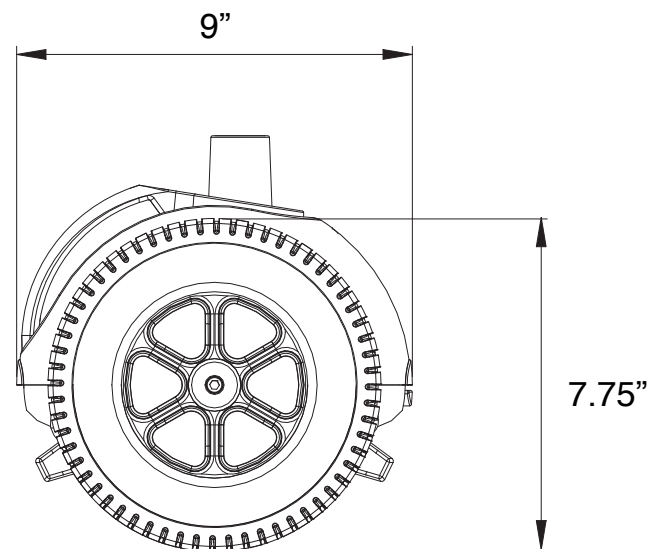
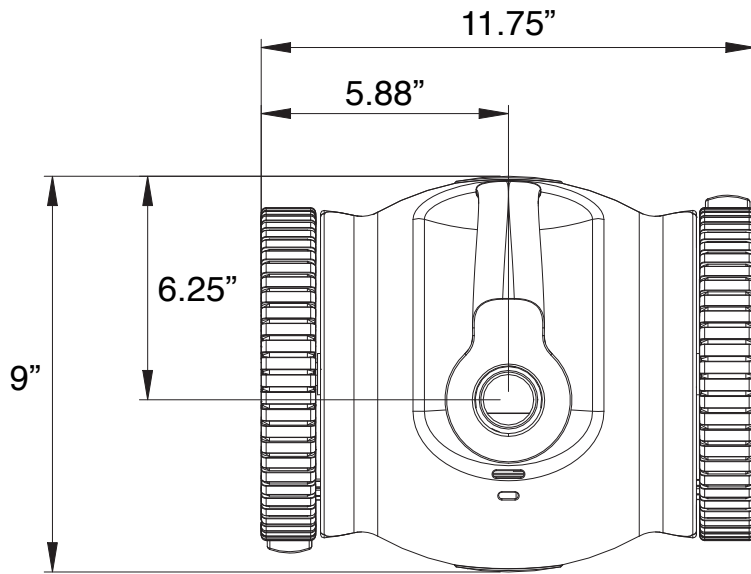

# INSTALLATION

## STEP 1: PRIOR TO INSTALLATION

### Before Installation

- Thoroughly review the operating manual to prevent injury, operational issues, or damage.
- This cleaner is not designed for the initial cleanup after pool construction or at the season's start.
- Inspect pools (vinyl, gunite, plaster, tile, fiberglass) for condition and ensure they are clear of algae/debris.
- For Vinyl Liner Pools, consultation with a Pool Professional is advised if the liner is damaged or has underlining obstructions before installation.
- The entire filter system (filter, baskets) must be cleaned to ensure proper cleaner operation.

### Preparing the Pool

- Manually vacuum to remove heavy debris and algae.
- Balance the pool water chemicals.
- Brush the pool, allowing debris to settle.
- Clean the pool filter, skimmer, and pump baskets.
- Close the main drain, if applicable.

### Usage Tips

- The pool must be in good condition (no broken tiles or tears) for the cleaner's use.
- The cleaner does not clean steps or ladders; these areas require manual cleaning.
- Store the hose straight to prevent coiling.
- Operation of the cleaner under a pool cover is not recommended.
- Removal of the cleaner before chemical treatments is necessary; a waiting period of 4 hours after shock treatments is recommended.
- Regular cleaning of the filter and inspection of the cleaner for wear are advised.



# INSTALLATION

## STEP 2: CONNECTING HOSES AND HOSE FLOAT

- Attach the female cuff of Parts# 3 to the cleaner's swivel. (Figure 1)
- Insert the male cuff of Parts# 3 into the female cuff of Parts# 8. (Figure 1)

Figure 1

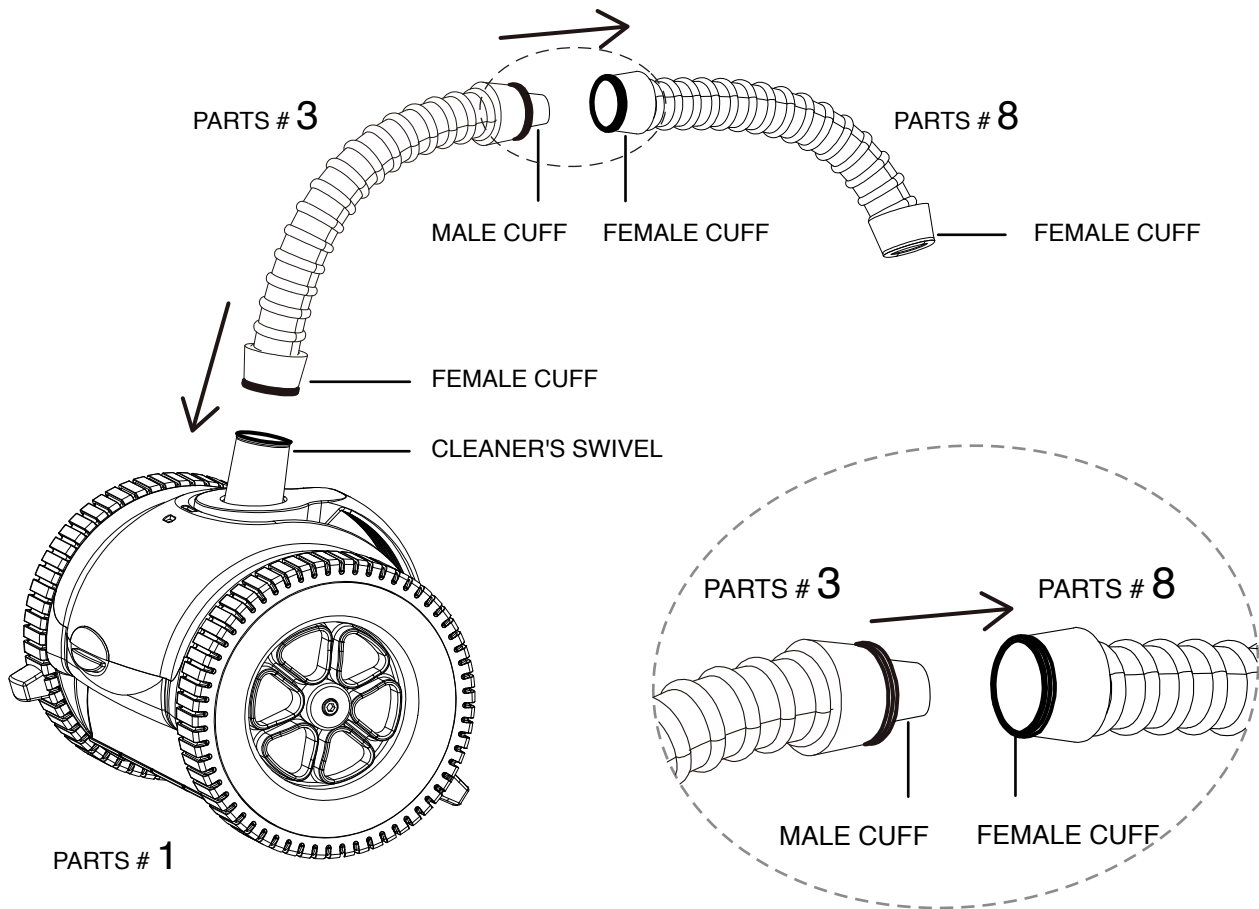

# INSTALLATION

## STEP 2: CONNECTING HOSES AND HOSE FLOAT (CONTINUED)

- Place two Parts# 5 on the leader hose at specified distances. (Figure 2)
  - 1ST Parts# 5: Directly at the cleaner's swivel area on Parts# 3.
  - 2ND Parts# 5: 28" from 1ST Parts # 5.

Figure 2

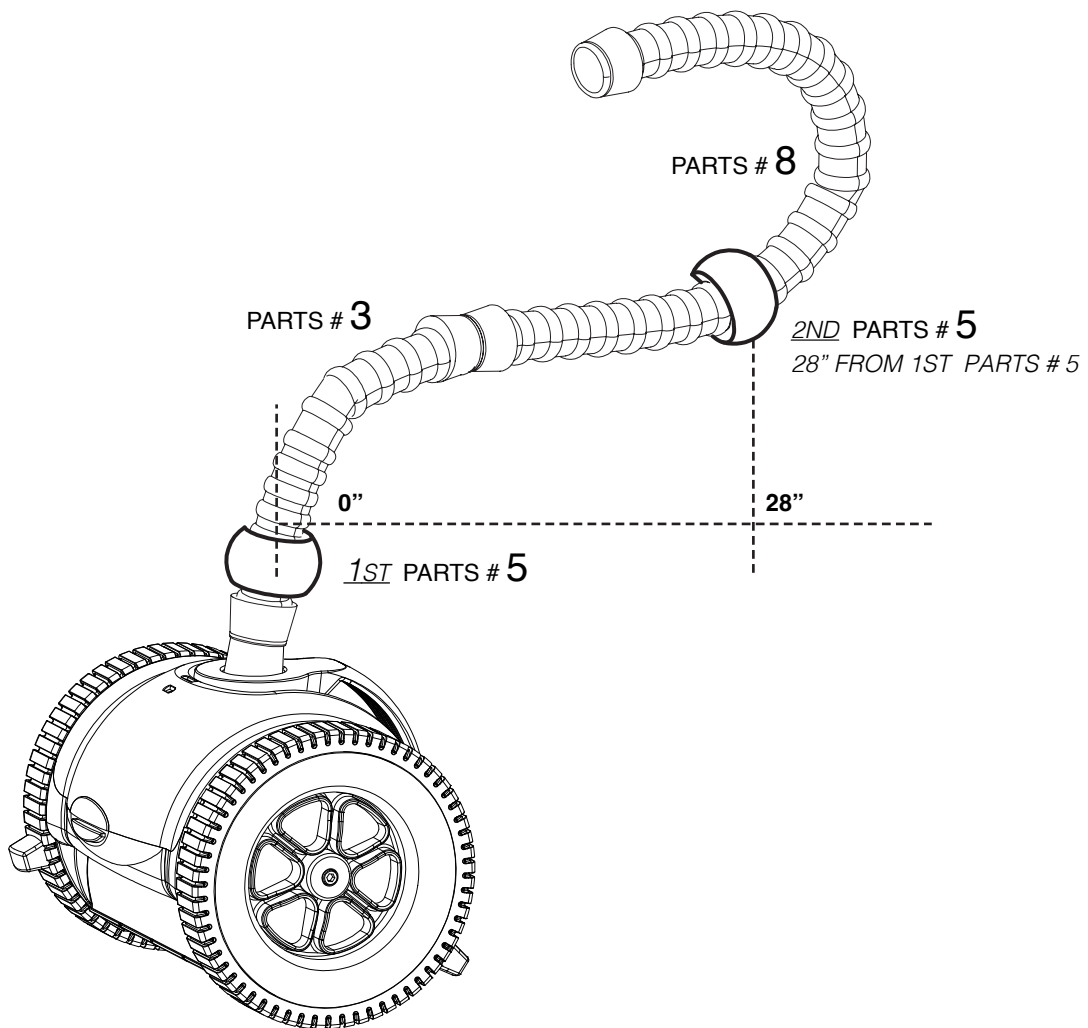

# INSTALLATION

## STEP 2: CONNECTING HOSES AND HOSE FLOAT (CONTINUED)

- Connect Parts# 2 as needed from the skimmer or suction port to the farthest pool point, plus one extra Parts# 2. (Figure 3)

Figure 3 SWIMMIG POOL SHAPE

### SHAPE A

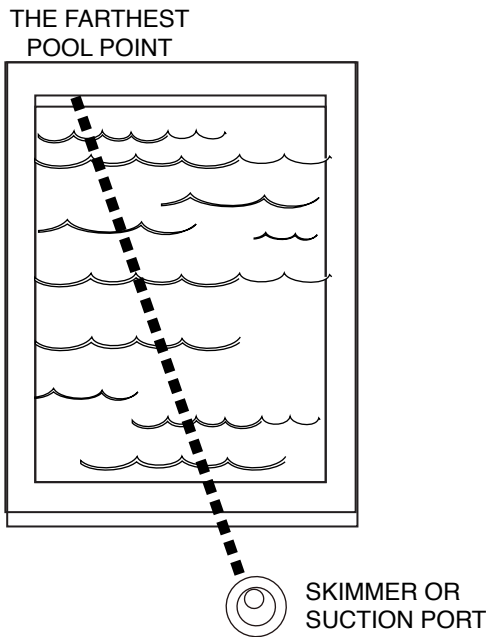

### SHAPE B

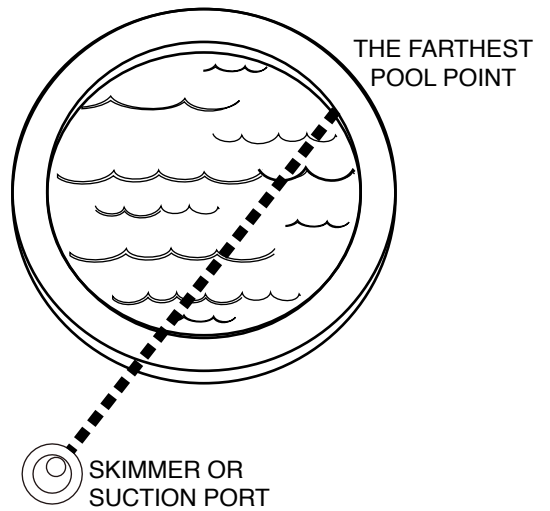

### SHAPE C

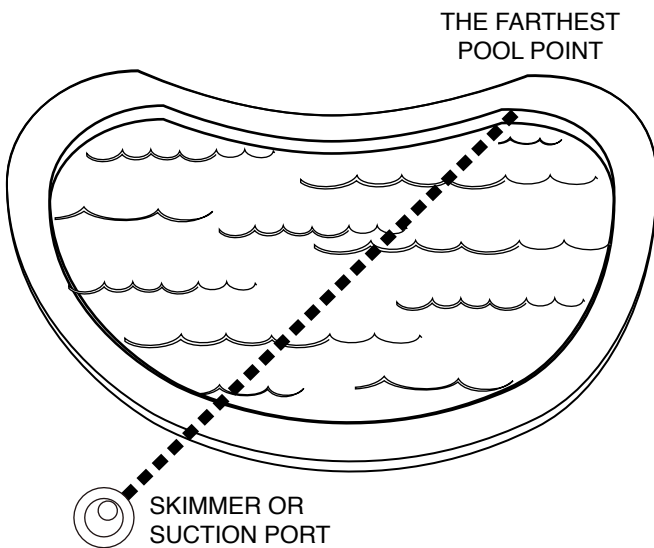

### SHAPE D

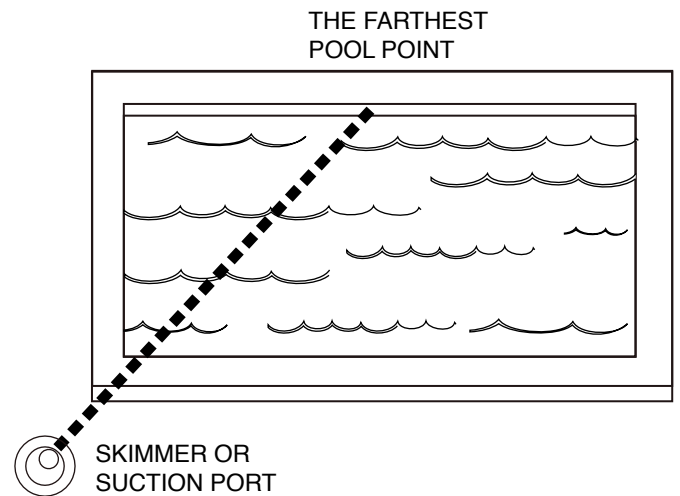

# INSTALLATION

## STEP 2: CONNECTING HOSES AND HOSE FLOAT (CONTINUED)

- Connect the female cuff of Parts# 8 to the first male cuff end of Parts# 2. (Figure 4)
- Connect the last female cuff end of Parts# 2 to the male cuff end of Parts# 7. (Figure 4)

**Figure 4**

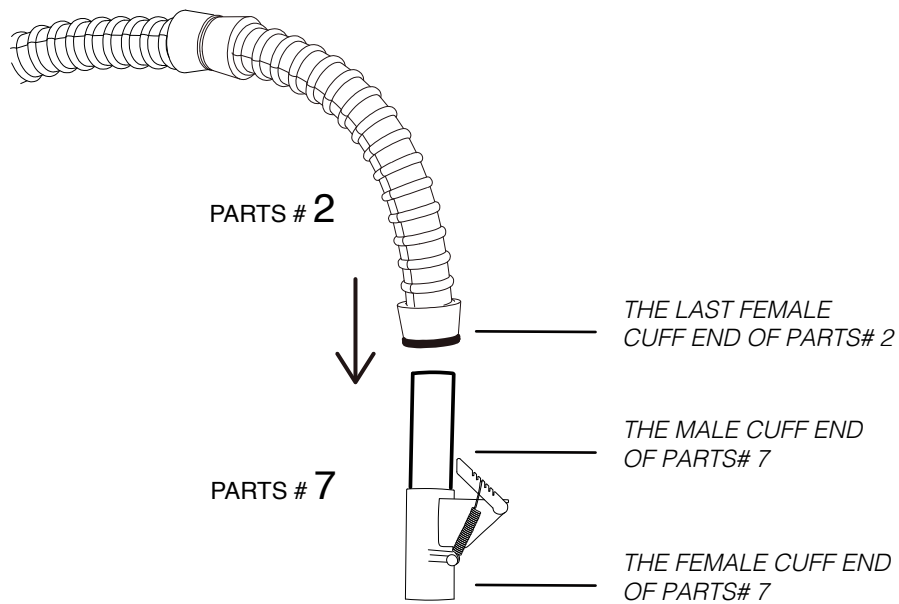
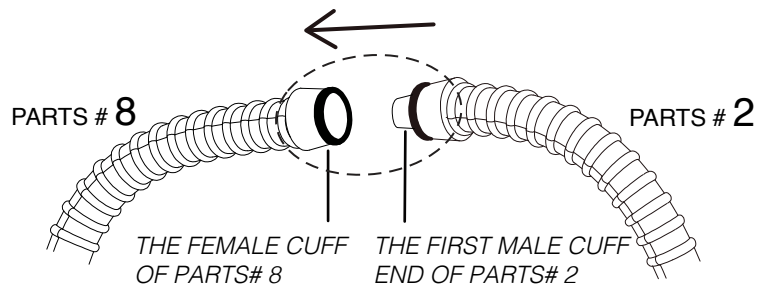

# INSTALLATION

## STEP 3: POOL SKIMMER / SUCTION CONNECTION For Pool Skimmer Connection

### Preparation

- Ensure the pool pump is turned off.
- Remove air from the cleaner and hose.
- Remove the skimmer lid and take out the skimmer basket (see Figure 5)

### Valve Regulation Adjustment

- Adjust the valve regulator on Parts# 7 for precise calibration (Figure 6)
- Always consult your specific pool cleaner's manual for precise instructions on how to adjust the regulator valve and what the ideal setting should be.

**Figure 5**

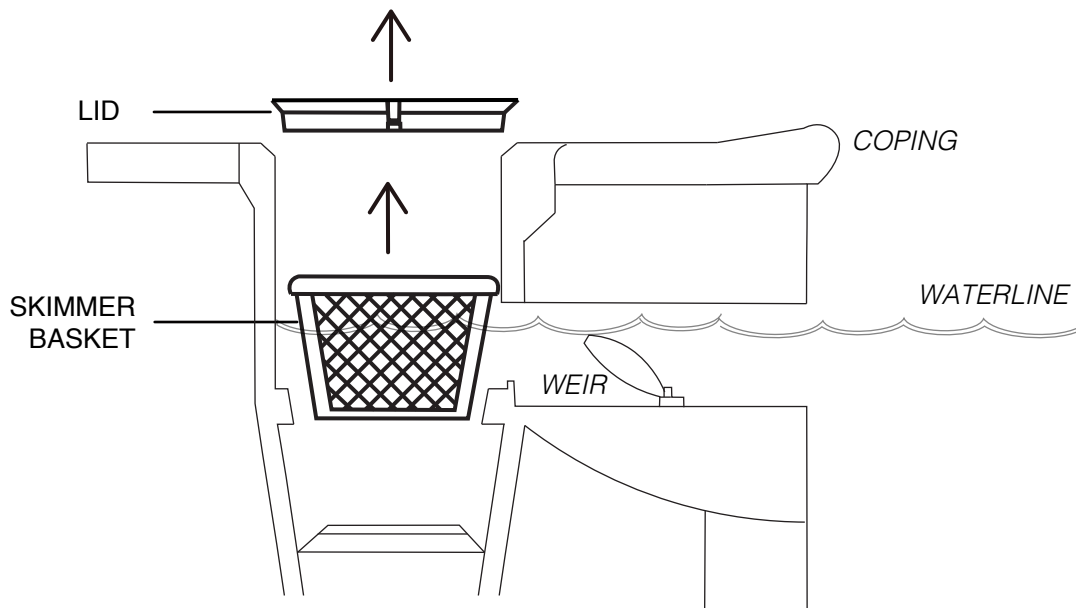

**Figure 6**

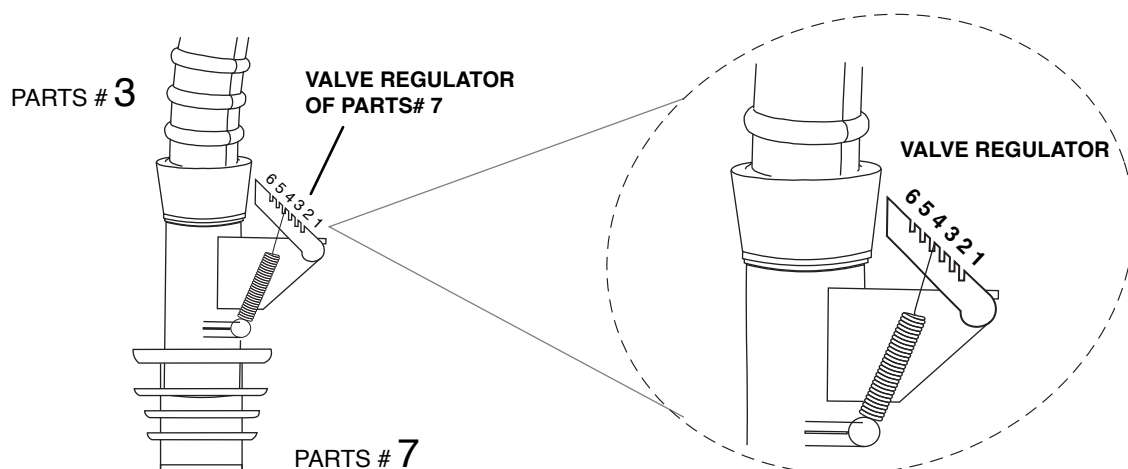

# INSTALLATION

## UTILIZING THE PROGRAMMABLE FEATURE

The Compass Programmable Pool Cleaner is designed with a preprogrammed setting for optimal performance in most pools. However, its programmability allows customization to accommodate pools with unique characteristics or larger sizes, ensuring improved coverage and efficiency.

### Surface Area Setting

#### Power Off

- Ensure the pool pump is turned off.

#### Adjust Valve Regulator

- Adjust the valve regulator on Parts# 7 to match the Ground indication.
- Use levels 1, 2, or 3 as indicated (see Figure 13).

### Wall Area Setting

#### Power Off

- Ensure the pool pump is turned off.

#### Set Valve Regulator

- Set the valve regulator on Parts# 7 to align with the Climb indication.
- Use levels 5 or 6 as appropriate (see Figure 14).

#### Adjusting Tire Bumper Height

- For detailed instructions on adjusting the tire bumper height, refer to Chapter: "Maintenance" -> Section: "Adjusting Tire Bumper Height".

Figure 13

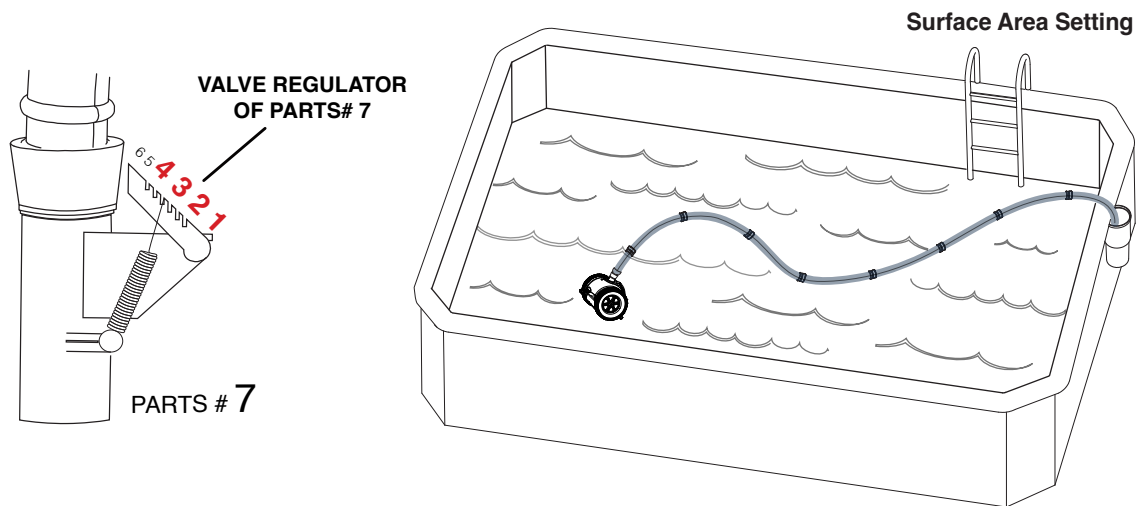
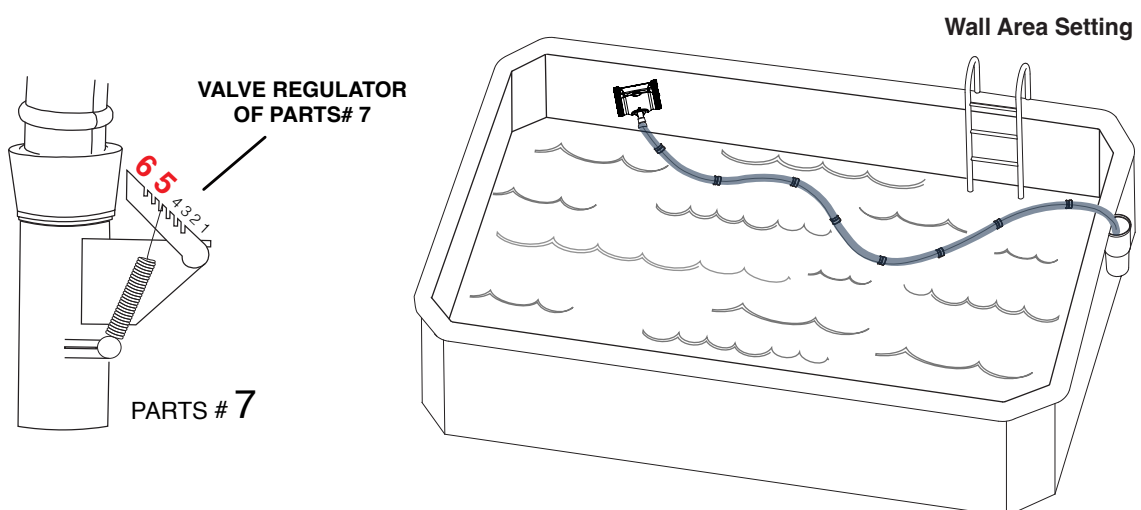

Figure 14



# INSTALLATION

## STEP 3: POOL SKIMMER / SUCTION CONNECTION (CONTINUED)

### Skimmer Suction Port Connection (Continued)

#### Set-up

- Connect the male cuff end of Parts# 7 to the female cuff end of Parts# 6 (Figure 7).
- Use the return jet to fill the vacuum hose with water.
- Insert the male cuff end of Parts# 6 from the swimming pool side into the suction port, ensuring a snug fit. (Figure 8)

#### Vacuum Activation

- Activate the pool pump to initiate automatic vacuuming.

**NOTE** Adjust the flow control valve as needed for optimal performance.

Figure 7

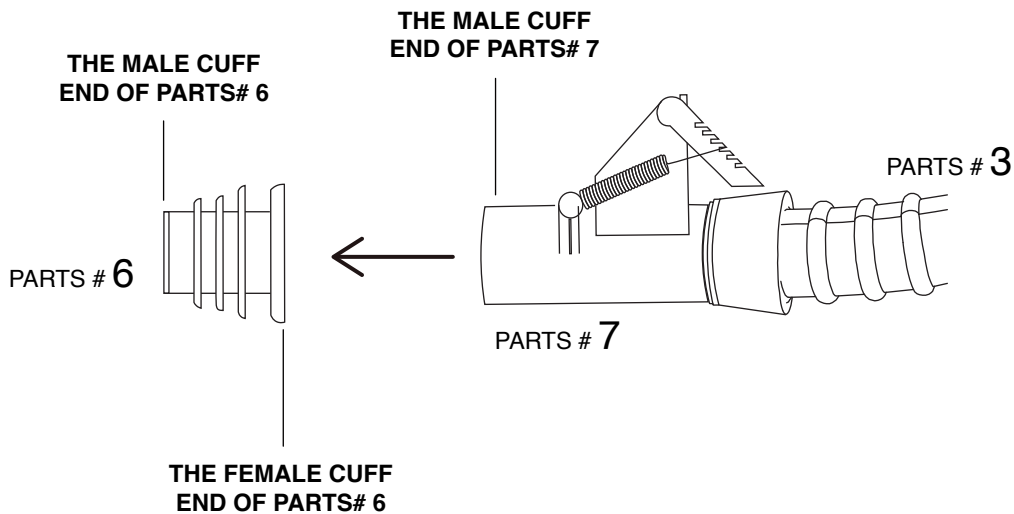
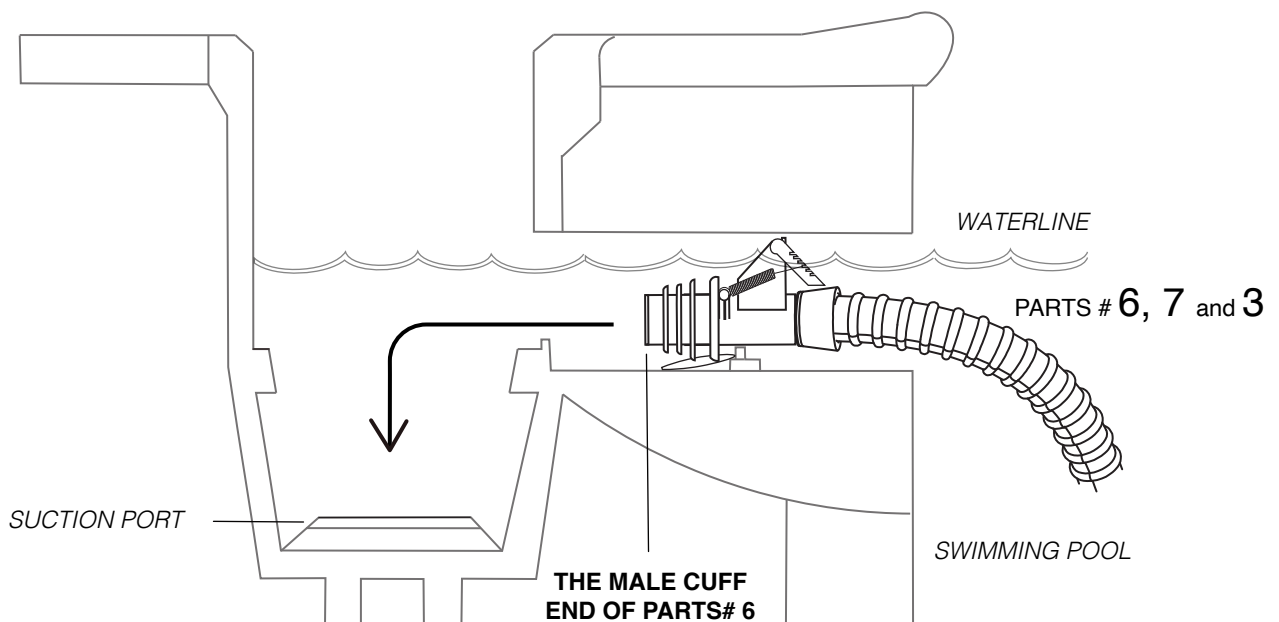

Figure 8



# INSTALLATION

## STEP 3: POOL SKIMMER / SUCTION CONNECTION (CONTINUED) For Dedicated Vacuum Line Connection

### Preparation

- Ensure the pool pump is turned off. Remove air from the cleaner and hose.
- Locate the skimmer wall suction port. (Figure 9)

### Valve Regulation Adjustment

- Adjust the valve regulator on Parts# 7 for precise calibration. (Figure 10)
- Always consult your specific pool cleaner's manual for precise instructions on how to adjust the regulator valve and what the ideal setting should be. (Figure 10).

Figure 9

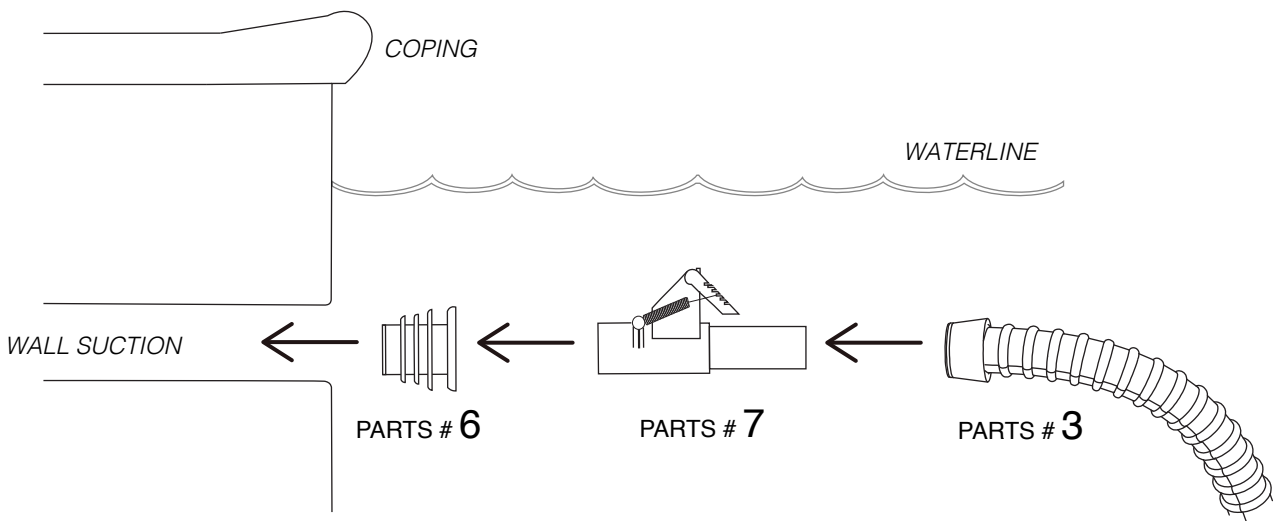
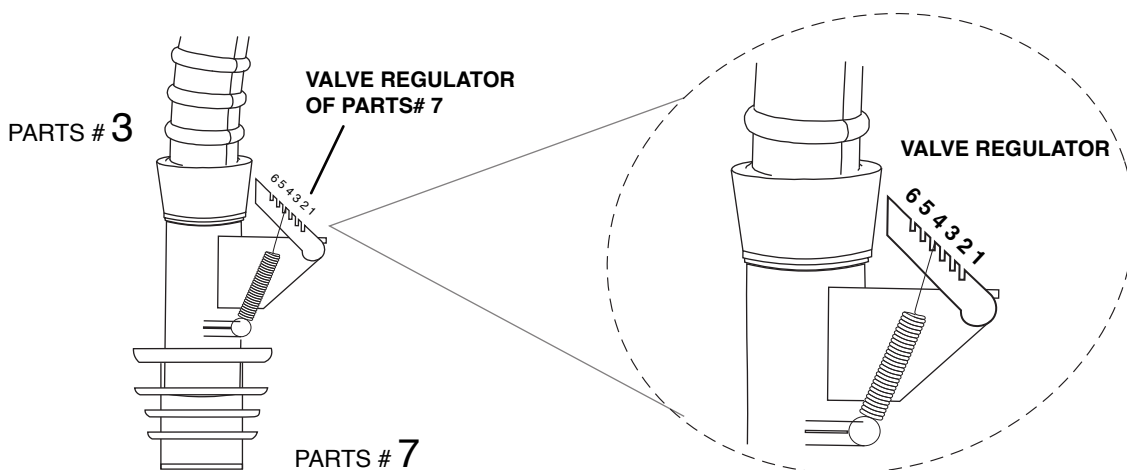

Figure 10





# INSTALLATION

## STEP 3: POOL SKIMMER / SUCTION CONNECTION (CONTINUED) For Dedicated Vacuum Line Connection (Continued)

### Suction port connection

- Turn off the pool pump and detach Parts# 4 from Parts# 6, replacing it with Parts# 7 (Figure 11).
- Use the return jet to fill the vacuum hose with water.
- Insert the male cuff end of Parts# 6 into the pool's suction port (Figure 12).

### Vacuum Activation

- Activate the pool pump to begin automatic vacuuming.

**★ NOTE** Adjust the flow control valve as needed for optimal performance.

Figure 11

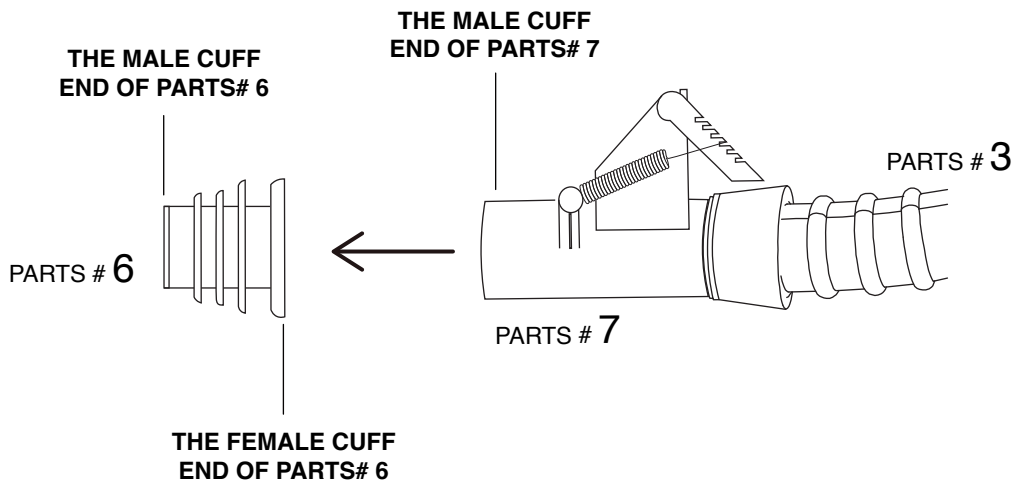
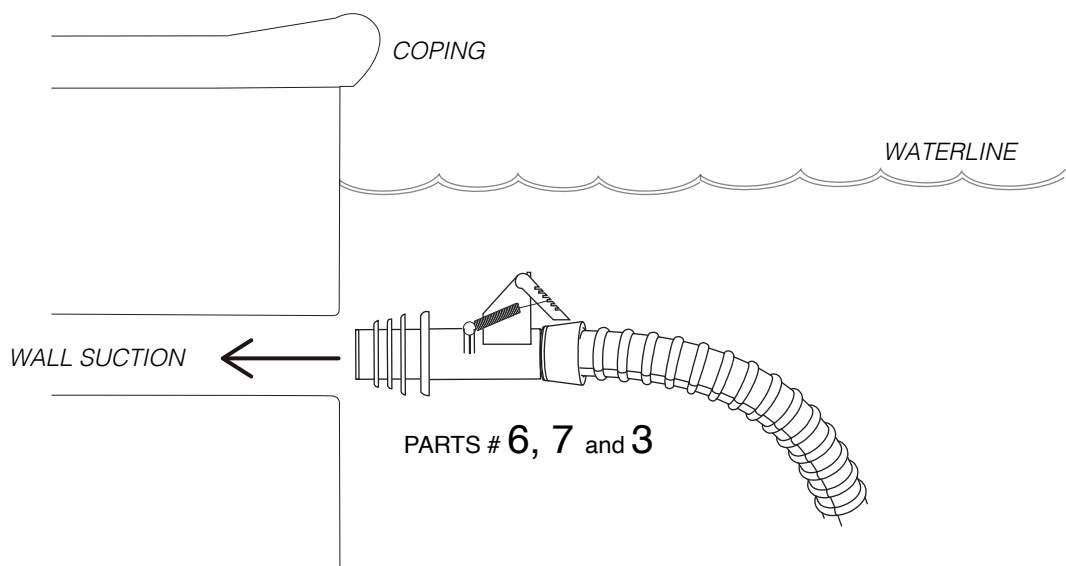

Figure 12



## MAINTENANCE

### ROUTINE MAINTENANCE

#### Hose Storage

- Proper Storage: After removing the hose, keep it straight to prevent coiling, as coiling may hinder its performance.

#### Pre-Chemical Treatment Removal

- Before Adding Chemicals: Remove the cleaner and hose from the pool prior to adding chemicals.
- Reinstallation: Wait at least 4 hours after super chlorination before reinstalling the cleaner and hose to ensure safety and proper operation.

#### Regular Cleaning

- Maintain the system by cleaning the filter, skimmer basket, and pump basket regularly to ensure optimal performance.

#### Wear and Tear Inspection

- Periodically inspect the cleaner for signs of wear or damage.
- Replace any worn components promptly to maintain functionality and efficiency.

## UNCLOGGING THE CLEANER

#### Power Down & Detach

- Ensure the pool pump is turned off before beginning. Remove the Pool Cleaner from the water and disconnect it from the hose.

#### Perform a Manual Wheel Test

- Attempt to manually rotate the wheels of the cleaner. If the wheels do not move, it indicates a potential clog inside the cleaner.

#### To Inspect and Remove Clogs *(Figure 13)*

- Disassemble the Cover: Place the cleaner on a stable surface. Gently press the front and back buttons to release the cover.
- Remove the Cover: Carefully lift and set aside the cleaner's cover.
- Detach the Shroud: Insert a screwdriver under the clip securing the Shroud. Twist the screwdriver gently to detach and remove the Shroud.
- Remove Debris: Inspect the gears and turbine for any debris or obstructions.
- Clear all debris thoroughly.
- Reassembly: Reconstruct the cleaner by reversing the disassembly steps. Ensure all parts are securely reattached.

## ADJUSTING TIRE BUMPER HEIGHT

- Set Flow: Set parts# 7's valve regulator to align with the **Climb** indication on parts# 4. Refer to chapter "INSTALLATION" -> section "UTILIZING THE PROGRAMMABLE FEATURE" -> "Wall Area Setting".
- Remove Bumper: Detach the bumper from the tire to increase friction and prevent slipping on walls.

## REPLACING TIRES

### To Replace Tires: (Figure 15)

- Power Off & Remove: Ensure the pool pump is off and lift the cleaner from the pool.
- Detach Hose: Disconnect the cleaner from the hose.
- Remove Bump: refer to chapter "MAINTENANCE" -> section "ADJUSTING TIRE BUMPER HEIGHT".
- Remove Old Tires: On a flat work surface, gently pull the tires away from the hub frame of the cleaner's wheel until they are completely removed.
- Install New Tires: Fit the new tires onto the wheel hub frame.
- Reassemble Cleaner: Follow the removal steps in reverse order to put the cleaner back together.

Figure 13

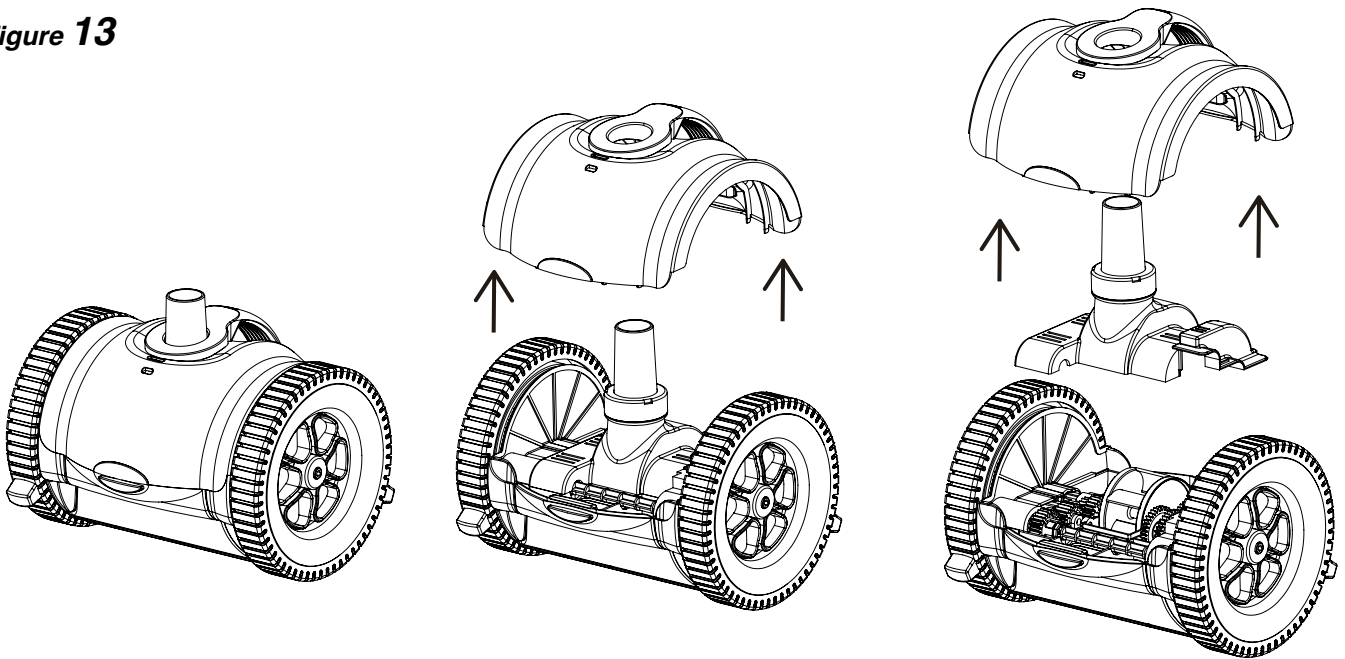

Figure 14

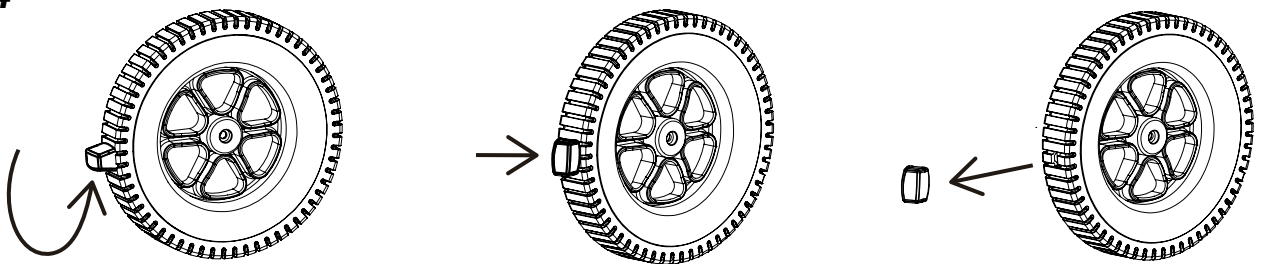
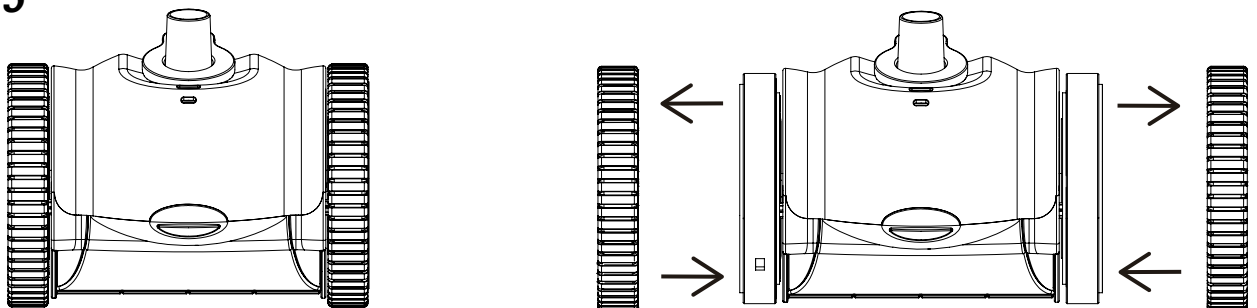

Figure 15



## TROUBLESHOOTING

### **Cleaner Movement Issues (No Movement or Slow):**

- Ensure the main drain is closed.
- Clean the pool filter and empty the pump strainer basket.
- Check for sufficient flow through the Flow Control Valve. For dedicated vacuum lines, adjust valves at the pool pad for optimal flow.
- Use a flow gauge to measure and adjust the hose flow as needed.
- Inspect inside the cleaner for debris and check for leaks in the pool system, indicated by bubbles.

### **Cleaner Won't Climb Walls:**

- Increase the flow to the cleaner.
- Confirm hose float is correctly positioned as indicated in the manual.
- Check for excessive tire wear which can impair wall climbing capabilities.
- Ensure the meter dial is set for wall climbing and verify correct Leader Hose installation.

### **Cleaner Coverage Issues (Not Cleaning Entire Pool or Staying in One Area):**

- Measure hose flow with a flow gauge to meet requirements.
- Ensure hose length is correct.
- Correctly position the hose float and adjust return line flow to manage cleaner movement.
- Check the hose for leaks.
- Ensure the Flow Control Valve connection is secure and the pump basket lid is fitted correctly, checking for any damage or missing O-rings.

### **Cleaner Stays on Main Drain:**

- Ensure the main drain is closed and consult a pool professional if needed.
- Consider fitting Tire Bumpers to the cleaner.
- Cleaner Climbs Above Waterline:
  - Position the hose float correctly.
  - Measure and adjust the hose flow if it's too high.
- Hose and Flow Control Valve Connection Issues:
  - Fit a Hose Adapter to the Flow Control Valve for proper connection.
- Cleaner Gets Stuck on Steps or Other Obstacles:
  - Reduce suction, check the hose length and consider adding additional hose sections. Monitor wheel RPM and replace worn Tire Bumpers as necessary.

# REPLACEMENT PARTS

## REPLACEMENT PARTS

### PARTS DIAGRAM

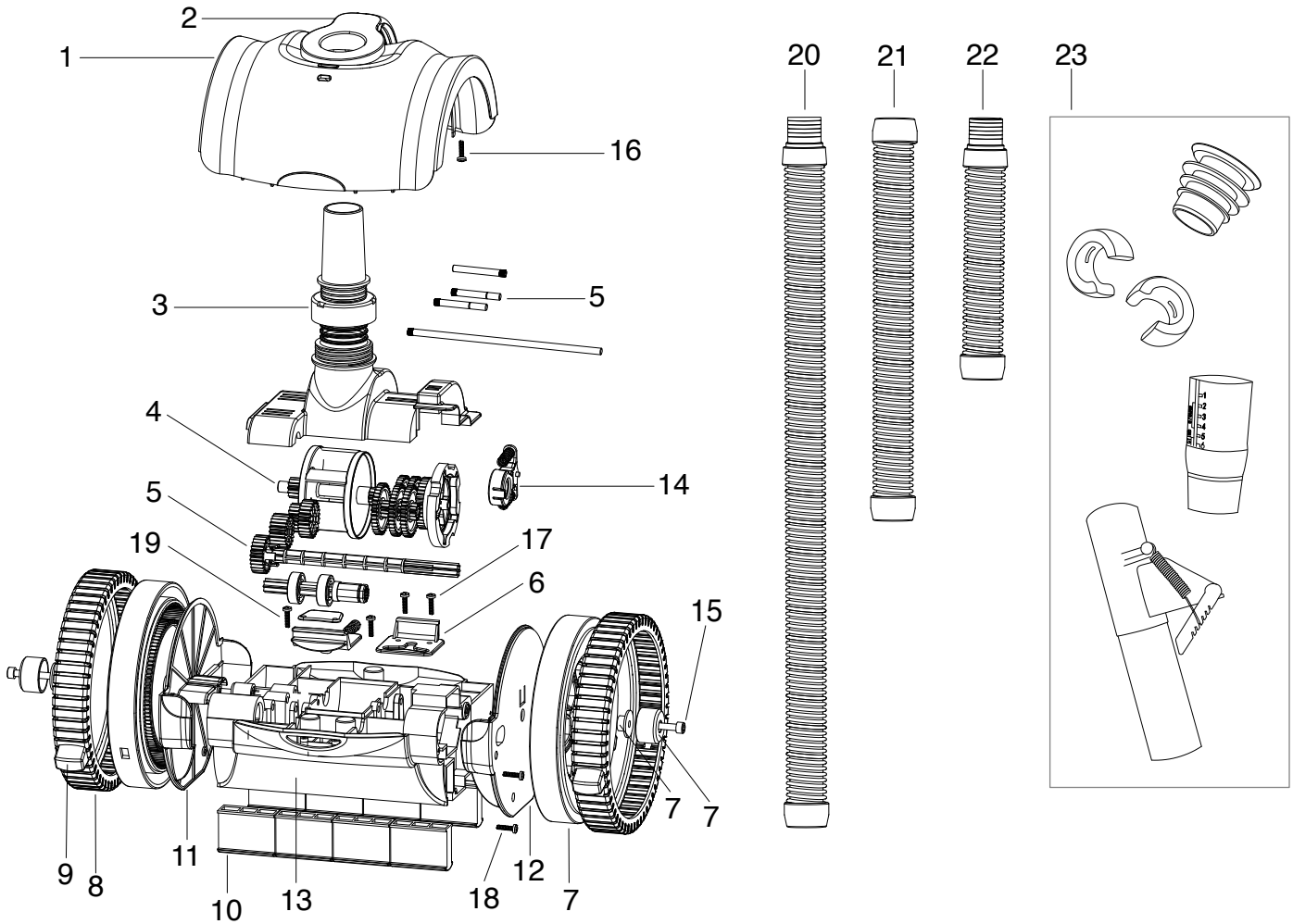

ITEM	PART NUMBER	DESCRIPTION	QTY
1	47329601394	COVER	1
2	47329603052	HANDLE	1
3	647329672001	GEAR COVER ASSEMBLY	1
4	647329673000	TURBINE ASSEMBLY	1
5	647329674000	GEAR / SHAFT ASSEMBLY	1
6	647329675001	BUTTON ASSEMBLY	1
7	647329676001	WHEEL ASSEMBLY	2
8	647329618817	TIRE KIT	2
9	4732961405	SUPPORTING FEET	2
10	4830712052	BALANCE BLOCK KIT	8
11	47329612001	LEFT WHEEL PANEL	1

ITEM	PART NUMBER	DESCRIPTION	QTY
12	47329613001	RIGHT WHEEL PANEL	1
13	47329602052	BASE	1
14	647329677000	SHAFT BASE ASSEMBLY	1
15	5214026000	SCREWS M6*40	2
16	5212077000	SCREWS ST4.2*16-F-H	6
17	5212006000	SCREWS ST4.2*12-F-H	2
18	5214028000	SCREWS ST3.5*13-C-H	8
19	5224026000	SCREWS M4*10	2
20	47325052054	HOSE 0.8M	14
21	47325053054	HOSE 0.8M	1
22	48930738054	HOSE 0.38M	1
23	647327583000	ACCESSORIES KIT	1

# DISCLAIMER

## DISCLAIMER

### ***PLEASE READ THE FOLLOWING CAREFULLY***

---

The manufacturer and/or distributor have provided the parts list and assembly diagram in this manual for reference purposes only. They do not make any representation or warranty to the buyer that they are qualified to make repairs to the product or replace any parts of the product. In fact, the manufacturer and/or distributor expressly state that all repairs and parts replacements should be undertaken by certified and licensed technicians, and not by the buyer.

The buyer assumes all risk and liability arising from their repairs to the original product or replacement parts or arising from their installation of replacement parts. It is strongly advised that qualified professionals handle any repairs or replacements to ensure safety and proper functioning of the product. Improper installation and operation may result in injury, property damage, or voiding of warranty. The manufacturer and/or distributor shall not be held responsible for any accidents, damages, or malfunctions resulting from the buyer's installation and operation of the product. It is essential to follow all safety guidelines and recommendations provided in this manual and to seek professional assistance if unsure about the installation or operation procedures.

---

## CUSTOMER SERVICE

If you have any questions about ordering our pool pumps and replacement parts or pool products, please feel free to contact us using the following contact information:

### ***Customer Service and Technical Support***

**Phone:** (909) 628-0880

**Email:** [customer@xtremepowerusa.com](mailto:customer@xtremepowerusa.com)

**Hours of Operation:** Monday – Friday, 9AM – 4PM (CST)

---