

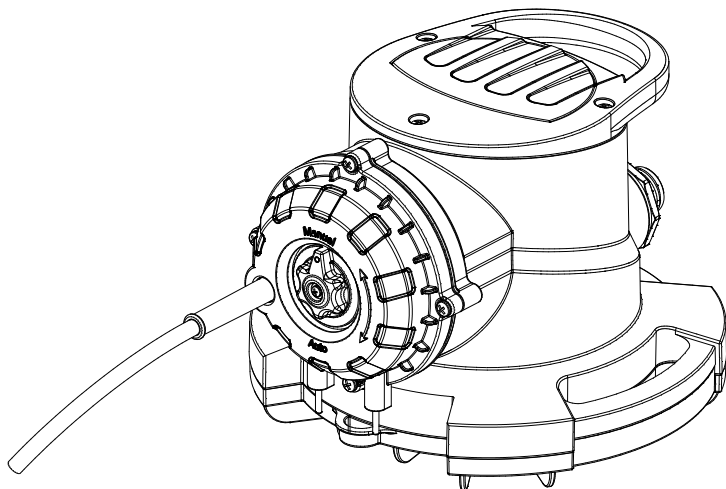

## AUTOMATIC & MANUAL POOL COVER PUMP

1/2 HP

SKU: 75172



**ASSEMBLY  
AND USER'S GUIDE**

75172

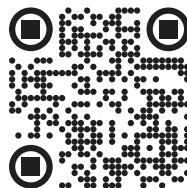



# TABLE OF CONTENT

|   |           |
|---|-----------|
| <b>TABLE OF CONTENTS</b> .....                | <b>1</b>  |
| <b>INSTRUCTIONS ON APPLICATION</b> .....      | <b>2</b>  |
| <b>SAFETY INSTRUCTIONS</b> .....              | <b>3</b>  |
| <b>OVERALL DIMENSION</b> .....                | <b>5</b>  |
| <b>INSTRUCTIONS ON THE EQUIPMENT</b> .....    | <b>6</b>  |
| <b>INTRODUCTION TO THE WORKING MODE</b> ..... | <b>7</b>  |
| <b>INTRODUCTION TO THE WORKING MODE</b> ..... | <b>8</b>  |
| <b>INSTALLATION AND USE</b> .....             | <b>9</b>  |
| <b>DAILY MAINTENANCE</b> .....                | <b>14</b> |
| <b>TROUBLESHOOTING</b> .....                  | <b>15</b> |
| <b>SPECIFICATION</b> .....                    | <b>16</b> |
| <b>DISCLAIMER</b> .....                       | <b>17</b> |
| <b>CUSTOMER SERVICE</b> .....                 | <b>17</b> |

# INSTRUCTIONS ON APPLICATION

Thank you for purchasing XtremepowerUS Pool Cover Pump. Before you use the equipment for the first time, please make sure to read this instruction manual and follow the contents of this instruction manual. Please keep this instruction manual appropriately for later reference.

Before trying installing, operating or repairing the product, please read the contents of the instruction manual carefully, so as to understand the application, restriction and potential dangers of the product. Please follow all the safety information. In case you do not follow these instructions, it may cause personal injury and life & property losses.

## **Instructions on application :**

\*This Pool Cover Pump is mainly used to drain the accumulated water on the pool cap or act as a submersible pump.

\*Medium to be pumped: Non drinking water with the impurity particle less than 0.2 INCH. Do not use it to pump corrosive substances, inflammable or explosive substances, and mud sewage with low flowability. The temperature of the liquid pumped should not exceed 95°F.

\*The pump is only designed for household use instead of industrial and commercial use.

\*The manufacturer shall not undertake any liability for damage caused by use not conforming to provisions or faulty operation.

# SAFETY INSTRUCTIONS



**Please be noted that there may be life danger caused by current in case of not following safety tips.**

1. Recommend setting up separate branch line for the power supply socket of the pump, and the socket power supply must conform to: 115V / 60HZ / 3.4A, with reliable grounding.
2. Recommend setting up current type leakage current breaker with the rated leakage current not more than 30mA for the power supply connection of the pump.
3. The electrical connection may only be done by the electrical professionals. Make sure to follow such a provision of the state.
4. Upon the pump use, do not use power cord to drag, move or transport this equipment. Do not pull the power cord on sharp edges or compress the power cord, as it may cause electric shock or life danger arising from power cord damage.
5. Make sure to inspect whether the plug conductor is damaged or not. In case the connecting conductor is damaged, make sure to ask electrical professionals of the authorized customer service outlet for replacement in case of danger.
6. To avoid dangers, all the installation concerning repair and parts replacement may only be completed by authorized service staff.
7. Do not use the pump to pump chemicals or corrosive liquids, which may destroy the completeness of the shell and cause electrical short circuit. Do not use this pump for pumping gasoline or other liquids with low ignition point, which may cause explosion or fire.

# SAFETY INSTRUCTIONS

8. Individuals with physical limitations, sensory impairments, limited understanding, or insufficient experience and knowledge are prohibited from using this equipment without the supervision or guidance of a qualified person who can provide instructions on safe equipment operation and educate them about potential hazards.
9. Children more than 8 years old may only use this equipment in case they are supervised by their custodians or obtain the guide on using the equipment, and understand the possible dangers. Don't let kids clean or repair the equipment without supervision.
10. Do not make the pump run dry for a long time. Operation without water may destroy the completeness of the shell and cause electrical short circuit.
11. Upon cleaning and repairing the pump, make sure to disconnect the pump with the main power supply first.
12. Do not use the pump in case there are people in the water.
13. When the environment temperature is lower than the freezing point, please do not use the pump but store it well, otherwise it may cause the shell breakage and cause electrical short circuit.

# OVERALL DIMENSION

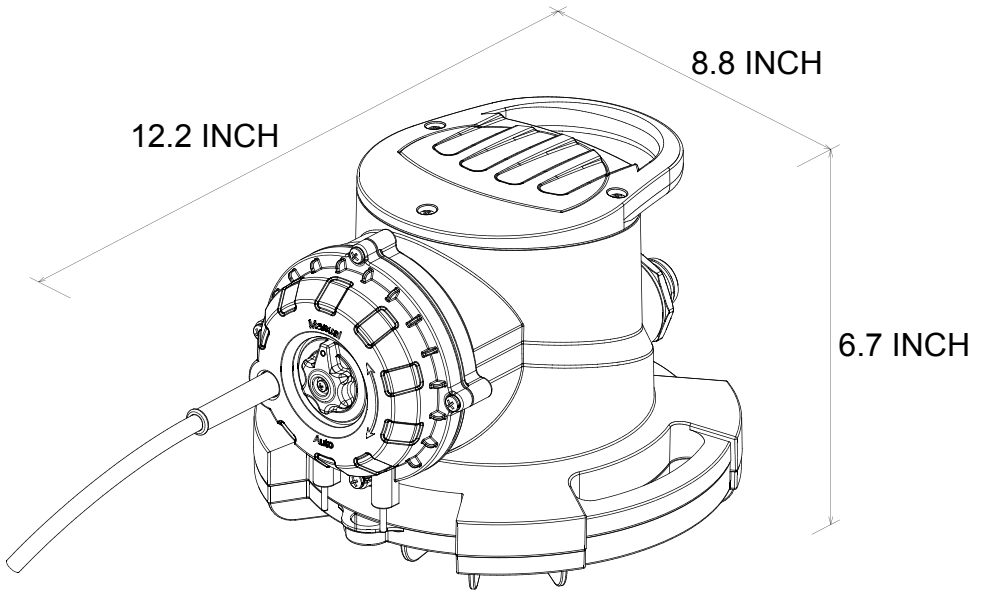

# INSTRUCTIONS ON THE EQUIPMENT

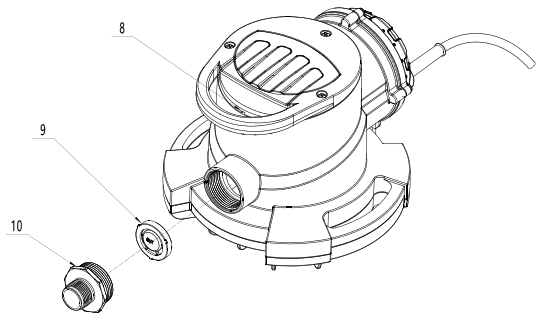
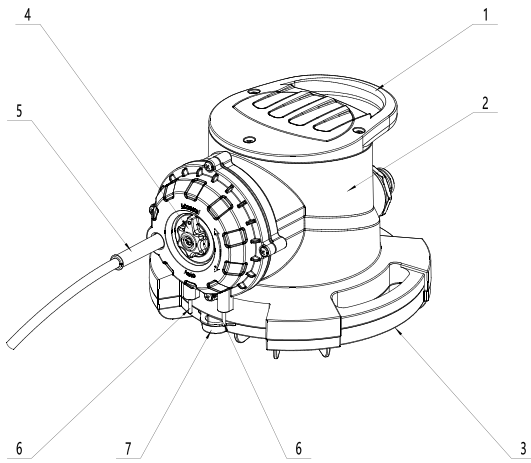

1. Handle
  2. Pump body
  3. Base
  4. Modular switch button (automatic / manual)
  5. Power cord
  6. Water level induction pin (two points)
  7. Base hoisting rope lug
  8. Air exhaust port
  9. Single-direction check valve
  10. Output connector
- Accessory: Hoisting rope (25 FT)



# INTRODUCTION TO THE WORKING MODE

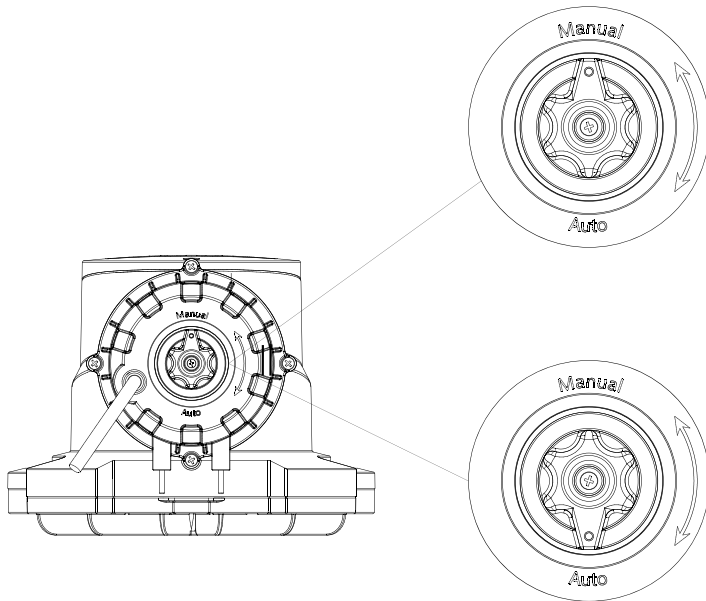

## Manual control mode

1. Rotate the knob to the Manual position.
2. Plug in the power cord.
3. Under manual mode, after plugging in the power cord, the pump will delay by 1s before starting, and the pump will run all time until the power cord is pulled off.

## Automatic control mode

1. Rotate the knob to the Auto position.
2. Plug in the power cord.
3. Under the automatic control mode, when the water level reaches the induction pin position, the pump will delay by 1s before starting; after the water level is lower than the induction pin for 15S, the pump will stop automatically; circulate like this.

# APPLICATION SCENARIO

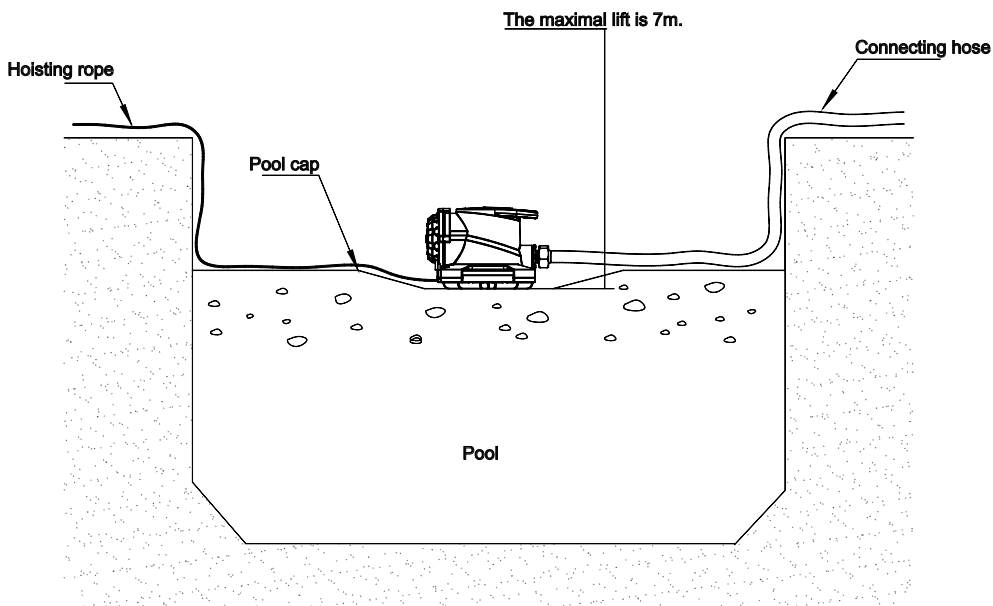

Attention!

The pump for the pool cap is mainly used for draining the accumulated water on the pool cap.



Attention!

Place the pump on the water accumulation place in the center of the pool cap and drain the accumulated water on the tarpaulin of the pool cap through the connecting hose.

# INSTALLATION AND USE

**Attention:** the surface with “Out” marking of the single direction check valve should be outward.

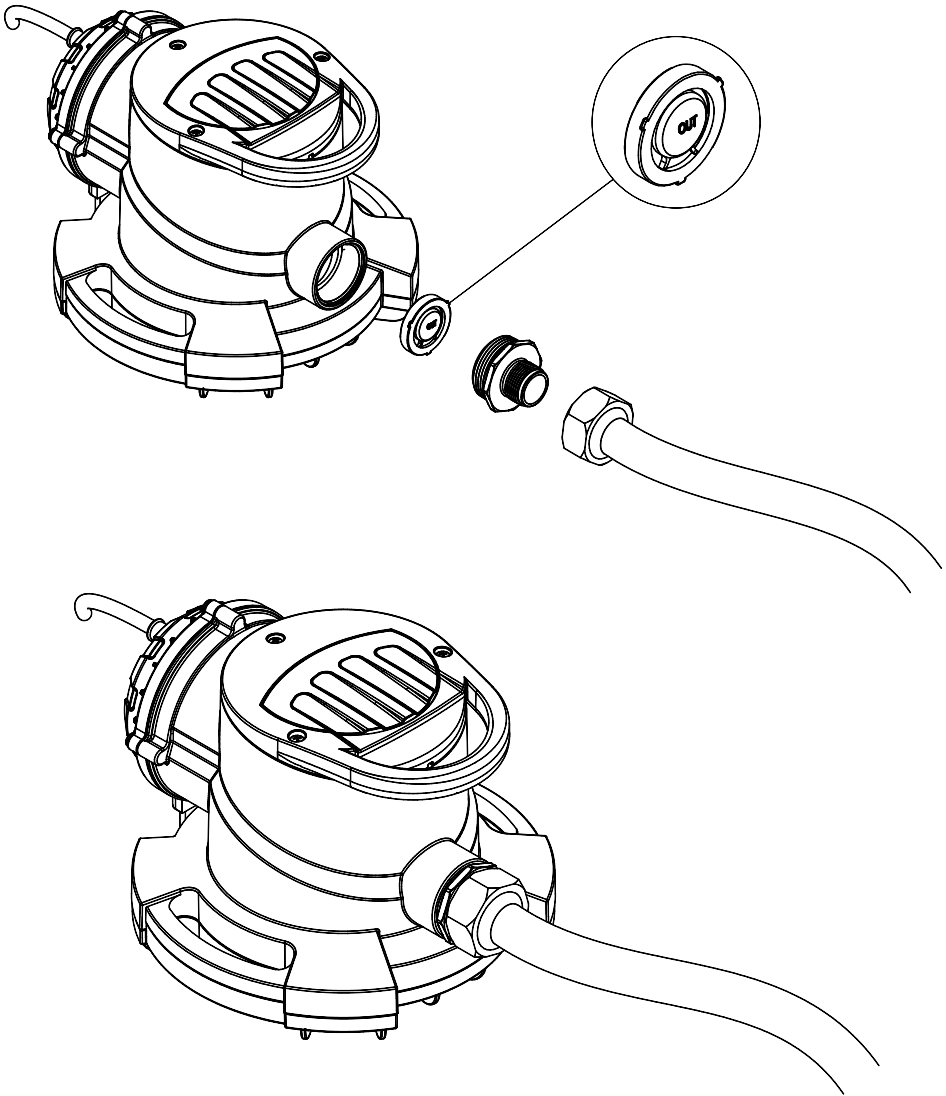

# INSTALLATION AND USE

1. Place the single direction check valve in the thread hole of the pump body, and tighten the output connector onto the water outlet of the pump and then connect the drainage hose.



**The surface with “Out” marking of the single direction check valve should be outward.**

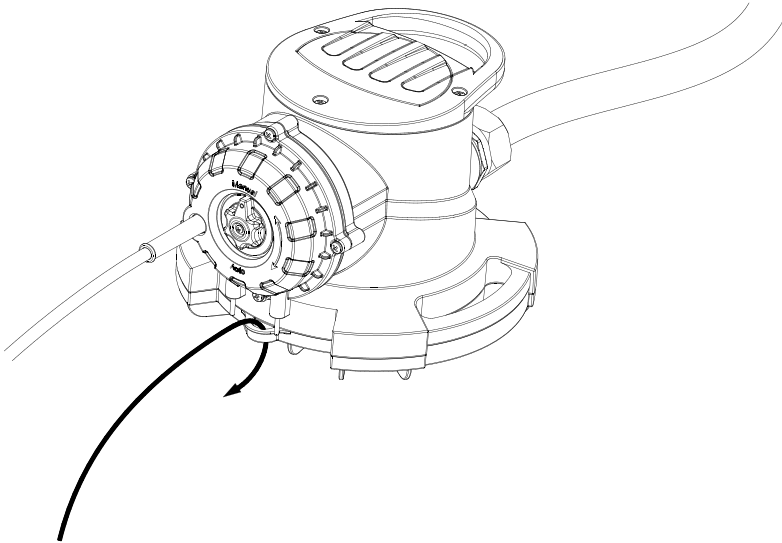

2. Run the attached hoisting rope through the hoisting rope lug, and tie it tightly.



**Do not affect the water level induction pin upon tying in case of damaging the water level induction pin upon pulling the pump body.**

# INSTALLATION AND USE

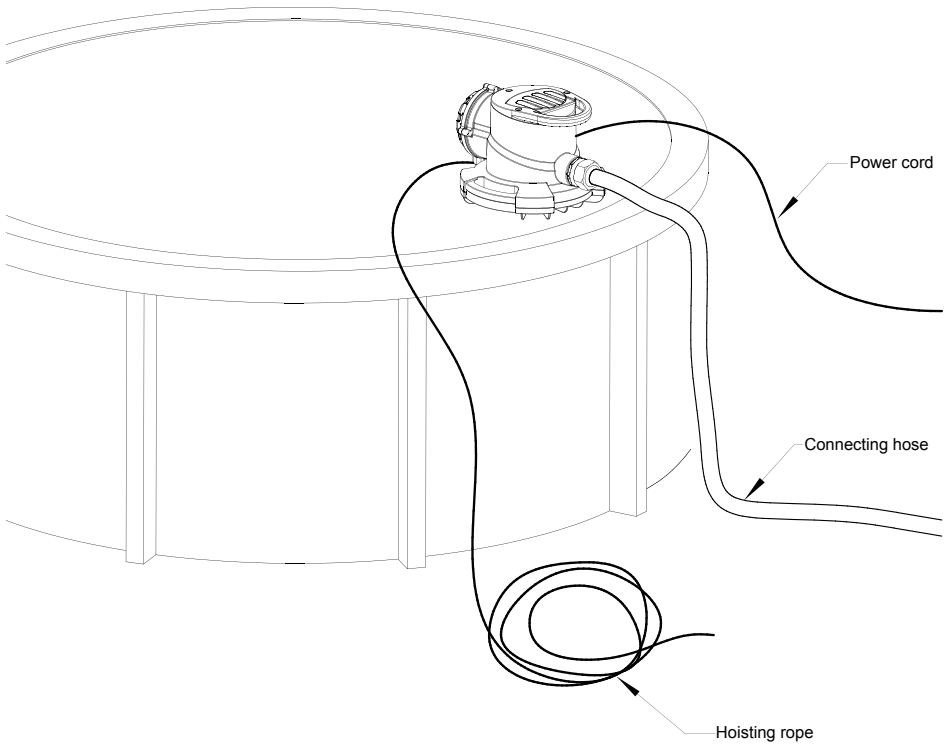

3. Place the pump on the edge of the pool cap.



**Prevent the power cord, hoisting rope and connecting hose from rubbing with the pool edge which may cause damages, and recommend the length of the connecting hose to be 7.5m.**

# INSTALLATION AND USE

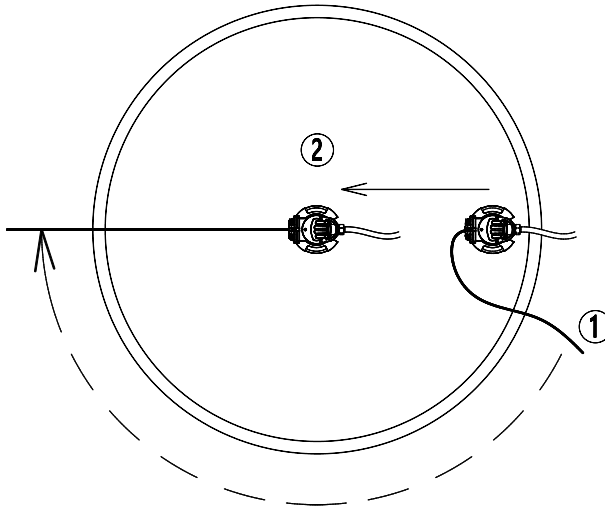

4. I. Hold the hoisting rope and walk around the pool to the opposite side of the pump.
- II. Pull the pump to the water accumulation place at the center of the pool cap, connect the power cord, and the installation of the pump is completed.



The pump needs to be placed vertically instead of being toppled. Do not place the pump on fragile, damaged or leakage pool cap in case the processed pool water and rainfall is pumped away from the pool by the pump. After the pump placement, it requires inspecting the pump working state daily; in case of any fault, cut off the power supply timely in case of electric shock. To achieve the best effect, try the best to place the pump on the place where the water accumulates the most easily, and make the bottom of the pump contact with the tarpaulin completely, filter the impurities effectively, clear the impurities on the tarpaulin periodically and prevent the pump obstruction effectively.

# DAILY MAINTENANCE

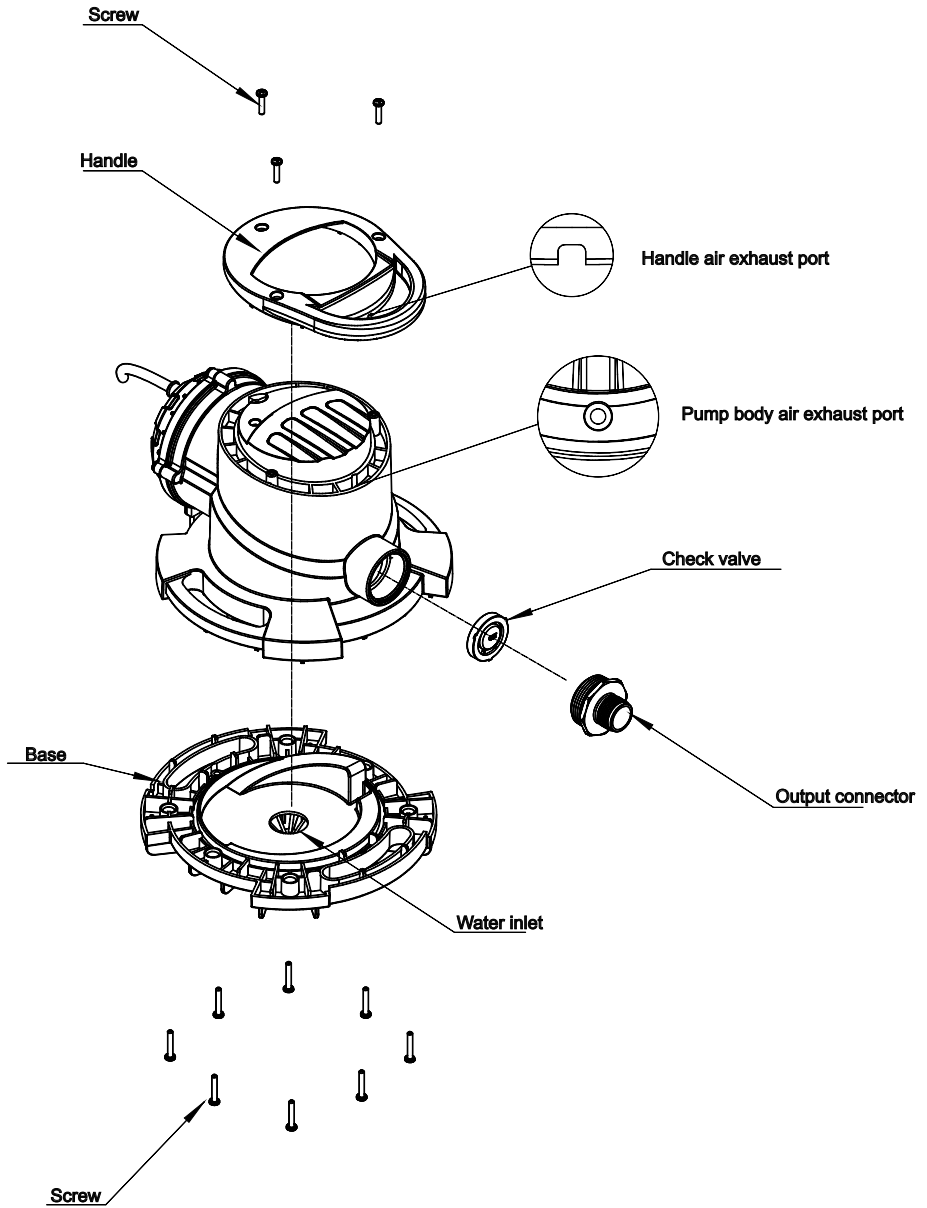

# DAILY MAINTENANCE

In daily use, in case of performance drop, it requires cleaning the product.

1. In case the motor shell is completely airtight, it requires no repair.
2. In case the pump runs normally, but fails to pump water normally, please inspect whether the single direction
3. The impurities around the pump may drop the pump performance or continuous operation, please clear the impurities around the filter periodically.
4. The impurities adhered to the induction pin may cause the pump unable to start normally, so please clear the dirt on the induction pin periodically.
5. The impurities in the pump may cause the pump unable to operate normally, such as obstruction, so please clear as per the following steps:
  - a. Unplug the power cord.
  - b. Disassemble the 8 screws as shown in the diagram, and remove the base.
  - c. Disassemble the impellor and diversion disc.
  - d. Clean all the impurities on the impellor, diversion disc and the water inlet of the base.
  - e. Disassemble 3 screws as shown in the diagram and remove the handle.
  - f. Clean the air exhaust port on the pump with pin or paper clip.
  - g. Assemble the diversion disc and impellor
  - h. Assemble the base.
  - i. Assemble the 8 screws again, and do not assemble it too tightly or miss to assemble any of them.
  - j. Assemble the handle.
  - k. Assemble the 3 screws again, and do not assemble them too tightly or miss to assemble any of them.
  - l. Plug in the power cord again.



# TROUBLESHOOTING

| Faults   | Causes  | Troubleshooting   |
|--|---|---|
| The pump fails to start or run                 | The power supply is cut off   | Inspect the safety device and electrical connection                 |
|  | Fail to reach the starting water level.                                 | Inspect whether the water level reaches the induction pin position. |
|  | There are foreign bodies on the induction pin.                          | Clean the induction pin   |
|  | Over-heating protection of the motor                                    | Operate as per the Step 5 of daily maintenance                      |
|  | The impellor gets stuck   | Operate as per the Step 5 of daily maintenance                      |
| The pump fails to turn off or run continuously | The check valve is not installed or is damaged.                         | Install or replace the check valve                                  |
|  | There are impurities on the induction pin.                              | Clean the induction pin   |
|  | There are moist leaves around the sensor needle conducting electricity. | Remove leaves around the sensor needle.                             |
|  | There are foreign bodies on the check valve                             | Inspect and wash the check valve                                    |
|  | Exceed the drainage height  | Reduce the drainage height  |
|  | Manual mode   | Switch to auto mode   |
| Low pumping efficiency or failure              | The water inlet obstruction   | Clean the water inlet (refer to the daily maintenance steps)        |
|  | Air exhaust port obstruction  | Clean the air exhaustport (refer to the daily maintenance steps)    |
|  | Hose obstruction  | Inspect the twists, replace it again or inspect the impurities.     |
|  | Exceed the drainage height  | Reduce the drainage height.   |
|  | Check valve installation error  | Install the check valve again                                       |

# SPECIFICATION

|                   |                              |
|-------------------|------------------------------|
| <b>Model</b>      | <b>75172</b>                 |
| Nominal Voltage   | 115 V / 60 HZ / 3.4 A        |
| Nominal Output    | 1/2 HP                       |
| Max. Pump Rate    | 1743 GPH                     |
| Max. Height       | 25 FT                        |
| Max. grain size   | 1/2"                         |
| Outlet Dia.       | NPT 1-1/4"                   |
| Adapter Fitting   | NPT 3/4" GARDEN HOSE         |
| Water Temperature | 95 °F                        |
| Cable             | SJTW 18AWG 3C-UL SHAFT: #420 |
| Cable Length      | 25 FT                        |

## **Risk for equipment damage!**



**The particle size mentioned cannot be used for simple gravel or stone, but suitable for soft, variability of particles or similar things which cannot put into the water pump.**

# DISCLAIMER

## DISCLAIMER

### *PLEASE READ THE FOLLOWING CAREFULLY*

---

The manufacturer and/or distributor have provided the parts list and assembly diagram in this manual for reference purposes only. They do not make any representation or warranty to the buyer that they are qualified to make repairs to the product or replace any parts of the product. In fact, the manufacturer and/or distributor expressly state that all repairs and parts replacements should be undertaken by certified and licensed technicians, and not by the buyer.

The buyer assumes all risk and liability arising from their repairs to the original product or replacement parts or arising from their installation of replacement parts. It is strongly advised that qualified professionals handle any repairs or replacements to ensure safety and proper functioning of the product. Improper installation and operation may result in injury, property damage, or voiding of warranty. The manufacturer and/or distributor shall not be held responsible for any accidents, damages, or malfunctions resulting from the buyer's installation and operation of the product. It is essential to follow all safety guidelines and recommendations provided in this manual and to seek professional assistance if unsure about the installation or operation procedures.

---

## CUSTOMER SERVICE

If you have any questions about ordering our outdoor furnitures and replacement parts or other furniture products, please feel free to contact us using the following contact information:

### *Customer Service and Technical Support*

**Phone:** (909) 628-0880

**Email:** [customer@xtremepowerusa.com](mailto:customer@xtremepowerusa.com)

**Hours of Operation:** Monday – Friday, 9AM – 4PM (CST)

---