

SUBMERSIBLE SEWAGE PUMP
3/4HP CAST IRON SUMP 8400GPH MAX 28FT
SKU: 76062

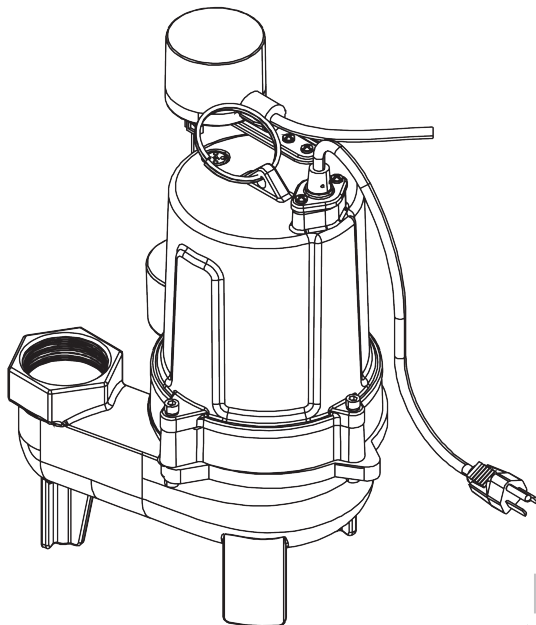

E248578
QSB-JH-1300215



ASSEMBLY
AND USER'S GUIDE

76062

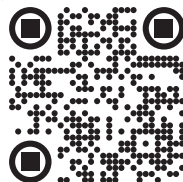
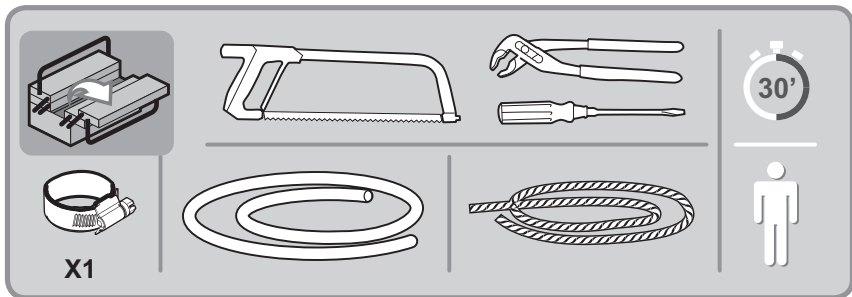
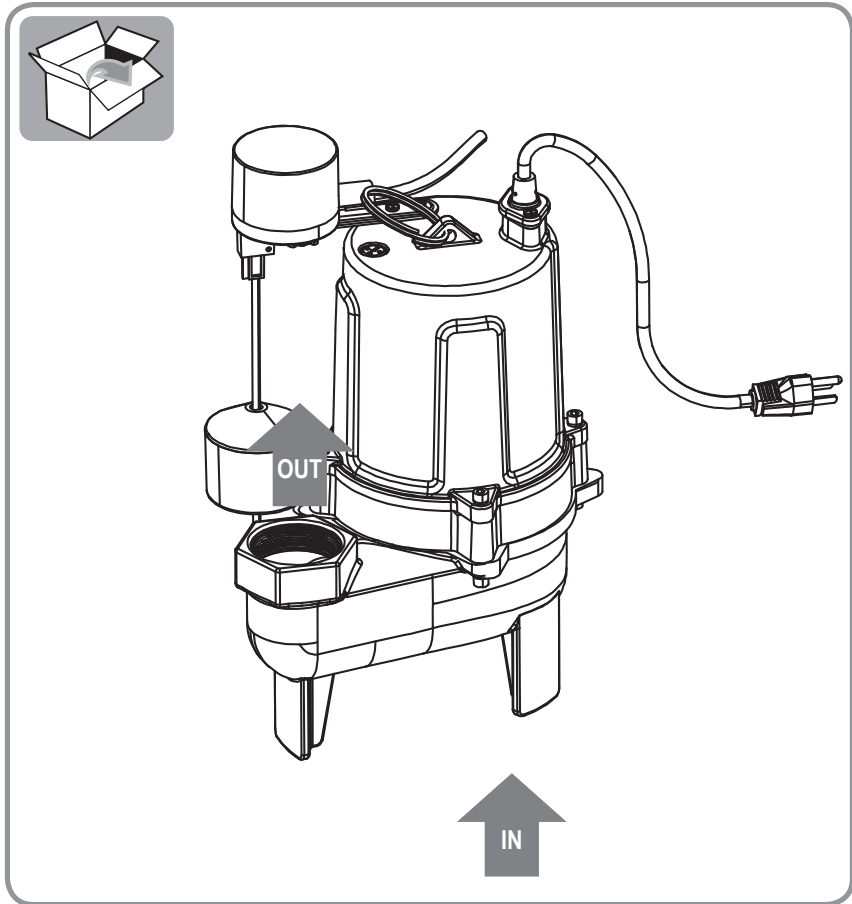



TABLE OF CONTENT

TABLE OF CONTENTS.....	1
QUICK START.....	2
GENERAL.....	6
QUALITY INSURANCE.....	7
SAFETY.....	8
OPERATION INSTRUCTION.....	9
AUTOMATIC CONTROL.....	11
TRANSPORTATION.....	12
MAINTENANCE.....	13
SPECIFICATION.....	14
PARTS DIAGRAM.....	15
PARTS INFORMATION.....	16
DISCLAIMER.....	17
CUSTOMER SERVICE.....	17

QUICK START



QUICK START

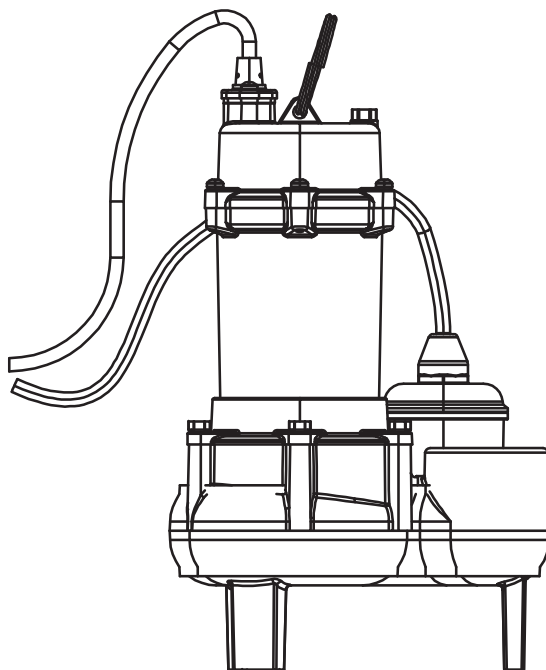

Attention danger



Not connected



Power up



Observez



Maintenance



Connected



Stop



Clean Water Environment

QUICK START

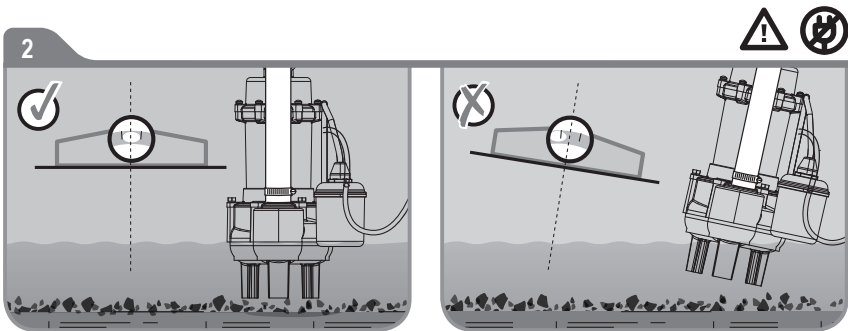
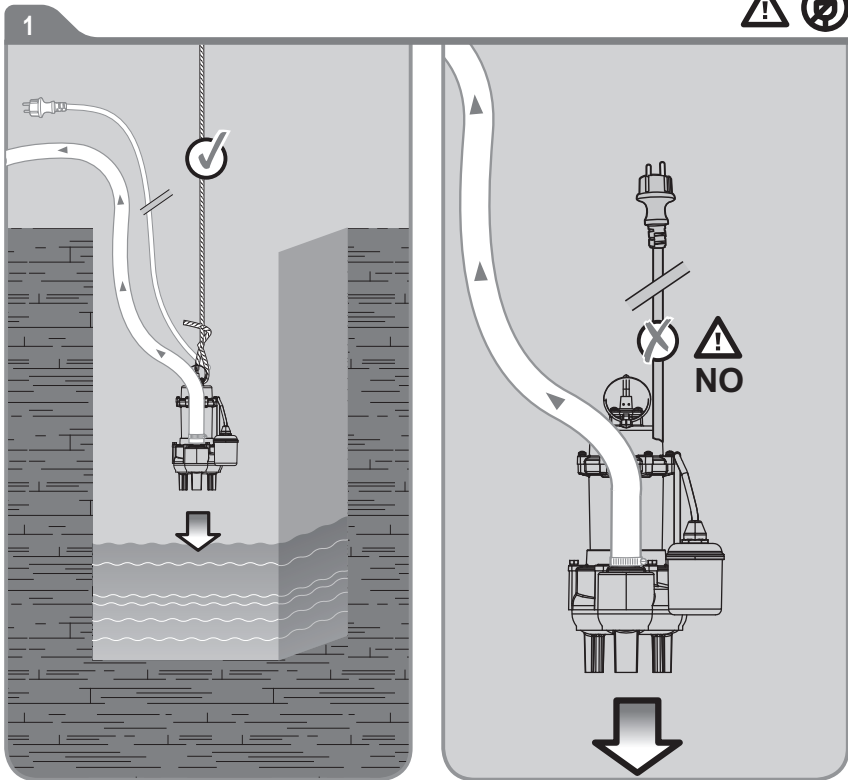

QUICK START

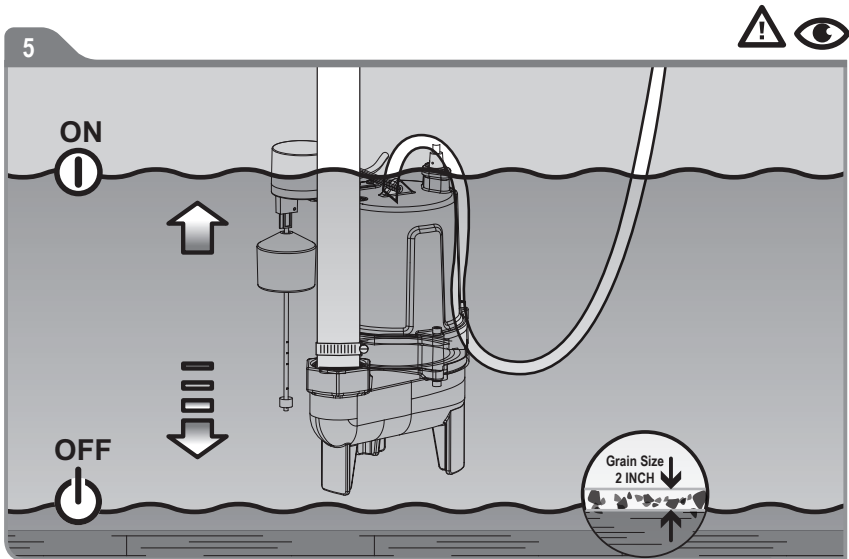
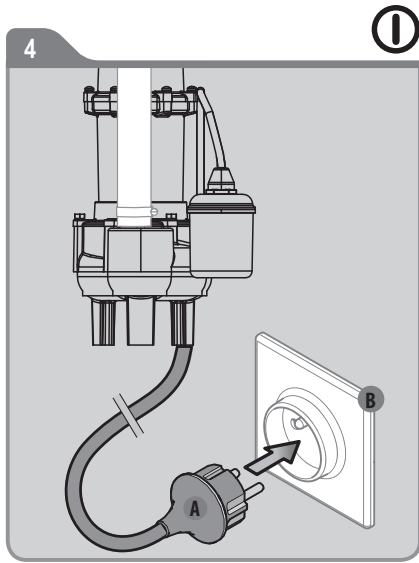
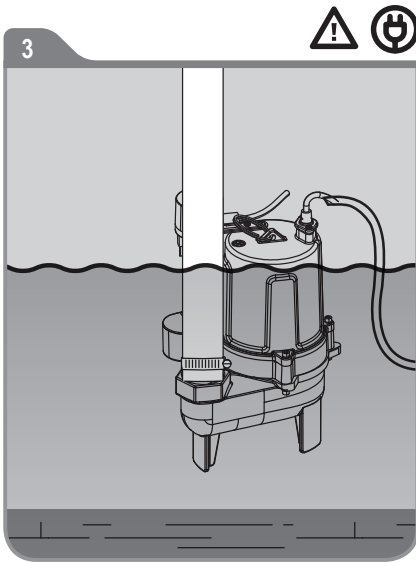

GENERAL

Dear clients,



Please read and follow the original copy of the Operation Manual first before operating the device for the first time, and pay attention to keep the Manual for convenient use in the future or for other users.

Legal Use

The submersible pump is designed for personal use, not for industrial use. For any damage due to illegal use or wrong operation, the manufacturer shall assume no responsibility.

The equipment is mainly used for (sewage), and used to pump and drain the water in home basements or swimming pools, garden pools and fountains.

Caution: The conveying water in the pump is not drinking water.

Permitted conveying liquid:

Water with impurity particles less than 2 INCH.



Cautions

It is forbidden to convey corrosive substance, flammable and explosive hazardous substance (gasoline, petroleum, nitro diluents, etc.), grease, oil, salt water, dirty water in the sanitary outfit and muddy water with low mobility. The temperature of the conveying liquid should be not exceeding 30. The pump is not suitable for continuous pumping operation or fixed installation (including lifting device, fountain pump, etc.)

Environment Protection



The packing material can be recycled. Please don't put the packing material with common rubbish together. The material should be recycled properly.



The used equipment include precious materials can be reused, and it should be recycled and reused. Please handle your used equipment through suitable collecting system.

Quality Insurance

In the guarantee period, if there is any fault about your product, we will provide you free maintenance, but the fault should be caused by pump materials or manufacturing defect. Please contact the dealer and provide relevant product purchasing certificates.

QUALITY INSURANCE



Danger

Cause immediate danger of serious damage to the body or even death.



Alarming

Hidden dangerous condition, may cause serious damage to the body or even death.

Cautions:

Hidden dangerous condition may cause slight injury or damage to the body.

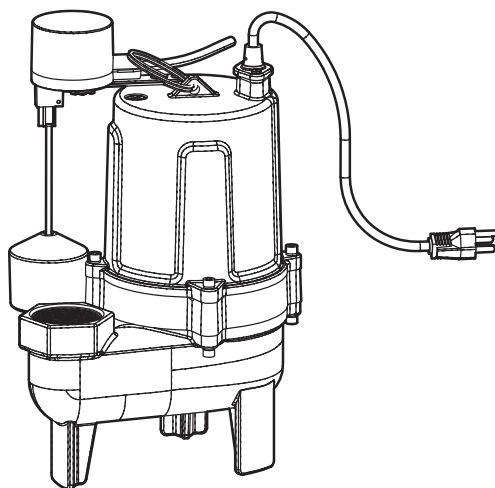

SAFETY



Life Danger

If you don't follow the safety tips, life danger with electricity may occur.

- Check if there is any damage of the connecting wire with plug before each run. If so, change the damaged connecting wire immediately by authorized client service center or electrical professionals.
- All the electrical sockets must be grounded.
- Unsuitable extension cable may have danger. Please use approved suitable extension cable out of doors. Make sure the cable have been authenticated and have enough cross-section of conductor.
- The connector of electrical plug and extension cable must guarantee waterproof and can't be placed in the water. In addition, it can't be placed on the ground. It is suggested that the socket should be at least 60mm distance away with the ground.
- When delivering or fixing the pump, it is forbidden to use power line to drag.
- When cutting off the power of the pump, please unplug the plug, and don't drag the power line directly.
- Don't pull the power line along the sharp edge and don't extrude the power line.
- The voltage of the power supply must accord with the value on the nameplate.
- To avoid damage, the installation of all the maintenance and changing of spare parts only can be finished by approved client service personnel.
- Pay attention to the electric protective devices:
- For the sake of security, we suggest using the pump through a fault current protection switch.
- Please make sure to follow national regulation to connect the electricity through electrical professionals.
- People with limited body ability, weak sensory ability, bad comprehensive ability or people lack of experience and / or lack of knowledge are not allowed to use the pump, unless they are monitored by special person or have received guidance by special person for how to operate the pump and understand potential danger.
- Children over eight can't use the pump unless they are monitored by special person or have received guidance by special person for how to operate the pump and understand potential danger. It is forbidden for children to play with the pump.
- Look after the children carefully to make sure that they don't play with the pump.
- Children are not allowed to clean and maintain the pump without watching.

OPERATION INSTRUCTION

Pump Instruction

1. Lift ring handle
2. Power line
3. Pump case
4. Base
5. Floating balls
6. Water pump outlet

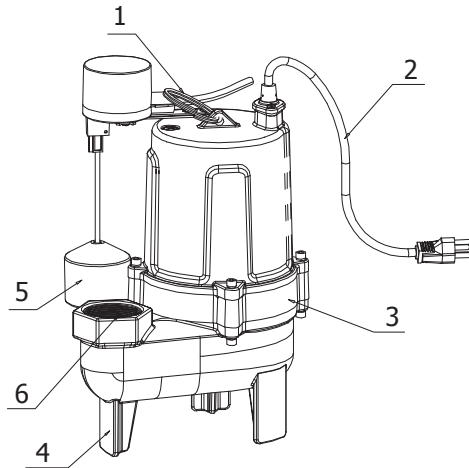

Preconditions

To guarantee normal operation of the pump, the following preconditions must be satisfied:

- The outlet of the pool should be no smaller than 11 × 9.45 INCH in square or Φ 11 INCH in round.
- The water level is higher than 9.65 INCH so that the pump can pump the water fast.

Hints:

When the water in the pool is scarce (the water depth is lower than 5.67 INCH), there is certain interval time between pump start and beginning to draw water (it is normal within 2 minutes).

Cautions:

If the bottom of the water pool is not even, it may cause that the pump can't reach the nominal parameter on the nameplate when drawing under low water level.

Cautions:

Serious slant setting or turnover of the pump may affect the invalidation of float switch, so please place the pump vertical to the flat ground.

- Connect the suitable hose assembly with the outlet of the pump case and tighten it up by twisting. (Figure B)

OPERATION INSTRUCTION

As shown in the Figure B.

The max submersible depth (h_1) stands for the max installation water depth of the pump (if the placing depth of the pump is deeper than the nominal value on the nameplate, it may reduce the service life of the pump or let motor cavity inflow water.)

The conveying height (h_2) stands for the height difference from water level to outlet end of the water tube. So the pump should work within the range of max conveying height.

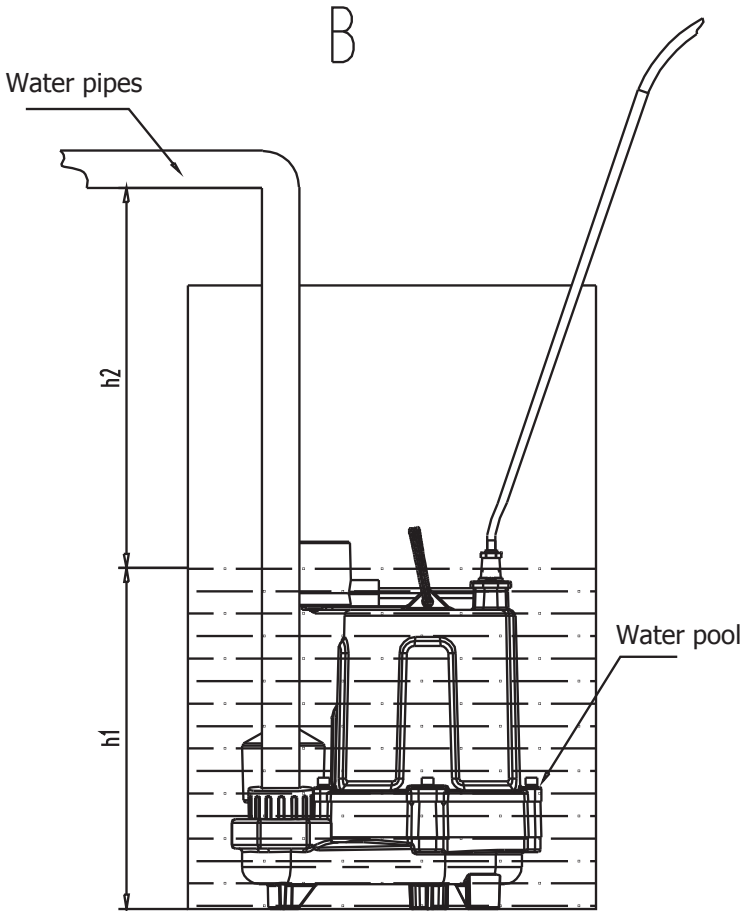

AUTOMATIC CONTROL

- Plug in the power supply.
- When the water level rises to drive the float up to a certain place, the switch turns on automatically and the water pump starts to work; when the water level falls to drive the float down to a certain place, the switch turns off and the pump stops working. The cycle will start all over again.
- When it is under other working conditions except complete water draining, unplug the plug of the power line directly from the socket.

Cautions:

Dry running damages the pump.
Keep the float in the state of free-moving.

Cleanness



Danger

Electric shock danger. Make sure all the plugs have been unplugged before all the maintenance work.

Hints:

The water inlet should be cleaned regularly in case the pump fails to function due to the deposition of debris causing the float ball to jam or the water inlet being clogged.

- Unplug the plug of the power supply from the socket.
- Remove the water tube.
- Clean up the pump with a suitable brush and rinse it well.

Maintenance

The pump is maintenance free.

TRANSPORTATION

Cautions:

To avoid accident and damage, pay attention the weight of the device during carrying.

Vehicle Transport

- Make sure the pump will not slip down, be squeezed and vibrate during transportation.

Storage

Cautions:

To avoid accident and damage, pay attention the weight of the device when selecting the storage location.

- It should be considered that the switch and the switch signal line cannot be pressed when the equipment is placed upright and the handle is folded.



Cautions:

Frost may damage the pump which is not completely cleared up.

- Clear up the water and foreign matters thoroughly before storage.
- The pump should be stored in the place will not be freezed.

MAINTENANCE

Danger

To avoid any damage, only approved client server center is permitted to maintain the pump.

Make sure to power off the pump and unplug the plug before any operation to the pump.

Fault	Reason	Trouble shooting
The pump runs but doesn't convey the water	There is air in the pump	Plug and unplug the power cord multiple times
	The water inlet has been blocked	Unplug and clean the water inlet
The pump can't run or the pump stops suddenly during operation	The power cuts off	Check fuse device and electrical connection
	The motor is overheating, so the heat protector of the motor switches off the pump	Switch off the pump, unplug the plug of power supply to make the pump cool, Clean the water inlet of the base and prevent dry running
	There are foreign matters in the water inlet	Switch off the pump, unplug the plug of power supply and get the foreign matters out
The conveying efficiency falls off	The water inlet has been blocked	Switch off the pump, unplug the plug of power supply and clean the water inlet area

SPECIFICATION

Model	76062
Voltage & Frequency	115V / 60Hz
Current	12A
Power	3/4 HP
Max. Pump Rate	8400 GPH
Max. Height	28 FT
Max. Grain Size	2 INCH
Dia. Of Pipe	NPT 2
Water Temperature	95 °F
Protection Type	IPX 8
Outlet	NPT 2

PARTS DIAGRAM

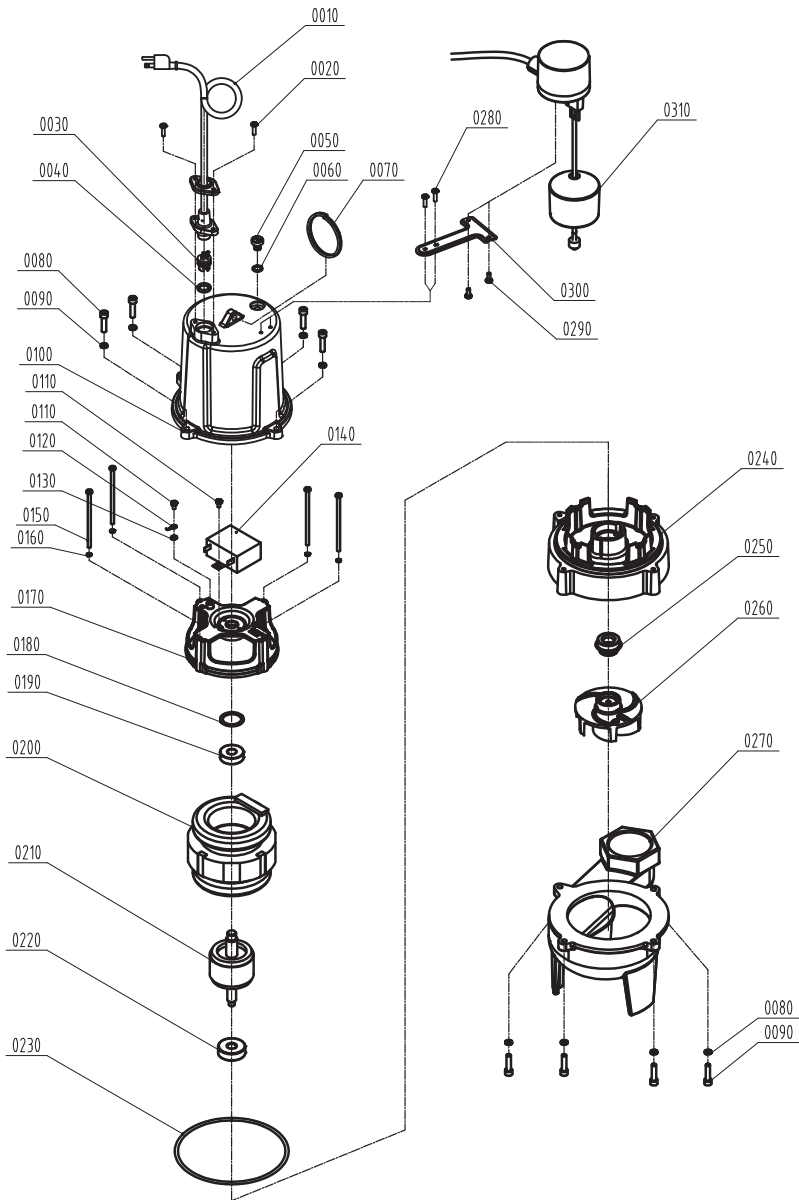

PARTS INFORMATION

Item	Parts No.	Description	Qty.	
0010	253002067	Power cord	1	PCS
0020	207000754	Cross head tapping screw	2	PCS
0030	201005571	Pin assembly	1	PCS
0040	208001257	O-ring	1	PCS
0050	201001697	Sealing bolt	1	PCS
0060	208001222	O-ring	1	PCS
0070	206000007	Ring handle	1	PCS
0080	207000196	Hexagon socket head cap screws	8	PCS
0090	207000487	Spring washer	8	PCS
0100	205000420	Motor case	1	PCS
0110	207000236	Screw assembly	2	PCS
0120	209001262	Earthing conductor	1	PCS
0130	207000503	External serrated lock washer	1	PCS
0140	209001254	Capacitor	1	PCS
0150	207000932	Cross head tapping screw	4	PCS
0160	207000478	Spring washer	4	PCS
0170	202000583	Aluminum rear cover	1	PCS
0180	204000090	Corrugated gasket	1	PCS
0190	207000534	Bearing	1	PCS
0200	251000862	Stator	1	PCS
0210	252001140	Rotor	1	PCS
0220	207000561	Bearing	1	PCS
0230	208001230	O-ring	1	PCS
0240	205000426	Pump case	1	PCS
0250	208000690	Mechanical seal	1	PCS
0260	201005575	Impeller	1	PCS
0270	205000428	Pump base	1	PCS
0280	207000743	Cross head tapping screw	2	PCS
0290	206000203	Customization tapping screw	2	PCS
0300	204001140	Connecting plate	1	PCS
0310	253001467	Float switch	1	PCS
0320	212000026	25# Transformer oil	1.54	LBS
0330	212000014	Thread locking agent	0.0027	FL OZ
0340	212000015	Sealant	0.007	FL OZ

DISCLAIMER

DISCLAIMER

PLEASE READ THE FOLLOWING CAREFULLY

The manufacturer and/or distributor have provided the parts list and assembly diagram in this manual for reference purposes only. They do not make any representation or warranty to the buyer that they are qualified to make repairs to the product or replace any parts of the product. In fact, the manufacturer and/or distributor expressly state that all repairs and parts replacements should be undertaken by certified and licensed technicians, and not by the buyer.

The buyer assumes all risk and liability arising from their repairs to the original product or replacement parts or arising from their installation of replacement parts. It is strongly advised that qualified professionals handle any repairs or replacements to ensure safety and proper functioning of the product. Improper installation and operation may result in injury, property damage, or voiding of warranty. The manufacturer and/or distributor shall not be held responsible for any accidents, damages, or malfunctions resulting from the buyer's installation and operation of the product. It is essential to follow all safety guidelines and recommendations provided in this manual and to seek professional assistance if unsure about the installation or operation procedures.

CUSTOMER SERVICE

If you have any questions about ordering our outdoor furnitures and replacement parts or other furniture products, please feel free to contact us using the following contact information:

Customer Service and Technical Support

Phone: (909) 628-0880

Email: customer@xtremepowerusa.com

Hours of Operation: Monday – Friday, 9AM – 4PM (CST)
