

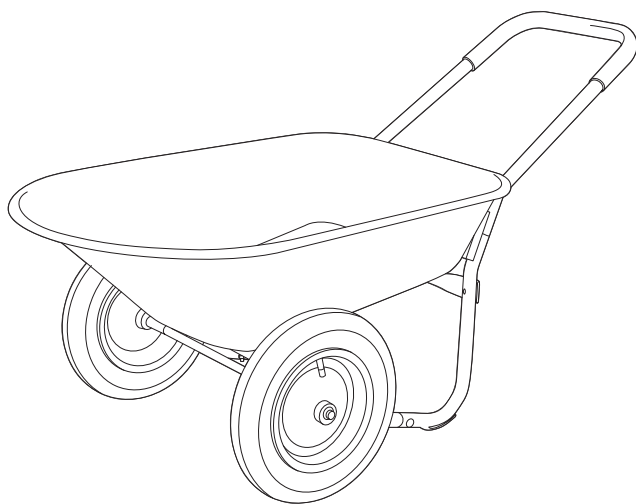

**DUAL WHEEL WHEELBARROW**  
**METAL TRAY 16 INCH FLAT-FREE TIRE**

**SKU: 81021**



## **ASSEMBLY AND USER'S GUIDE**



**Read all safety warnings and instructions. Failure to follow the warnings and instructions may result in serious injury. Save all warnings and instructions for future reference.**



**THIS PAGE INTENTIONALLY LEFT BLANK**

# TABLE OF CONTENT

<b>IMPORTANT SAFETY INSTRUCTIONS .....</b>	<b>1</b>
<i>Legends and Symbols .....</i>	<b>2</b>
<b>GENERAL SAFETY INFORMATION .....</b>	<b>3</b>
<b>PRODUCT INFORMATION .....</b>	<b>4</b>
OVERVIEW .....	<b>4</b>
INTRODUCTION .....	<b>5</b>
SPECIFICATION .....	<b>6</b>
<b>ASSEMBLY INSTRUCTIONS .....</b>	<b>7</b>
STEP 1 .....	<b>7</b>
STEP 2 .....	<b>8</b>
STEP 3 .....	<b>9</b>
STEP 4 .....	<b>10</b>
STEP 5 .....	<b>11</b>
STEP 6 .....	<b>12</b>
STEP 7 .....	<b>13</b>
<b>REPLACEMENT PARTS .....</b>	<b>14</b>
PARTS DIAGRAM .....	<b>14</b>
PARTS LIST .....	<b>14</b>
<b>DISCLAIMER .....</b>	<b>15</b>
<i>Disclaimer .....</i>	<b>15</b>
<i>Customer Service .....</i>	<b>15</b>

---

## CUSTOMER SERVICE

If you have any questions about ordering our pool pumps and replacement parts or pool products, please feel free to contact us using the following contact information:

### ***Customer Service and Technical Support***

**Phone:** (909) 628-0880

**Email:** [customer@xtremepowerusa.com](mailto:customer@xtremepowerusa.com)

**Hours of Operation:** Monday – Friday, 9AM – 4PM (CST)

---

# IMPORTANT SAFETY INSTRUCTIONS

## IMPORTANT SAFETY INSTRUCTIONS

This guide provides instructions for installing and using the Pallet Truck Stacker Dolly Lift. If you have any questions about the equipment, please contact XtremepowerUS.

This guide contains important information about safely installing and operating this product. After installation, make sure to share this information with the owner/operator or leave it with them for their reference.

### *Legends and Symbols*

When you come across the safety-alert symbol on your equipment or in this manual, pay attention to the following signal words and remain vigilant about the potential for personal injury.

 **DANGER:** Ignoring these hazards can result in death, severe personal injury, or significant property damage.

 **WARNING:** Indicates potential hazards that can result in severe personal injury, death, or significant property damage. Ignoring these warnings presents a real danger.

 **CAUTION:** Indicates potential hazards that can result in minor or moderate personal injury, property damage, or actions that are unpredictable and unsafe. Ignoring these cautions presents a potential hazard.

 **NOTE:** This label indicates important special instructions that are not directly related to hazards.

---

### **USE OF NON-XTREMEPOWERUS REPLACEMENT PARTS VOIDS WARRANTY**

**ATTENTION INSTALLER:** This manual contains vital information regarding the installation, operation, and safe use of this product. It is essential to provide this manual to the end user of the product. Failure to read and follow all instructions could lead to severe injuries.

---

 Failure to comply with all instructions and warnings may lead to severe bodily injury or even death. For optimal safety and functionality, it is advisable to have the product installed and serviced by a certified service professional. Prior to using this product, installers, operators, and owners must carefully review these warnings and all instructions provided in the owner's manual. It is essential to leave these warnings and the owner's manual with the owner for their reference and safety.

 For safety reasons, children should not be allowed to use this product. Packing materials and plastic bags are not toys. Keep them away from children to prevent the risk of suffocation.

# IMPORTANT SAFETY INSTRUCTIONS

## GENERAL SAFETY INFORMATION

### **⚠ DANGER**

- **Weight Limit:** Do not exceed the weight limit of 330 lbs. Overloading may result in injury or damage.
- **Avoid Riding:** Do not sit or ride in the wheelbarrow.
- **Proper Use:** Follow the manufacturer's instructions for proper use.
- **Usage Restrictions:** This item is not to be used as a step ladder or for any purpose other than its intended function.
- **Exceeding Load Capacity:** Never exceed the recommended load capacity, as overloading may cause the wheelbarrow to tip, posing serious risks.
- **Emergency Lowering:** In the event of an emergency, lower the load immediately if it is safe to do so.

### **⚠ WARNING**

- **Child Safety:** Do not allow children to use this item unsupervised.
- **Avoid Hazards:** Avoid using the wheelbarrow near sharp or hazardous objects to prevent tire damage.
- **Condition of Equipment:** Cease use if any parts are missing, broken, or worn. Ensure all repairs and replacements are made before reuse.



### **⚠ CAUTION**

- **Loading Guidelines:** Always distribute the load evenly across the surface of the tray.
- **Stable Loading:** Do not place weight on the edges of the tray, as this can cause imbalance or damage.
- **Sharp Edges:** Be cautious when handling parts that may have heavy or sharp edges.

### **★ NOTE**

- **Assembly and Maintenance:** Firmly secure all bolts, screws, and knobs before use.
- **Pre-Use Inspection:** Reconfirm that all bolts, screws, and knobs are secure every 90 days.
- **Keep these instruction for future use.**

# OVERVIEW (PRODUCT INFORMATION)

## PACKAGE CONTENTS

### PARTS

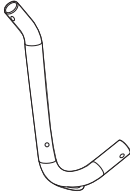

**PART#: A**  
**BACK FRAME**  
2 PC(S)

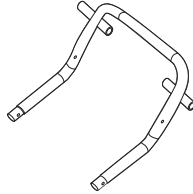

**PART#: B**  
**FRONT FRAME**  
1 PC(S)

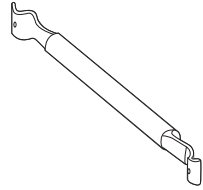

**PART#: C**  
**CENTER SUPPORT**  
1 PC(S)

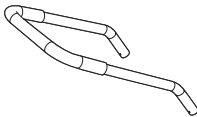

**PART#: D**  
**HANDLE**  
1 PC(S)

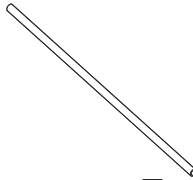

**PART#: E**  
**AXLE**  
1 PC(S)

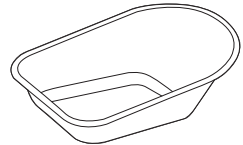

**PART#: F**  
**TRAY**  
1 PC(S)

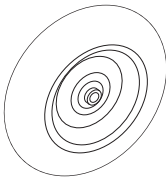

**PART#: G**  
**WHEEL**  
2 PC(S)

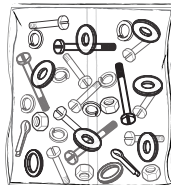

**PART#: H**  
**HARDWARE BAG**  
1 PC(S)



**INSTRUCTION**  
**MANUAL**  
1 PC(S)

# OVERVIEW (PRODUCT INFORMATION)

## PACKAGE CONTENTS

### HARDWARE BAG - PART# H



*8 x 45MM*  
**PART#: 1**  
**BOLT**  
6 PC(S)

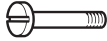

*8 x 40MM*  
**PART#: 2**  
**BOLT**  
4 PC(S)



*8MM*  
**PART#: 3**  
**WASHER**  
10 PC(S)



*8MM*  
**PART#: 4**  
**SPRING WASHER**  
10PC(S)



*8MM*  
**PART#: 5**  
**NUT**  
10 PC(S)



*15MM*  
**PART#: 6**  
**WASHER (FOR WHEEL)**  
2 PC(S)



**PART#: 7**  
**COTTER PIN**  
2 PC(S)



**PART#: 8**  
**PLASTIC SPACER**  
2 PC(S)

## TOOLS REQUIRED



**SMALL**  
**WRENCH**



**FLATHEAD**  
**SCREWDRIVER**

# OVERVIEW (PRODUCT INFORMATION)

## OVERVIEW (PRODUCT INFORMATION)

**FRONT VIEW**

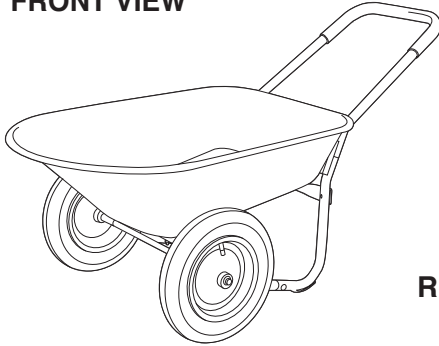

**HANDLE**

**REAR VIEW**

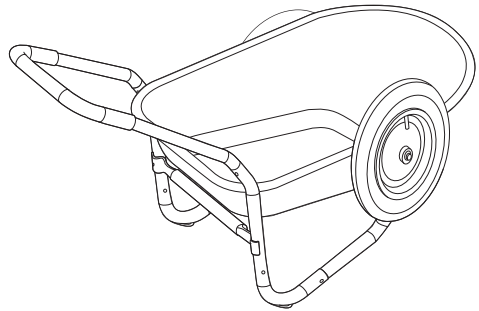

## SPECIFICATIONS

<b>MODEL</b>	<b>81021</b>
<b>PRODUCT DIMENSION</b>	<b>26 INCH x 57 INCH x 26 INCH</b>
<b>TRAY CAPACITY</b>	<b>5 CUBIC FEET</b>
<b>TRAY MATERIAL</b>	<b>METAL (0.9mm THICK)</b>
<b>TRAY DIMENSION</b>	<b>35.5 INCH x 25.2 INCH x 9 INCH</b>
<b>TIRE SIZE</b>	<b>16 INCH</b>
<b>TIRE TYPE</b>	<b>FLAT-FREE TIRE</b>
<b>WEIGHT CAPACITY</b>	<b>440 LB(S)</b>



# ASSEMBLY

## ASSEMBLY INSTRUCTION

### STEP 1

Attach PART# A to PART# B.

Secure with PART# 2 , PART# 3, PART# 4 , and PART# 5 .

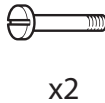
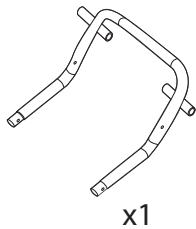
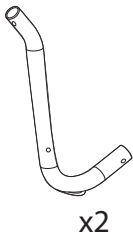
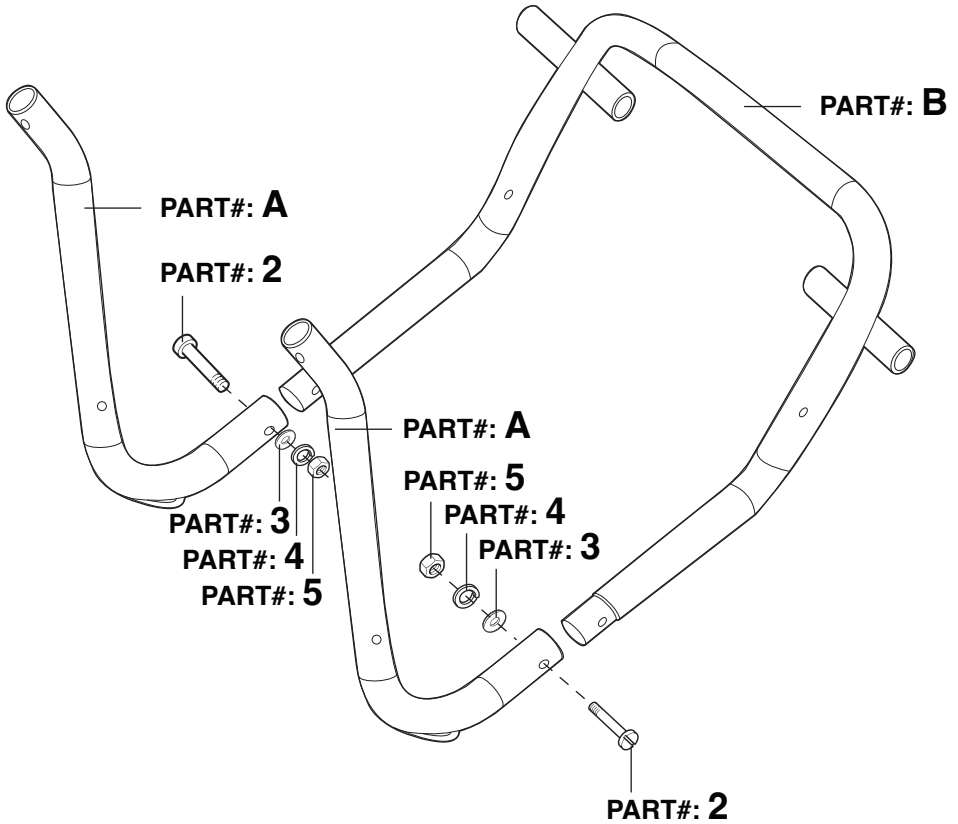

# ASSEMBLY

## STEP 2

Attach PART# C.

Secure with PART# 2 , PART# 3, PART# 4 , and PART# 5 .

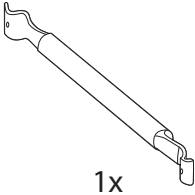
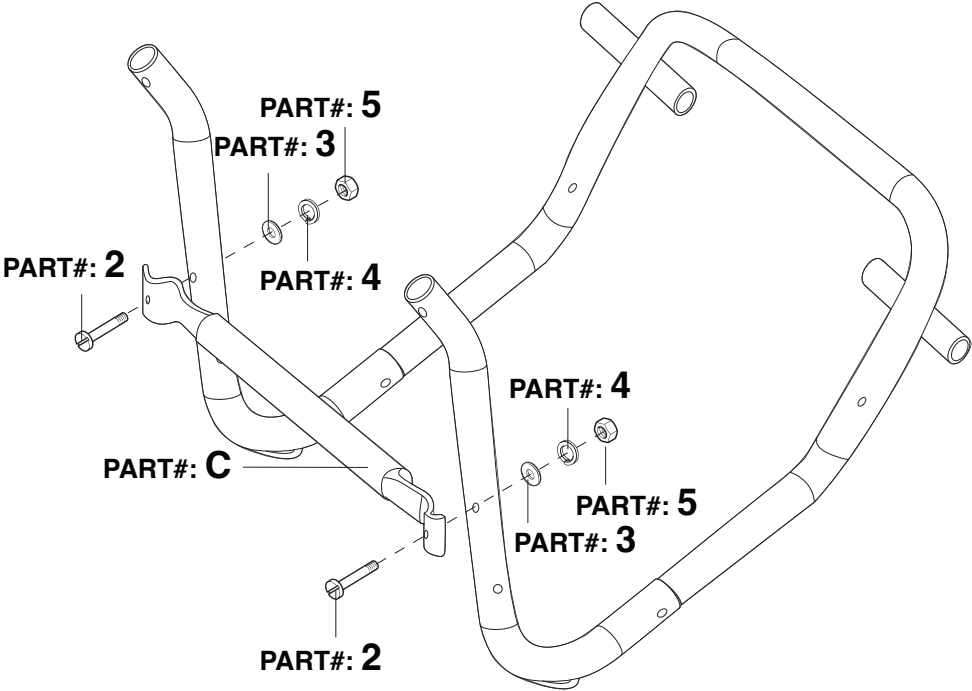

1x

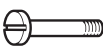

2x



2x



2x



2x

# ASSEMBLY

## STEP 3

Insert PART# D.

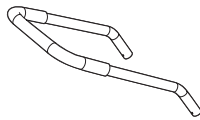
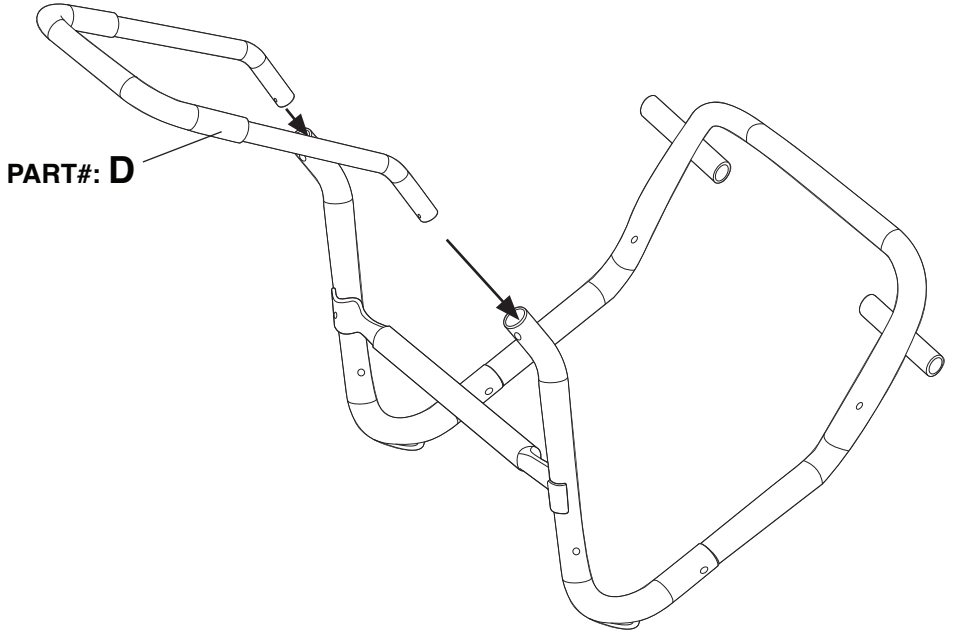

x1

# ASSEMBLY

## STEP 4

Attach PART# F to *HANDLE FRAME*, and place PART# 8 between PART# F and *HANDLE FRAME*.

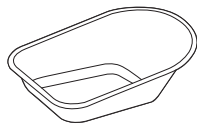
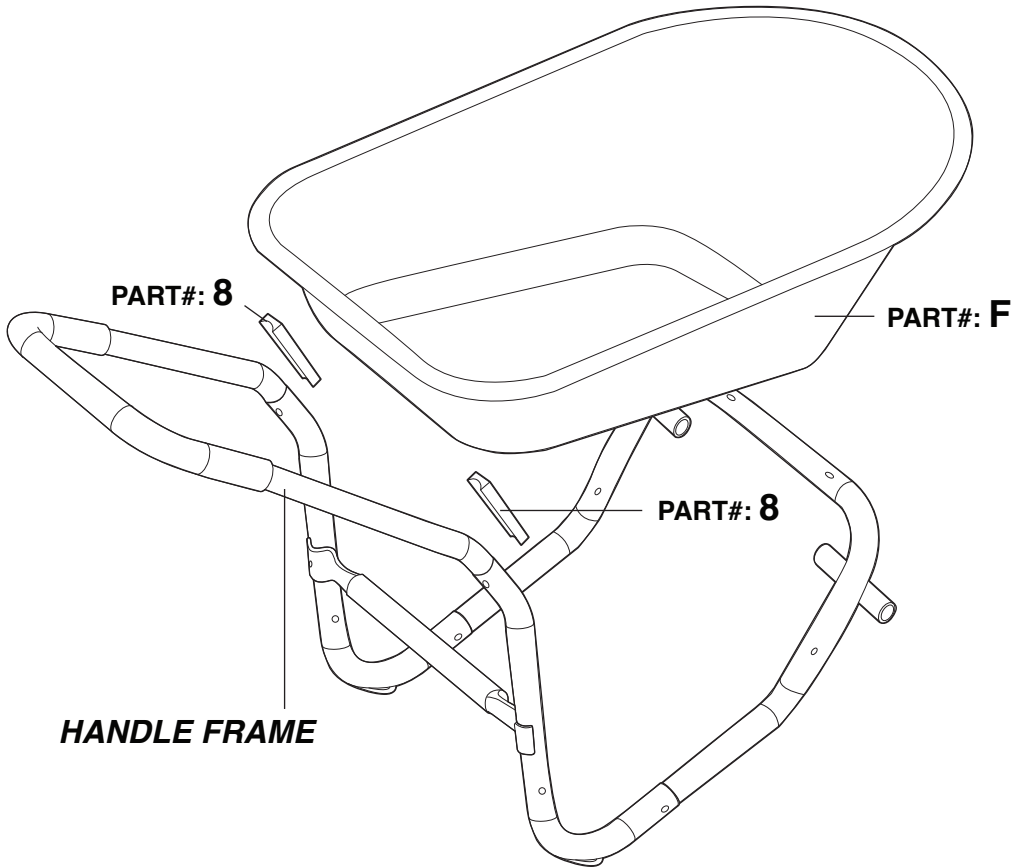

x1



x2

# ASSEMBLY

## STEP 5

Secure PART# F, PART# 8, and *HANDLE FRAME* with PART# 1, PART# 3, PART# 4, and PART# 5.

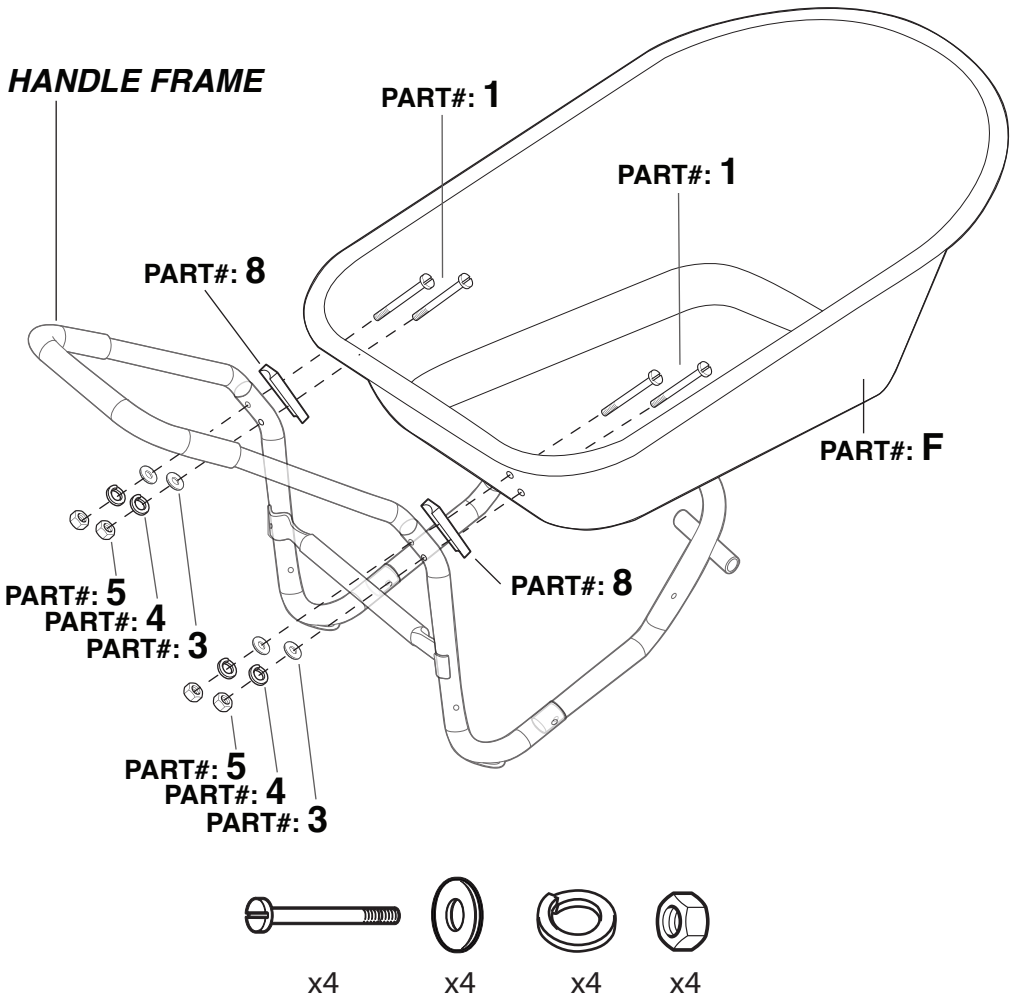

# ASSEMBLY

## STEP 6

Secure PART# F and *HANDLE FRAME* with PART# 1, PART# 3, PART# 4, and PART# 5.

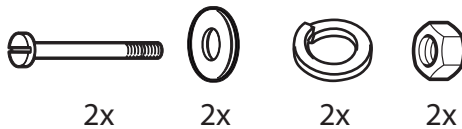
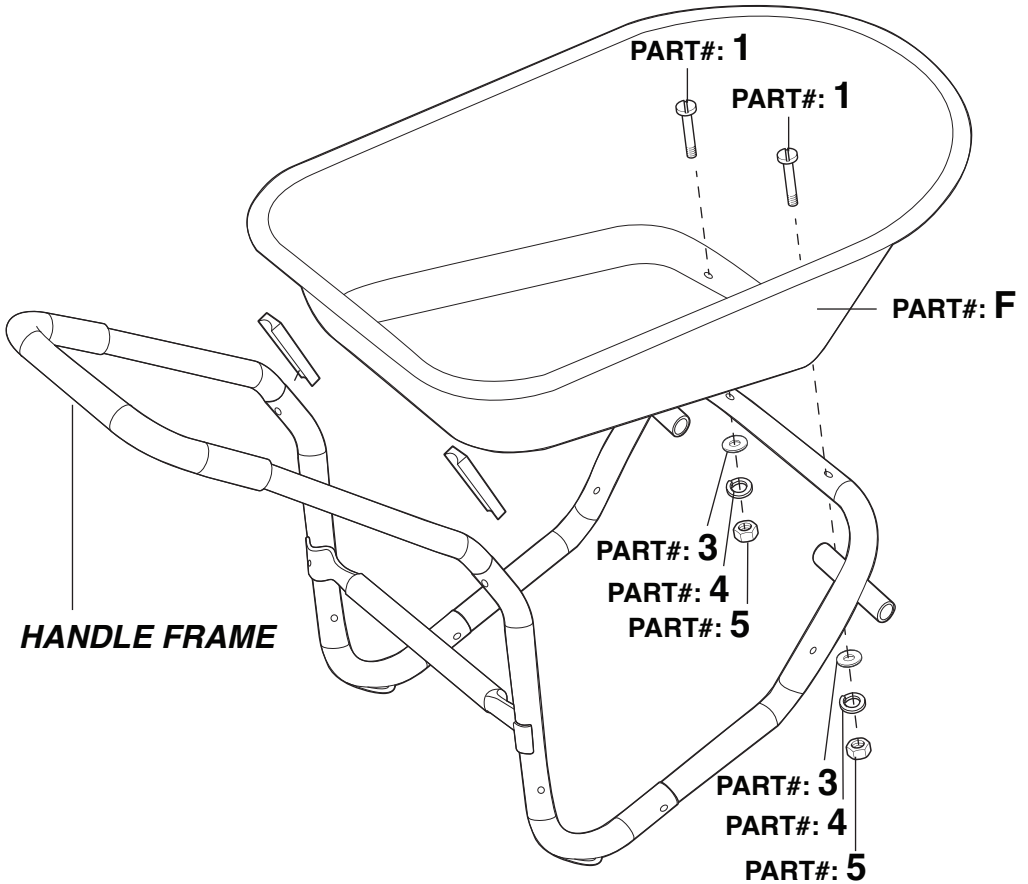

# ASSEMBLY

## STEP 7

Slide PART# E through the *AXLE SOCKET* on *HANDLE FRAME*.

Attach PART# G to PART# E, secure with PART# 6 and PART# 7, and bend the pin of PART# 7 to firmly lock PART# H in place.

Repeat the same process on the other end of PART# E.

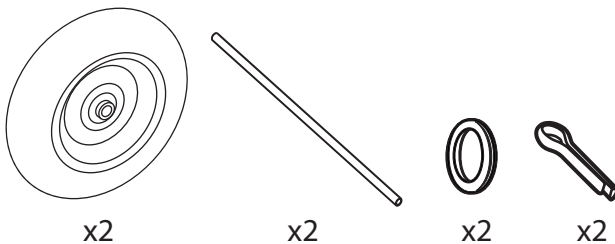
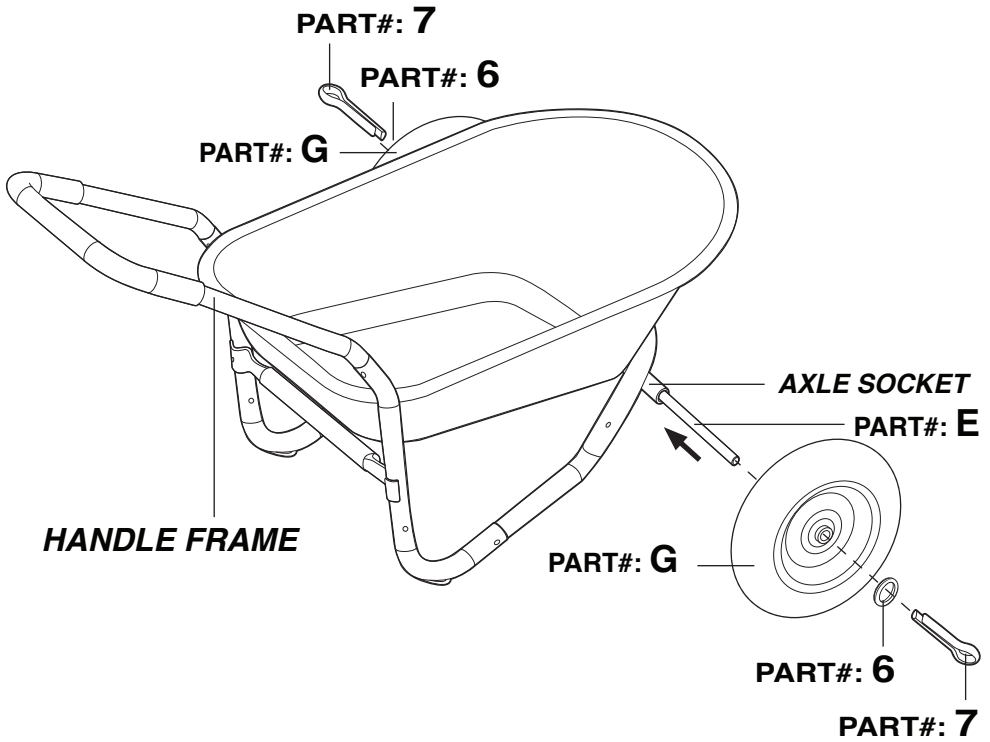

IMPORTANT SAFETY INSTRUCTIONS



# REPLACEMENT PARTS

## REPLACEMENT PARTS PARTS DIAGRAM



PART#: 1, 3, 4, 5



PART#: 2, 3, 4, 5



PART#: 6, 7

### PART# A - G

PART#	DESCRIPTION	QTY
A	BACK FRAME	2
B	FRONT FRAME	1
C	CENTER SUPPORT	1
D	HANDLE	1
E	AXLE	1
F	TRAY	1
G	WHEEL	2

### PART# H - HARDWARE BAG

PART#	DESCRIPTION	QTY
1	BOLT 8 x 65 mm	6
2	BOLT 8 x 45 mm	4
3	WASHER 8 mm	10
4	SPRING WASHER 8 mm	10
5	NUT 8 mm	10
6	AXLE WASHER	2
7	COTTER PIN	2
8	PLASTIC SPACER	2

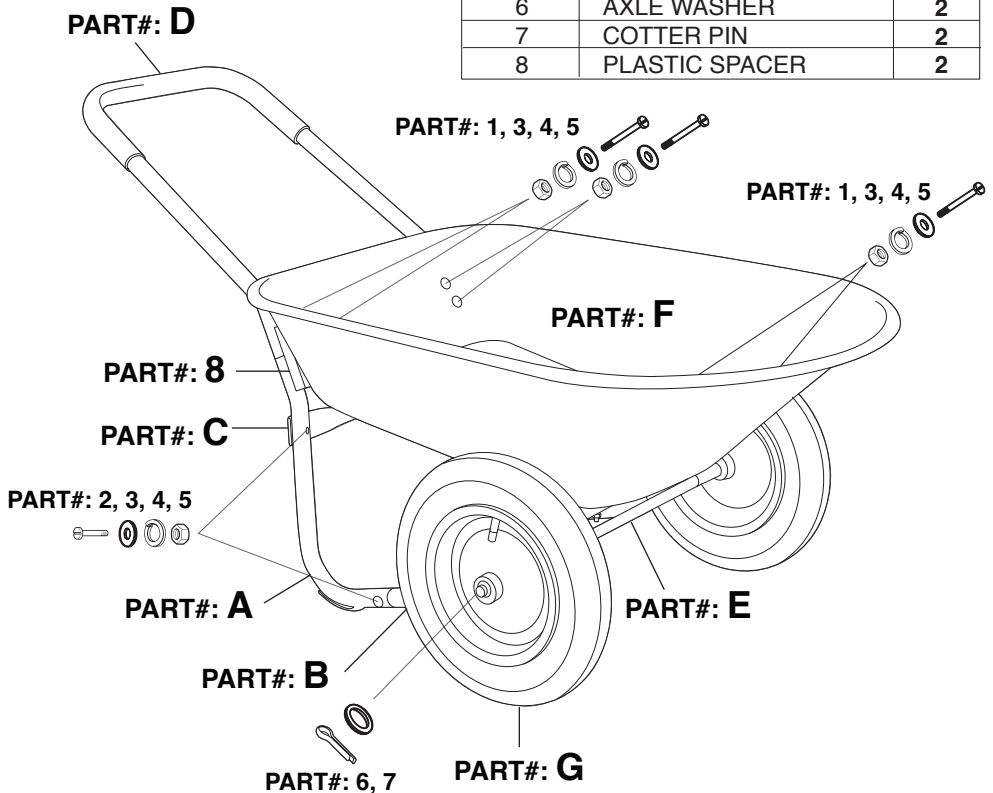

# DISCLAIMER

## DISCLAIMER

### ***PLEASE READ THE FOLLOWING CAREFULLY***

---

The manufacturer and/or distributor have provided the parts list and assembly diagram in this manual for reference purposes only. They do not make any representation or warranty to the buyer that they are qualified to make repairs to the product or replace any parts of the product. In fact, the manufacturer and/or distributor expressly state that all repairs and parts replacements should be undertaken by certified and licensed technicians, and not by the buyer.

The buyer assumes all risk and liability arising from their repairs to the original product or replacement parts or arising from their installation of replacement parts. It is strongly advised that qualified professionals handle any repairs or replacements to ensure safety and proper functioning of the product. Improper installation and operation may result in injury, property damage, or voiding of warranty. The manufacturer and/or distributor shall not be held responsible for any accidents, damages, or malfunctions resulting from the buyer's installation and operation of the product. It is essential to follow all safety guidelines and recommendations provided in this manual and to seek professional assistance if unsure about the installation or operation procedures.

---

## CUSTOMER SERVICE

If you have any questions about ordering our pool pumps and replacement parts or pool products, please feel free to contact us using the following contact information:

### ***Customer Service and Technical Support***

**Phone:** (909) 628-0880

**Email:** [customer@xtremepowerusa.com](mailto:customer@xtremepowerusa.com)

**Hours of Operation:** Monday – Friday, 9AM – 4PM (CST)

---