

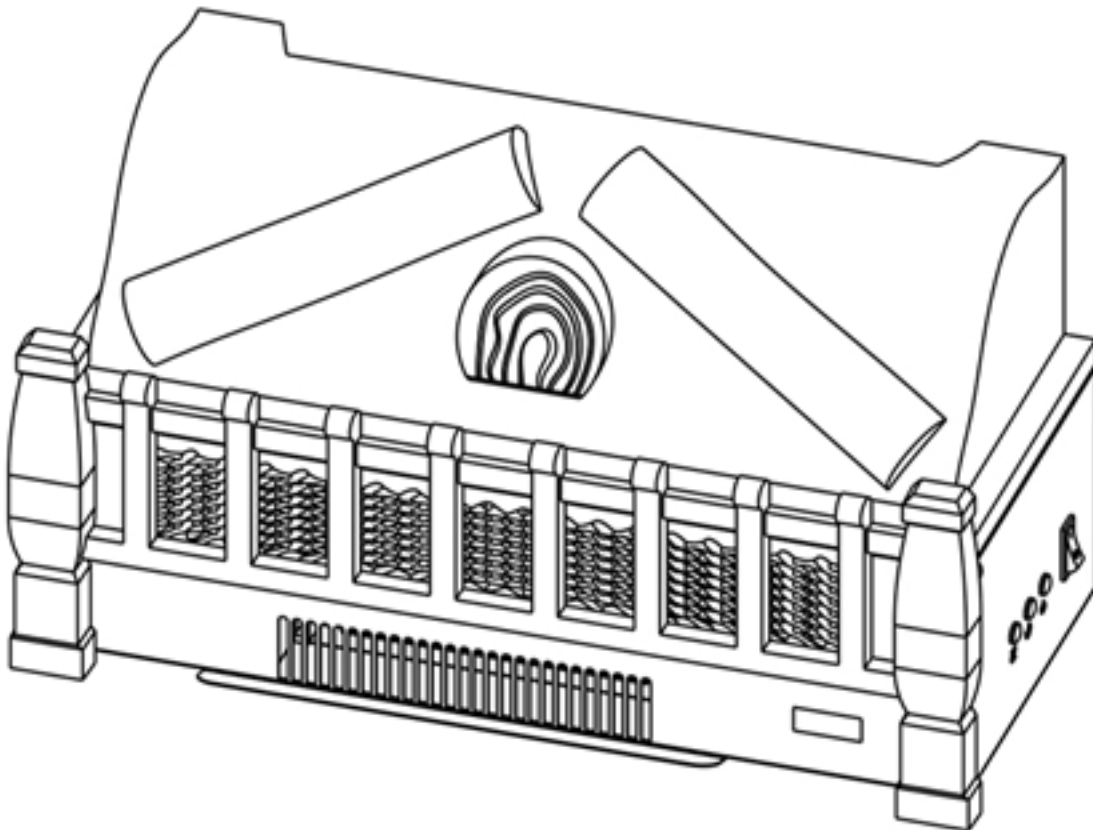

FIREPLACE INSERT LOG ELECTRIC 750W/1500W

ITEM # 95183



OWNER'S MANUAL AND SAFETY INSTRUCTIONS

SAVE THIS MANUAL. KEEP THIS MANUAL FOR SAFETY WARNINGS, PRECAUTIONS, ASSEMBLY, OPERATION, INSPECTION, MAINTENANCE AND CLEANING PROCEDURES. WRITE THE PRODUCT'S SERIAL NUMBER ON THE BACK OF THE MANUAL, OR THE MONTH AND YEAR OF PURCHASE IF PRODUCT HAS NO SERIAL NUMBER

FOR QUESTIONS, PLEASE CALL CUSTOMER SERVICE: 909.628.4900

SAFETY INFORMATION

WARNING

Read all safety warnings and instructions. Failure to follow the warnings and instructions may result in injury and/or property damage. Save all warnings and instructions for future reference.

The warnings, precautions, and instructions discussed in this instruction manual cannot cover all possible conditions and situations that may occur. It must be understood by the operator that common sense and caution are factors which cannot be built into this product, but must be supplied by the operator.

- **DO NOT STORE OR USE GASOLINE OR OTHER FLAMMABLE VAPORS OR LIQUIDS IN THE VICINITY OF THIS OR ANY OTHER APPLIANCE.**

- This appliance comes equipped with an overheat protection safety device. Should the appliance begin to overheat for any reason, it will automatically turn all heater functions of the appliance off. The appliance will have to be reset prior to continuing use. To reset the overheat protection safety device, turn all controls off and unplug the appliance. Wait 10 minutes, plug the appliance back in and turn on.
- It is normal for the power cord to feel warm to the touch; however, a loose fit between the outlet and the plug may cause overheating of the plug. If this occurs, try inserting the plug into a different outlet. Contact a qualified electrician to inspect the original outlet for damage.

1) Read all instructions before using this heater.

2) This heater is hot when in use. To avoid burns, do not let bare skin touch hot surfaces. If provided, use handles when moving this heater. Keep combustible materials, such as furniture, pillows, bedding, papers, clothes, and curtains at least 3 feet (0.9 m) from the front of the heater and keep them away from the sides and rear.

3) Extreme caution is necessary when any heater is used by or near children or invalids and whenever the heater is left operating and unattended.

4) Always unplug heater when not in use.

5) Do not operate any heater with a damaged cord or plug or after the heater malfunctions, has been dropped or damaged in any manner. Discard heater, or return to authorized service facility for examination and/or repair.

6) Do not use outdoors.

7) This heater is not intended for use in bathrooms, laundry areas and similar indoor locations. Never locate heater where it may fall into a bathtub or other water container.

8) Do not run cord under carpeting. Do not cover cord with throw rugs, runners, or similar coverings. Do not route cord under furniture or appliances. Arrange cord away from traffic area and where it will not be tripped over.

9) To disconnect heater, turn controls to off, then remove plug from outlet.

10) Do not insert or allow foreign objects to enter any ventilation or exhaust opening as this may cause an electric shock or fire, or damage the heater.

11) To prevent a possible fire, do not block air intakes or exhaust in any manner. Do not use on soft surfaces, like a bed, where openings may become blocked.

12) Do not use it in areas where gasoline, paint, or flammable liquids are used or stored.

13) Use this heater only as described in this manual. Any other use not recommended by the manufacturer may cause fire, electric shock, or injury to persons.

14) Always plug heaters directly into a wall outlet/receptacle. Never use with an extension cord or relocatable power tap (outlet/power strip).

CAUTION: This appliance has a polarized plug (one blade is wider than the other). To reduce the risk of shock, this plug is intended to fit only one way in a polarized outlet. If the plug does not fit fully in the outlet, reverse the plug. If it still does not fit, contact a qualified electrician. DO NOT attempt to defeat this safety feature.

SAFETY INFORMATION

ZONE HEATING SAVES! The concept of Zone Heating is simple. Use High Efficiency heaters to heat the rooms you use most, during the times you use these areas and turn back the thermostat to your central heating system. To achieve the maximum benefit it is important to understand your heater and where best to locate it.

Please follow these suggestions:

1. Close doors to areas you do not wish to heat.
2. Locate an outlet along an interior wall if possible. Position the heater so that the warm air can blow unobstructed across the room towards the exterior walls.
3. Check your windows and doors for the infiltration of cold air and insulate as needed to avoid heat loss. Rapid heat loss will minimize the effectiveness of your heater as it would any conventional type heater.
4. Keep the area around the heater free of obstructions to insure maximum airflow. Keep electrical cords, drapery, furniture, and other combustibles 3 feet (0.9 M) away from the front of the heater and away from the sides.
5. Avoid locating your heater in high traffic areas or in direct sunlight.
6. Avoid locating your heater near your central heating thermostat.

WARNING: Before servicing this heater be sure to unplug heater from wall outlet. Do not only turn off heater from the main “ON/OFF” switch, be sure to unplug this heater.

ELECTRICAL CONNECTION

AC120Volt, 60Hz circuit with a properly grounded outlet is required. Preferably, the heater will be on a dedicated circuit. Other appliances on the same circuit may cause the circuit breaker to trip or the fuse to blow when the heater is in operation. The unit comes standard with a two wire cord exiting from the rear of the appliance.

WARNING: Electrical outlet wiring must comply with local building codes and all other applicable regulations to reduce the risk of fire, electrical shock and injury.

WARNING: Do not use this appliance if any part of it has been under water. Immediately call a qualified service technician to inspect the appliance and replace any part of the electrical system if necessary.

SAVE THESE WARNINGS.

PRODUCT INFORMATION

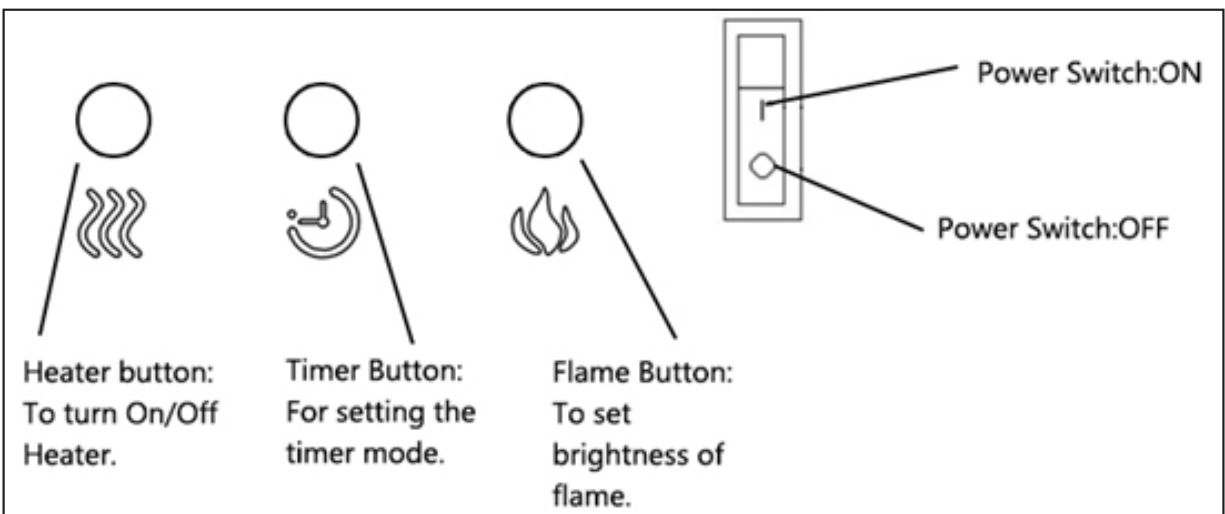
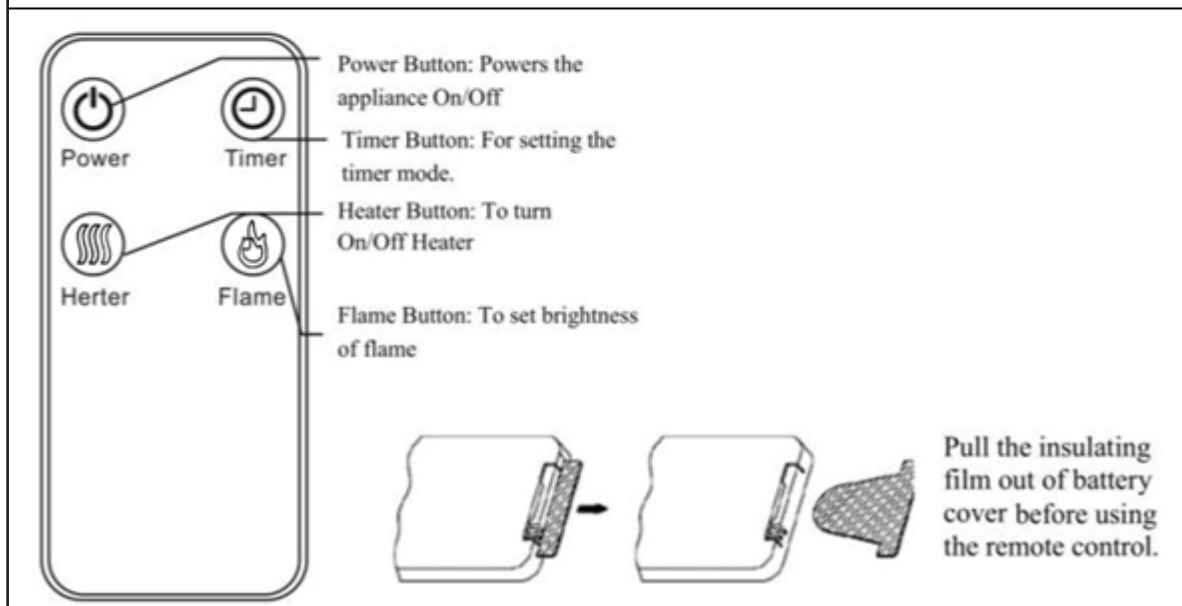
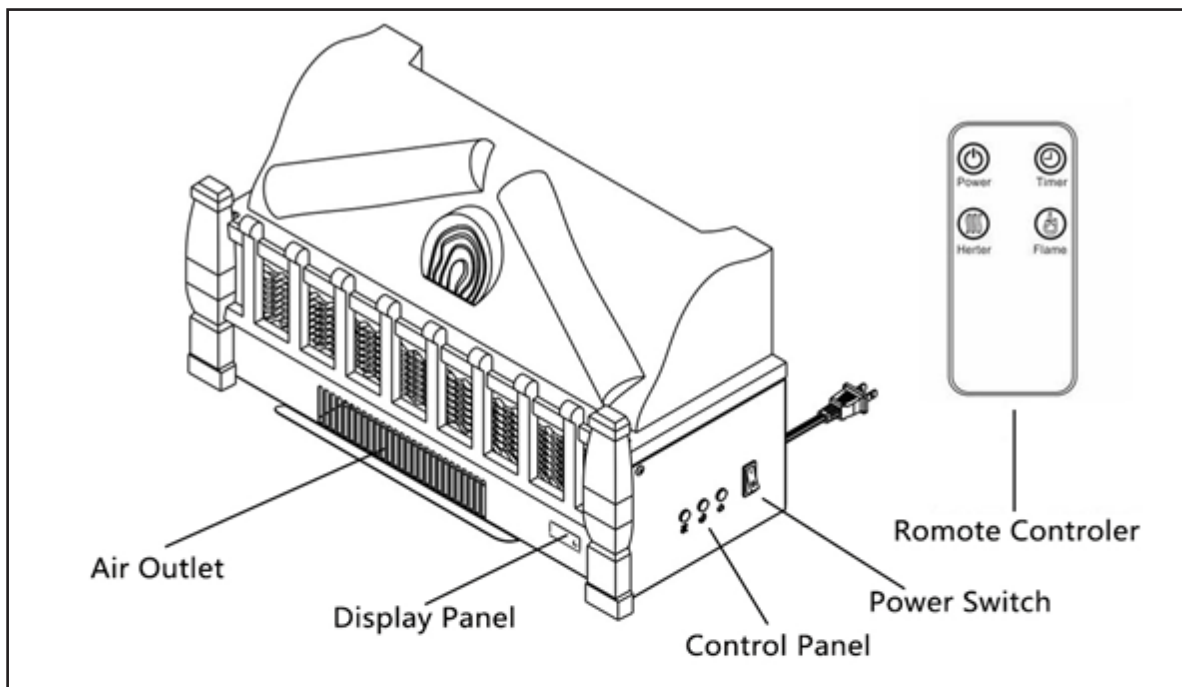

OPERATION / MAINTENANCE

First turn on the Power switch on the right side of the heater. You will hear a beep indicating power is supplied to unit. The Power switch supplies power to all the function of the appliance. This switch must be in “I” position for any functions including the remote control to work.



Press the Power button on the remote control, the heat and flame effect will be on. Press the Power button again, heat and flame effect will be off. The fan will continue running for 60 seconds to disperse remaining heat from inside.



Press the Timer button to set timer-power-off function through control panel. Press the Timer button to increase duration from 1h-2h-3h-4h-5h.....24h. The display panel will show 01-02-03-04-05...24.



Press the Timer button to set timer-power-off function through remote controller. Press the Timer button to increase duration from 1h-2h-3h-4h-5h.....24h. The display panel will show 01-02-03-04-05....24.



Press the Heater button on the control panel, the heater will start, it is High heating mode, The display panel show OH, press it once again, it is Low heating model, The display panel show OL, press the button the third time, the heater will be off, the fan will continue running for 60 seconds to disperse remaining heat from inside.



Press the Heater button on the remote controller, the heater will start, it is High heating mode, The display panel show OH, press it once again, it is Low heating model, The display panel show OL, press the button the third time, the heater will be off, the fan will continue running for 60 seconds to disperse remaining heat from inside.



(I)Set on control panel, under standby, Press Flame button on control panel, the flame will be on at brightest. The charcoal set will be lit up and flicker automatically. Each time this button is pressed, the intensity of the flame decreases. There are five brightness levels you can cycle through including the OFF setting.



(II)Set on remote controller, press the power button, the flame will be on at brightest automatically. Then to press Flame button to adjust the flame brightness with 5 levels. The Flame can be used independently. When pressed, the display panel show 01,02,03,04,05 level

TROUBLESHOOTING

PROBLEM	POSSIBLE CAUSE	SOLUTION
No warm air is coming from the the appliance	The overheat protection device in the appliance has been triggered	Turn all controls off, unplug the appliance and allow it to cool off before plugging it back in
Appliance turns off and won't turn back on	The overheat protection device on the appliance has been triggered	Turn all controls off, unplug the appliance and allow it to cool off before plugging it back in

OPERATION

ALWAYS OBSERVE THESE SAFETY PRECAUTIONS WHEN OPERATING YOUR ELECTRIC HEATER

ALWAYS Read all instructions before operating.

ALWAYS Locate your electric heater away from furniture or loose hanging drapes.

ALWAYS Keep the rear grill away from walls or drapes so as not to block the air intake. (If applicable)

ALWAYS Unplug electric heater when not in use.

ALWAYS Use electric heater on a flat dry surface.

ALWAYS Use on 120 volt 60Hz AC power supply.

ALWAYS Route the cord so it will not be walked on, tripped over or pinched by furniture.

ALWAYS Keep electrical cords, drapes and other furnishings away from your electric heater.

ALWAYS Keep your electric heater clean and the filter free of dust. (If applicable)

ALWAYS Use indoors only.

NEVER Place drapes, clothing or towels over electric heater to dry.

NEVER Use in the presence of explosive or flammable vapors such as gas or paint.

NEVER Plug another electrical appliance into the same circuit. Blown fuses, tripped circuits and fire hazards may result.

NEVER Use water or liquids to clean your electric heater.

NEVER Let bare skin touch hot surfaces as this may cause burns.

NEVER Leave electric heater unattended.

NEVER Leave electric heater unattended when children or pets are present.

NEVER Locate electric heater where it may fall into a bath tub or other water containers.

NEVER Operate electric heater with a damaged cord, plug or after the heater malfunctions, or has been dropped or damaged in any manner.

NEVER Run cord under carpeting or cover with throw rugs or runners.

NEVER Insert or allow foreign objects to enter any ventilation or exhaust openings, as this may cause an electrical shock, fire or damage.

DISCLAIMER

PLEASE READ THE FOLLOWING CAREFULLY

THE MANUFACTURER AND/OR DISTRIBUTOR HAS PROVIDED THE PARTS LIST AND ASSEMBLY DIAGRAM IN THIS MANUAL AS A REFERENCE TOOL ONLY. NEITHER THE MANUFACTURER OR DISTRIBUTOR MAKES ANY REPRESENTATION OR WARRANTY OF ANY KIND TO THE BUYER THAT HE OR SHE IS QUALIFIED TO MAKE ANY REPAIRS TO THE PRODUCT, OR THAT HE OR SHE IS QUALIFIED TO REPLACE ANY PARTS OF THE PRODUCT. IN FACT, THE MANUFACTURER AND/OR DISTRIBUTOR EXPRESSLY STATES THAT ALL REPAIRS AND PARTS REPLACEMENTS SHOULD BE UNDERTAKEN BY CERTIFIED AND LICENSED TECHNICIANS, AND NOT BY THE BUYER. THE BUYER ASSUMES ALL RISK AND LIABILITY ARISING OUT OF HIS OR HER REPAIRS TO THE ORIGINAL PRODUCT OR REPLACEMENT PARTS THERETO, OR ARISING OUT OF HIS OR HER INSTALLATION OF REPLACEMENT PARTS THERETO.

Record Product's Serial Number Here: _____

Note: If product has no serial number, record month and year of purchase instead.

Note: Some parts are listed and shown for illustration purposes only and are not available individually as replacement parts.

Questions, issues or missing parts?

Before returning to your retailer, our customer service team is here to help.



Call Us: 909.628.0880

Email Us: customer@bartonliving.com

Hours of Operation: 9am - 3pm PST Monday - Friday

MADE IN CHINA