

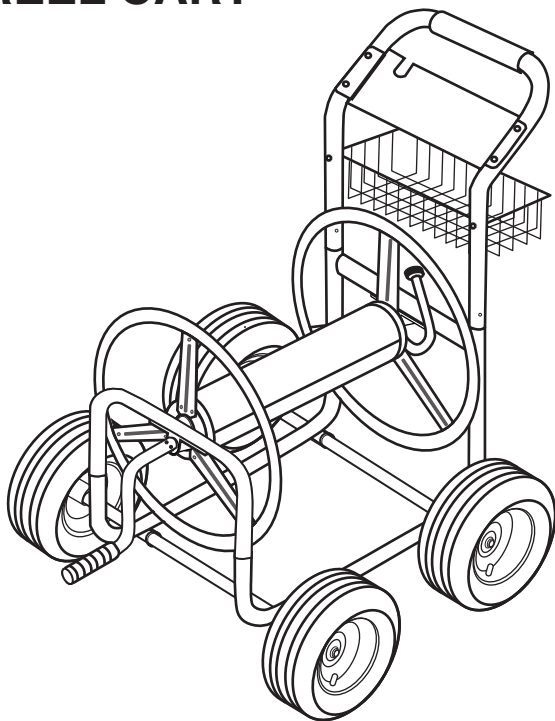

## HOSE REEL CART

SKU: 96033



## ASSEMBLY AND USER'S GUIDE



**Read all safety warnings and instructions. Failure to follow the warnings and instructions may result in serious injury. Save all warnings and instructions for future reference.**

96033



**THIS PAGE INTENTIONALLY LEFT BLANK**

# TABLE OF CONTENT

<b>IMPORTANT SAFETY INSTRUCTIONS .....</b>	<b>1</b>
<i>Legends and Symbols .....</i>	<i>2</i>
<b>GENERAL SAFETY INFORMATION .....</b>	<b>3</b>
<b>PRODUCT INFORMATION .....</b>	<b>4</b>
OVERVIEW .....	4-5
INTRODUCTION .....	6
SPECIFICATION .....	6
<b>ASSEMBLY INSTRUCTIONS .....</b>	<b>7</b>
STEP 1 .....	7
STEP 2 .....	8
STEP 3 .....	9
STEP 4 .....	10
STEP 5 .....	11
STEP 6 .....	12
<b>REPLACEMENT PARTS .....</b>	<b>13</b>
PARTS DIAGRAM & PARTS LIST .....	13
PARTS DIAGRAM & PARTS LIST .....	14
<b>DISCLAIMER .....</b>	<b>15</b>
<i>Disclaimer .....</i>	<i>15</i>
<i>Customer Service .....</i>	<i>15</i>

---

## CUSTOMER SERVICE

If you have any questions about ordering our pool pumps and replacement parts or other products, please feel free to contact us using the following contact information:

### ***Customer Service and Technical Support***

**Phone:** (909) 628-0880

**Email:** [customer@xtremepowerusa.com](mailto:customer@xtremepowerusa.com)

**Hours of Operation:** Monday – Friday, 9AM – 4PM (CST)

---

# IMPORTANT SAFETY INSTRUCTIONS

## IMPORTANT SAFETY INSTRUCTIONS

This guide provides instructions for installing and using the Hose Reel Cart. If you have any questions about the equipment, please contact XtremepowerUS.

This guide contains important information about safely installing and operating this product. After installation, make sure to share this information with the owner/operator or leave it with them for their reference.

### *Legends and Symbols*

When you come across the safety-alert symbol on your equipment or in this manual, pay attention to the following signal words and remain vigilant about the potential for personal injury.

**⚠ DANGER** **DANGER:** Ignoring these hazards can result in death, severe personal injury, or significant property damage.

**⚠ WARNING** **WARNING:** Indicates potential hazards that can result in severe personal injury, death, or significant property damage. Ignoring these warnings presents a real danger.

**⚠ CAUTION** **CAUTION:** Indicates potential hazards that can result in minor or moderate personal injury, property damage, or actions that are unpredictable and unsafe. Ignoring these cautions presents a potential hazard.

**★ NOTE** **NOTICE:** This label indicates important special instructions that are not directly related to hazards.

---

### USE OF NON-XTREMEPOWERUS REPLACEMENT PARTS VOIDS WARRANTY

**ATTENTION INSTALLER:** This manual contains vital information regarding the installation, operation, and safe use of this product. It is essential to provide this manual to the end user of the product. Failure to read and follow all instructions could lead to severe injuries.

---

**⚠ DANGER** Failure to comply with all instructions and warnings may lead to severe bodily injury or even death. For optimal safety and functionality, it is advisable to have the product installed and serviced by a certified service professional. Prior to using this product, installers, operators, and owners must carefully review these warnings and all instructions provided in the owner's manual. It is essential to leave these warnings and the owner's manual with the owner for their reference and safety.

**⚠ WARNING** For safety reasons, children should not be allowed to use this product. Packing materials and plastic bags are not toys. Keep them away from children to prevent the risk of suffocation.

# IMPORTANT SAFETY INSTRUCTIONS

## GENERAL SAFETY INFORMATION

### ⚠ DANGER

- **Assembly Safety:** Failure to securely fasten all parts during assembly can result in the cart collapsing during use, leading to severe injuries.
- **Weight Capacity:** Exceeding the maximum weight capacity can cause the cart to tip over or collapse, posing a risk of serious injury or damage to property.
- **Hose Pressure:** Never wind or unwind the hose while it is under high water pressure. This can cause sudden release or equipment failure, leading to injuries.
- **No Passengers:** Never allow children or others to ride in or on the equipment.
- **Usage Restrictions:** This item is not to be used as a step ladder or for any purpose other than its intended function
- **Proper Use:** Follow the manufacturer's instructions for proper use.



### ⚠ WARNING

- **Proper Usage:** Do not use the cart on steep inclines or uneven surfaces to avoid tipping, which may cause moderate injury or equipment damage.
- **Children and Pets:** Keep the cart out of reach of children and pets. Misuse of the cart could result in injuries.
- **Weather Considerations:** Exposure to extreme weather (e.g., prolonged rain, direct sunlight, or snow) can weaken the cart, leading to unexpected failures during use.
- **Hose Storage:** Leaving the hose under tension when not in use can damage the reel mechanism, leading to malfunction or hazards during operation.

### ⚠ CAUTION

- **Moving the Cart:** Ensure the hose is wound securely before moving the cart. Improperly secured hoses can create tripping hazards or cause the cart to become unbalanced.
- **Stability and Balance:** Position the cart on a flat surface and lock the wheels (if applicable) to prevent it from rolling unintentionally.
- **Inspection and Maintenance:** Regularly inspect bolts, screws, and fasteners for looseness. Failing to tighten them may cause the cart to malfunction during use.
- **Lifting Precautions:** Use proper lifting techniques when moving the cart manually. Improper lifting could lead to strain or minor injuries.
- **Frozen Hose:** Do not wind a frozen hose onto the reel. This may cause damage to both the hose and the reel mechanism.
- **Turning and Reversing:** Avoid sharp turns and exercise extra caution when turning or operating on challenging surfaces. Use care when reversing.
- **Stopping Distance:** Stopping distance increases with both speed and the weight of the towed load. Travel slowly and allow extra time and distance to stop safely.

### ★ NOTE

- **Assembly and Maintenance:** Firmly secure all bolts, screws, and knobs before use.
- **Pre-Use Inspection:** Reconfirm that all bolts, screws, and knobs are properly secured before every use. Conduct routine checks to ensure continued safety and reliability.
- **Instruction Retention:** Retain these instructions for future reference to ensure proper assembly, maintenance, and safe usage.

# OVERVIEW (PRODUCT INFORMATION)

## PACKAGE CONTENTS

### PARTS

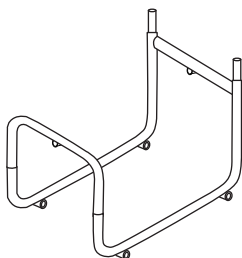

**P96033-1**  
**FRAME**  
1 PC(S)

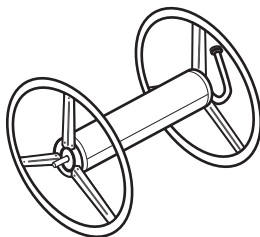

**P96033-4**  
**HOSE REEL**  
1 PC(S)



**P96033-7**  
**LEADER HOSE**  
1 PC(S)

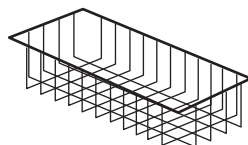

**P96033-8**  
**ACCESSORIES BASKET**  
1 PC(S)

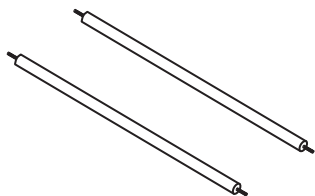

**P96033-2**  
**AXLES**  
2 PC(S)



**P96033-5**  
**CRANK HANDLE**  
1 PC(S)



**P96033-9**  
**HARDWARE BAG**  
1 PC(S)

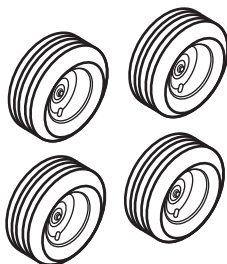

**P96033-3**  
**WHEELS**  
4 PC(S)

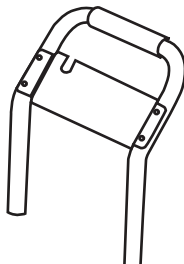

**P96033-6**  
**HANDLE**  
1 PC(S)



**INSTRUCTION**  
**MANUAL**

# OVERVIEW (PRODUCT INFORMATION)

## PACKAGE CONTENTS

### HARDWARE BAG - P96033-9



*6 x 33mm*  
**P96033-A**  
**BOLT**  
2 PC(S)



*8mm*  
**P96033-E**  
**NUT**  
2 PC(S)



*6mm*  
**P96033-I**  
**NUT**  
5 PC(S)



*6 x 39mm*  
**P96033-B**  
**BOLT**  
2 PC(S)



*8mm*  
**P96033-F**  
**WASHER**  
4 PC(S)



*6mm*  
**P96033-J**  
**WASHER**  
3 PC(S)



*6 x 30mm*  
**P96033-C**  
**BOLT**  
2 PC(S)



*12mm*  
**P96033-G**  
**NUT**  
4 PC(S)



*6mm*  
**P96033-K**  
**ACORN NUT**  
1 PC(S)



*8 x 45mm*  
**P96033-D**  
**BOLT**  
2 PC(S)



*12mm*  
**P96033-H**  
**WASHER**  
4 PC(S)



**P96033-L**  
**RUBBER WASHER**  
1 PC(S)

# OVERVIEW (PRODUCT INFORMATION)

## OVERVIEW (PRODUCT INFORMATION)

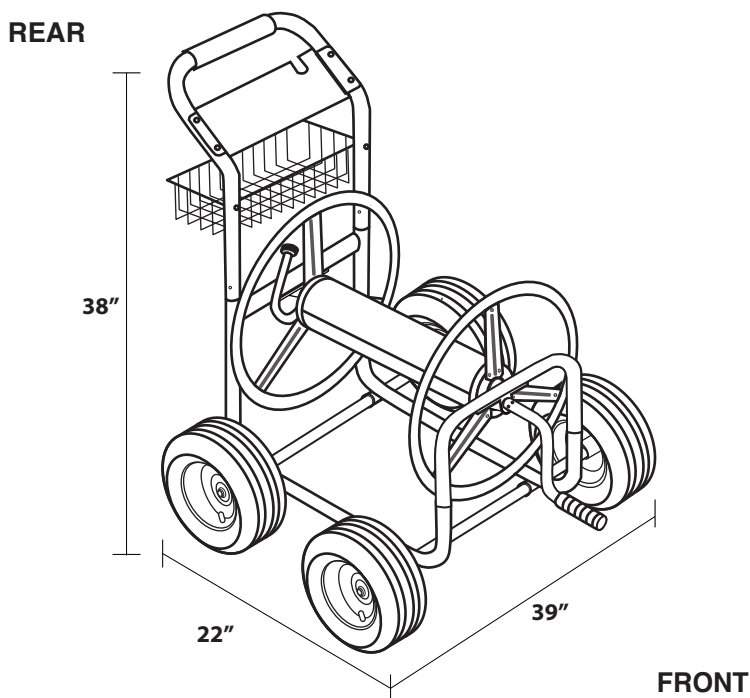

## INTRODUCTION

The XtremepowerUS Hose Reel Cart is a versatile tool designed to improve efficiency, safety, and convenience in hose management. By keeping hoses well-organized and easily transportable, this hose reel cart helps users minimize tripping hazards, prevent wear and tear on hoses, and reduce physical strain during watering or irrigation tasks.

## SPECIFICATIONS

MODEL	96033
PRODUCT DIMENSION	39 x 22 x 38 INCH
PRODUCT WEIGHT	37 LBS
COLOR	DARK GREY HAMMERTONE
WHEEL SIZE	10 X 3.50 - 4 INCH
WHEEL TYPE	PNEUMATIC



# ASSEMBLY

## ASSEMBLY INSTRUCTION

### STEP 1

Attach PART: P96033-1 to PART: P96033-2.

Secure by sliding each axle through the bottom holes.

**PART: P96033-1**

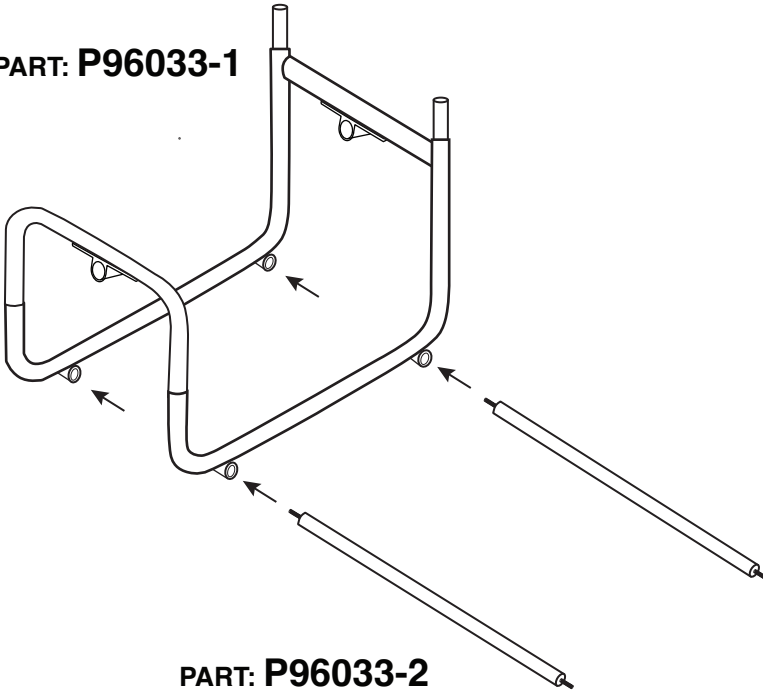

**PART: P96033-2**

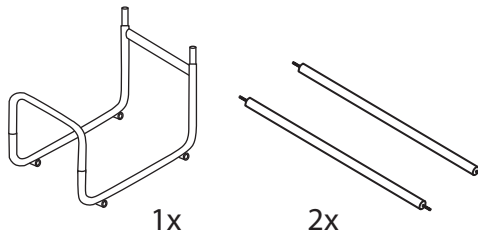

# ASSEMBLY

## STEP 2

Attach PART: P96033-3 to the end of each axles. Secure it using PART: P96033-G, and PART: P96033-H. Repeat the same process for the other three wheels.

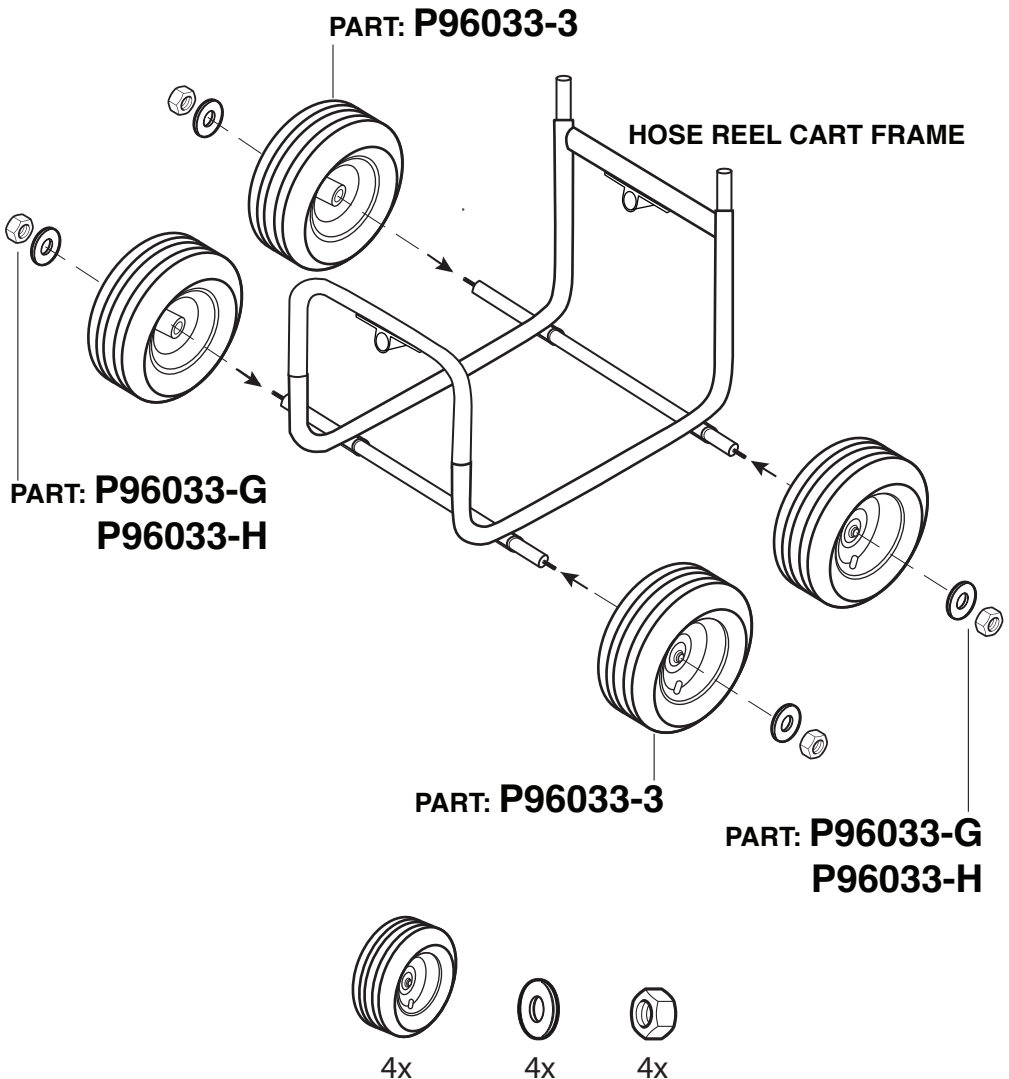

# ASSEMBLY

## STEP 3

Attach PART: P96033-4 to the HOSE REEL CART FRAME. Insert the end of the Crank Stem from PART: P96033-4 into the first mounting hole on the frame. Align the Crank Stem with both mounting holes to ensure proper positioning. Secure the crank stem in place using PART: P96033-A and PART: P96033-I.

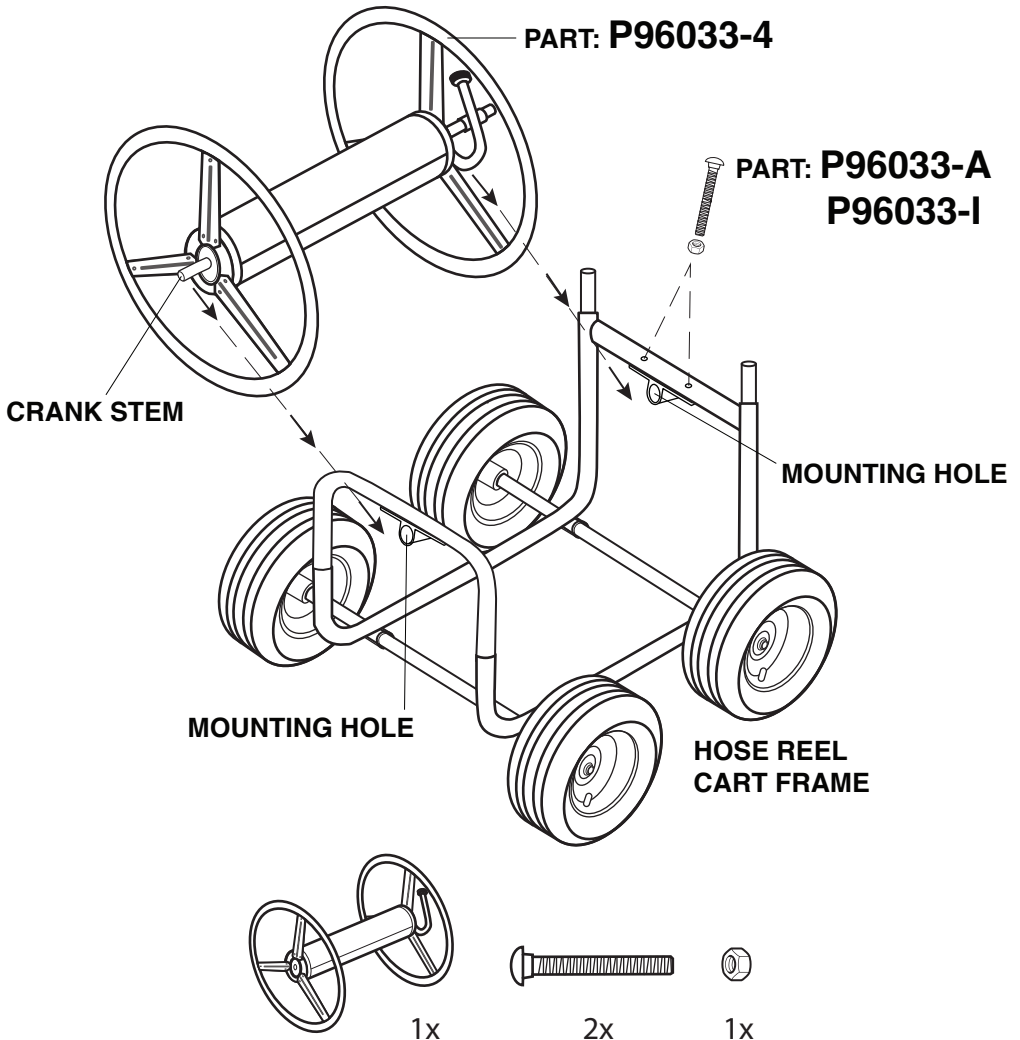

# ASSEMBLY

## STEP 4

Attach PART: P96033-5 to the Crank Stem.

Secure them using PART: P96033-C, PART: P96033-I and PART: P96033-K.

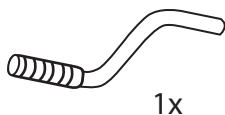
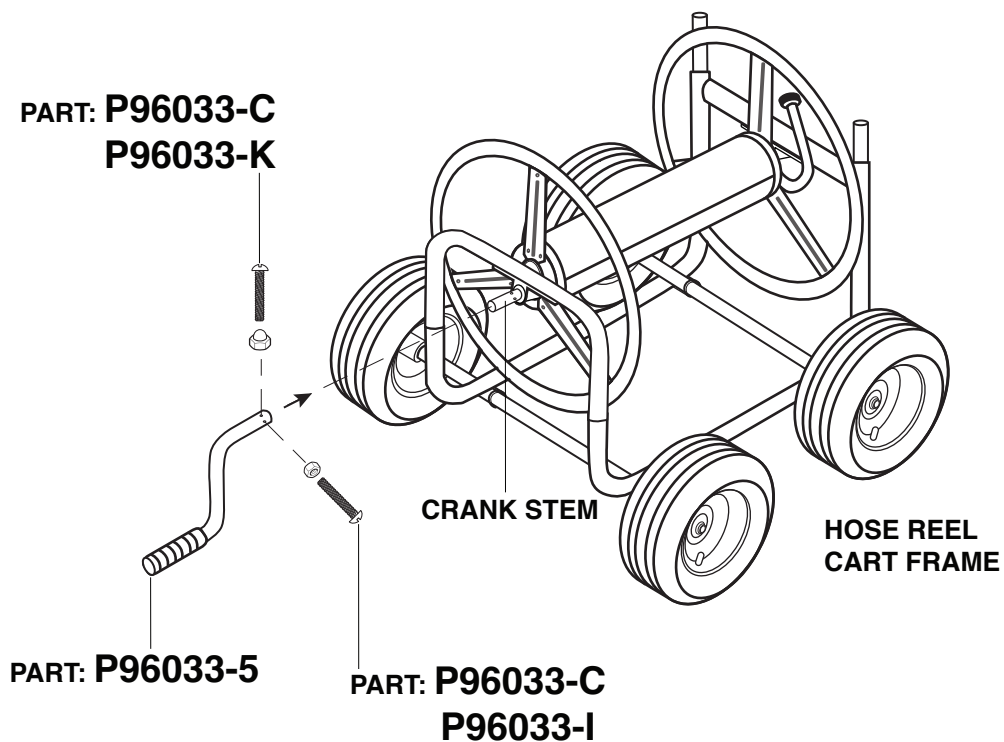

# ASSEMBLY

## STEP 5

Attach PART: P96033-6 to the HOSE REEL CART FRAME.

Secure it using PART: P96033-B, PART: P96033-I and PART: P96033-J.

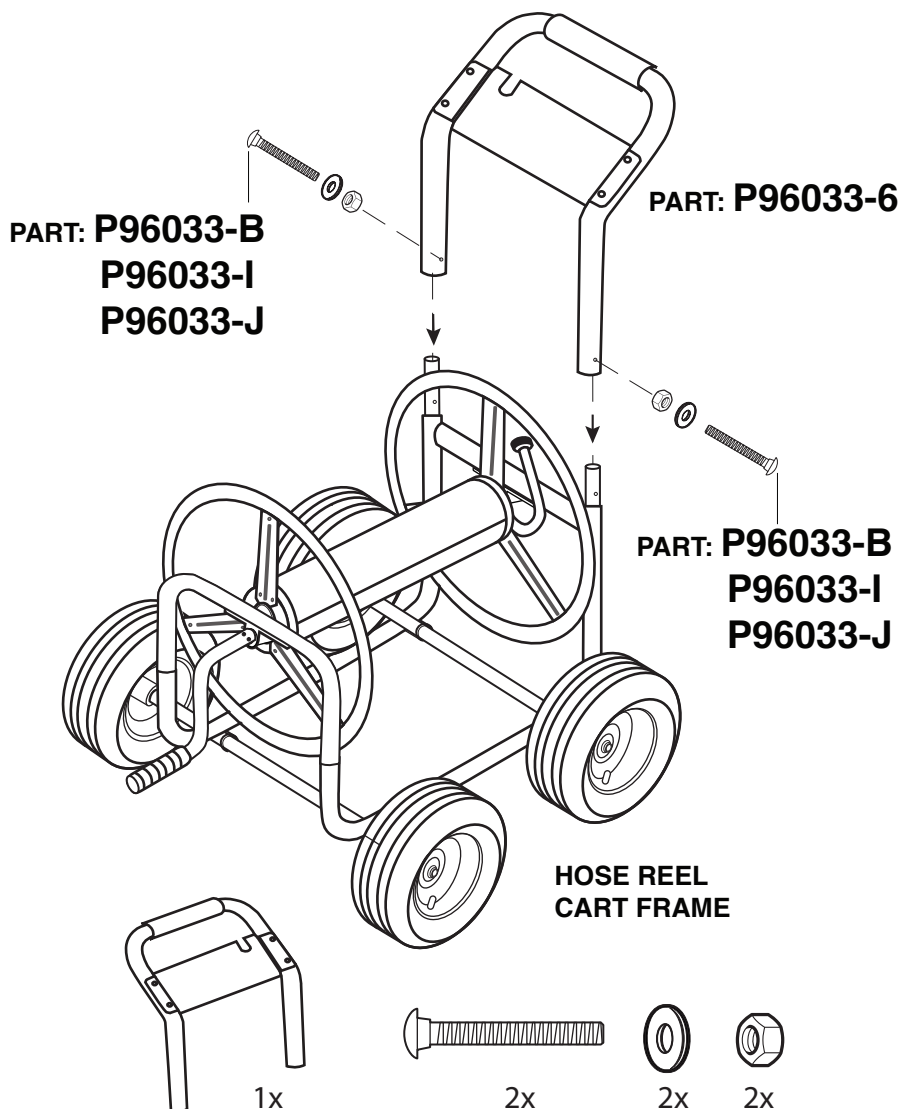

# ASSEMBLY

## STEP 6

Attach PART: P96033-8 to the HANDLE.

Secure it using PART: P96033-D, PART: P96033-E and PART: P96033-F.

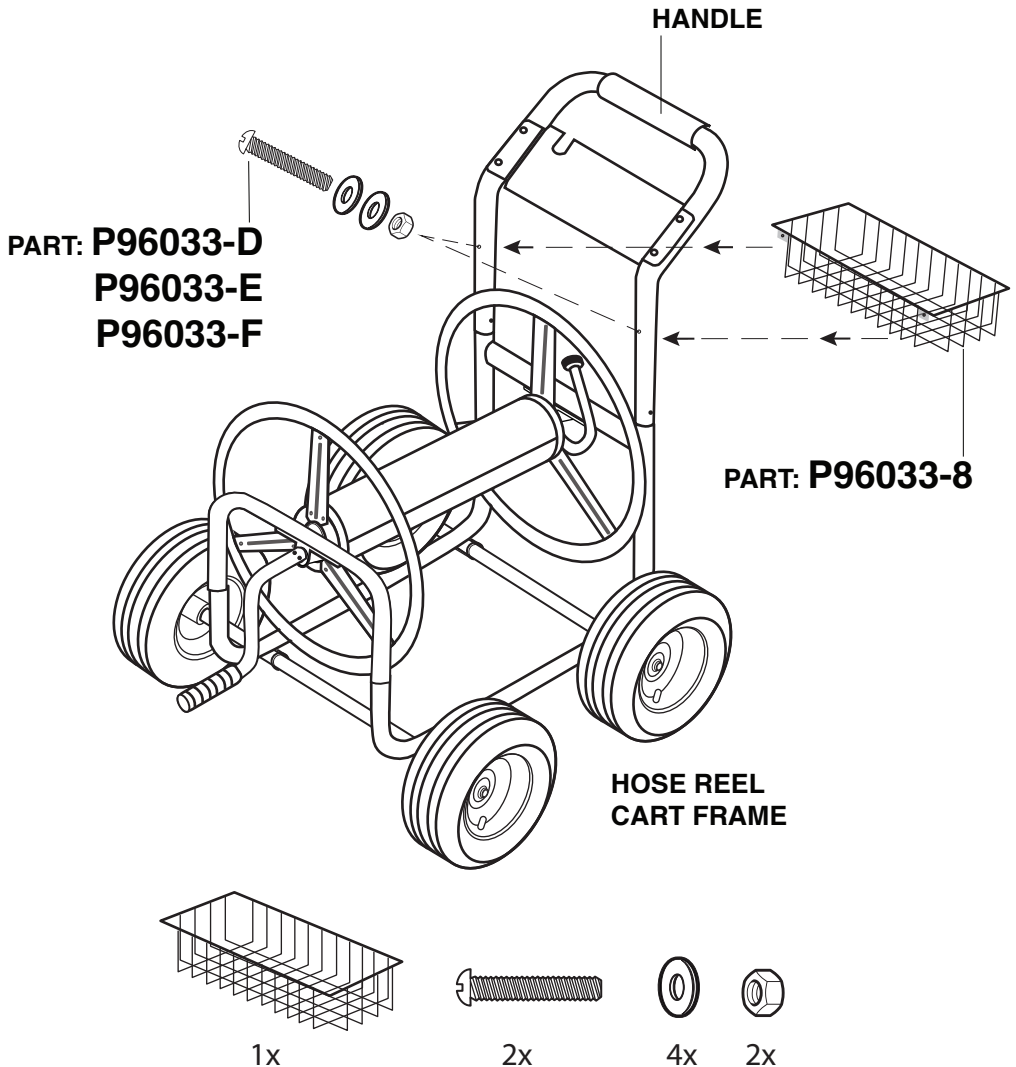

# REPLACEMENT PARTS

## REPLACEMENT PARTS

### PARTS DIAGRAM

#### PART: P96033-1 - P96033-8

PART	DESCRIPTION	QTY
P96033-1	FRAME	1
P96033-2	AXLES	2
P96033-3	WHEELS	4
P96033-4	HOSE REEL	1
P96033-5	CRANK HANDLE	1
P96033-6	HANDLE	1
P96033-7	LEADER HOSE	1
P96033-8	ACCESSORIES BASKET	1

#### PART: P96033-9 (HARDWARE BAG)

PART	DESCRIPTION	QTY
P96033-A	BOLT 6 X 33mm	2
P96033-B	BOLT 6 x 39mm	2
P96033-C	BOLT 6 x 30mm	2
P96033-D	BOLT 8 x 45mm	2
P96033-E	HEX NUT 8mm	2
P96033-F	WASHER 8mm	4
P96033-G	LOCK NUT 12mm	4
P96033-H	WASHER 12mm	4
P96033-I	LOCK NUT 6mm	5
P96033-J	WASHER 6mm	3
P96033-K	ACORN NUT 6mm	1
P96033-L	RUBBER WASHER	2

PART: P96033-6

PART: P96033-8

PART: P96033-1

PART: P96033-3

PART: P96033-4

PART: P96033-5

PART: P96033-2

PART: P96033-7

# REPLACEMENT PARTS

## REPLACEMENT PARTS PARTS DIAGRAM

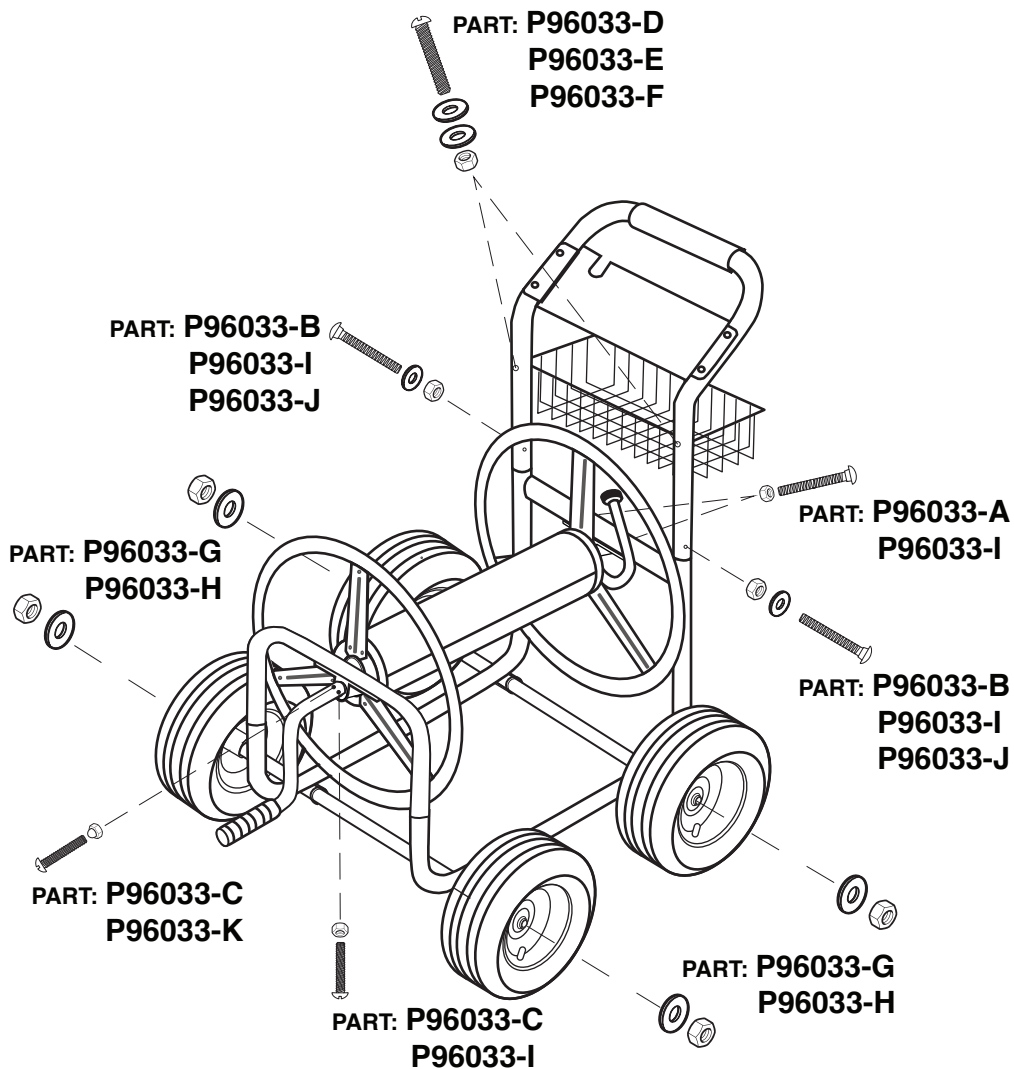



## DISCLAIMER

### ***PLEASE READ THE FOLLOWING CAREFULLY***

---

The manufacturer and/or distributor have provided the parts list and assembly diagram in this manual for reference purposes only. They do not make any representation or warranty to the buyer that they are qualified to make repairs to the product or replace any parts of the product. In fact, the manufacturer and/or distributor expressly state that all repairs and parts replacements should be undertaken by certified and licensed technicians, and not by the buyer.

The buyer assumes all risk and liability arising from their repairs to the original product or replacement parts or arising from their installation of replacement parts. It is strongly advised that qualified professionals handle any repairs or replacements to ensure safety and proper functioning of the product. Improper installation and operation may result in injury, property damage, or voiding of warranty. The manufacturer and/or distributor shall not be held responsible for any accidents, damages, or malfunctions resulting from the buyer's installation and operation of the product. It is essential to follow all safety guidelines and recommendations provided in this manual and to seek professional assistance if unsure about the installation or operation procedures.

---

## CUSTOMER SERVICE

If you have any questions about ordering our pool pumps and replacement parts or other products, please feel free to contact us using the following contact information:

### ***Customer Service and Technical Support***

**Phone:** (909) 628-0880

**Email:** [customer@xtremepowerusa.com](mailto:customer@xtremepowerusa.com)

**Hours of Operation:** Monday – Friday, 9AM – 4PM (CST)

---