



## 300LB MOTORCYCLE HYDRAULIC FLOOR JACK LIFT

ITEM: 96061



### OWNER'S MANUAL AND SAFETY INSTRUCTIONS

SAVE THIS MANUAL: KEEP THIS MANUAL FOR SAFETY WARNINGS, PRECAUTIONS, ASSEMBLY, OPERATING, INSPECTION, MAINTENANCE AND CLEANING PROCEDURES. WRITE THE PRODUCT'S SERIAL NUMBER ON THE BACK OF THE MANUAL NEAR THE ASSEMBLY DIAGRAM (OR MONTH AND YEAR OF PURCHASE IF PRODUCT HAS NO NUMBER)

FOR QUESTIONS PLEASE CALL OUR CUSTOMER SUPPORT: (909) 628 4900 MON-FRI 9AM TO 3PM PST



## GENERAL SAFETY WARNINGS

Read all safety warnings and instructions. Failure to follow the warnings and instructions may result in serious injury. Save all warnings and instructions for future reference.

## SAFETY

The warnings, precautions, and instructions discussed in this instruction manual cannot cover all possible conditions and situations that may occur. It must be understood by the operator that common sense and caution are factors which cannot be built into this product, but must be supplied by the operator. Read carefully and understand all **ASSEMBLY AND OPERATION INSTRUCTIONS** before operating. Failure to follow the safety rules and other basic safety precautions may result in serious personal injury.

- **DO NOT** exceed rated capacity. Be aware of dynamic loading! Bouncing or dropping the load suddenly may briefly create excess load causing product failure.
- Use only on hard, level surfaces.
- Center load on lift platform.
- Immediately after lifting load, ensure that the Locking Bar is in place.
- Before moving, lower the load to the lowest possible point.
- Secure load with appropriate restraint device.
- Wear ANSI-approved safety goggles, heavy-duty work gloves and safety shoes during use
- Keep clear of load while lifting, moving and lowering.
- Lower load slowly.
- Inspect before every use; **DO NOT** use if parts are loose or damaged.
- Keep work area clean and well lit. Cluttered or dark areas invite accidents.
- Keep children and bystanders away while operating. Distractions can cause you to lose control.
- Stay alert. Watch what you are doing, and use common sense when operating. **DO NOT** use while tired or under the influence of drugs, alcohol, or medication. A moment of inattention while operating may result in serious personal injury.
- Store idle lifts out of the reach of children and **DO NOT** allow persons unfamiliar with the lift or these instructions to operate it. Lifts are dangerous in the hands of untrained users.
- Have your lift serviced by a qualified repair person using only identical replacement parts. This will ensure that the safety of the lift is maintained.
- Maintain labels and nameplates on the lift. These carry important information. If unreadable or missing, contact Stark Tools for a replacement.

# SAFETY INFORMATION

- Read lifting requirements in service manual of the motorcycle being lifted.
- Industrial applications must follow OSHA requirements.
- **DO NOT** allow anyone on the lift or the motorcycle/ATV while on the lift.
- Raise Casters off the ground to prevent movement before loading, unloading, raising, or lowering.
- Before lowering, remove all tools and equipment from under lift.
- **WARNING:** The brass components of this product contain lead, a chemical known to the State of California to cause birth defects (or other reproductive harm). (California Health & Safety code § 25249.5, et seq.)
- Only use this lift to raise a motorcycle or an ATV to perform maintenance. **DO NOT** attempt to transport or relocate motorcycle/ATV while on the Lift.
- The maximum load is 300LBS. **DO NOT** exceed this rated capacity.



**SAVE THESE INSTRUCTIONS.**

# FEATURES AND SPECIFICATIONS



Lifting up to 300 lbs., the Hydraulic Motorcycle Lift Table is perfect for tinkering on your dirt bike or small motorcycle. Set your bike on the table, secure it through the foot pegs with the included fasteners and lift away with the easy-to-use foot pedal; no tools required. Rising to a maximum height of 34.5 in., the lift table eliminates the need to stoop or kneel while working on your bike. Once the desired height is achieved, a locking bar secures the height, ensuring the lift never drops from accidental contact with the release pedal. All necessary hardware included. Lifted Height: 34.5 in. Collapsed Height: 13.25 in. Platform Dimensions: 16.25 in. Length x 13.25 in. Width. Lift Capacity: 300 lbs.

## FEATURES

- Thick rubber non-slip pad
- Fully welded
- Adjustable height, from 13.5" thru 36" inches off the ground
- Heavy-duty steel frame construction
- Large oil drain hole
- Platform Size - 16" x 13.5"
- Safety lock bar included
- Included hooks lock onto pegs
- 300 lbs weight capacity

<b>Max Capacity:</b>	135kg
<b>Max Height:</b>	870mm
<b>Min. Height</b>	350mm
<b>Platform Size</b>	410 x 350mm
<b>New Weight:</b>	29kg
<b>Gross Weight:</b>	31kg



# PARTS LIST

#	DESCRIPTION	QTY
1	Rubber Pad	1
2	Steel Plate	1
3	Upper Frame	1
4	Damping Nut M8	8
5	Threaded Knob	2
6	Washer	2
7	U-Bolt	2
8	J-Hook	2
9	Upper Roller	2
10	Fixing Block	8
11	Lower Roller	2
12	Pump	1
13	Bolt M10	1
14	Foot Pedal Pad	1
15	Foot Pedal	1
16	Pin Shaft	1
17	Pedal Release	1
18	Connecting Plate	1
19	Connecting Plate	1
20	R-Pin	2
21	Lock Washer M8	2
22	Bolt M x 16	2
23	Locking Bar	1
24	Frame Base	1
25	Damping Nut M5	8
26	Washer M5	8
27	Bolt M5 x 40	8
28	Damping Nut M4	1
29	Washer M8	1
30	Bolt M 8 x 12	1
31	Damping Nut M10	1
32	Lifitng Arm Assy	1

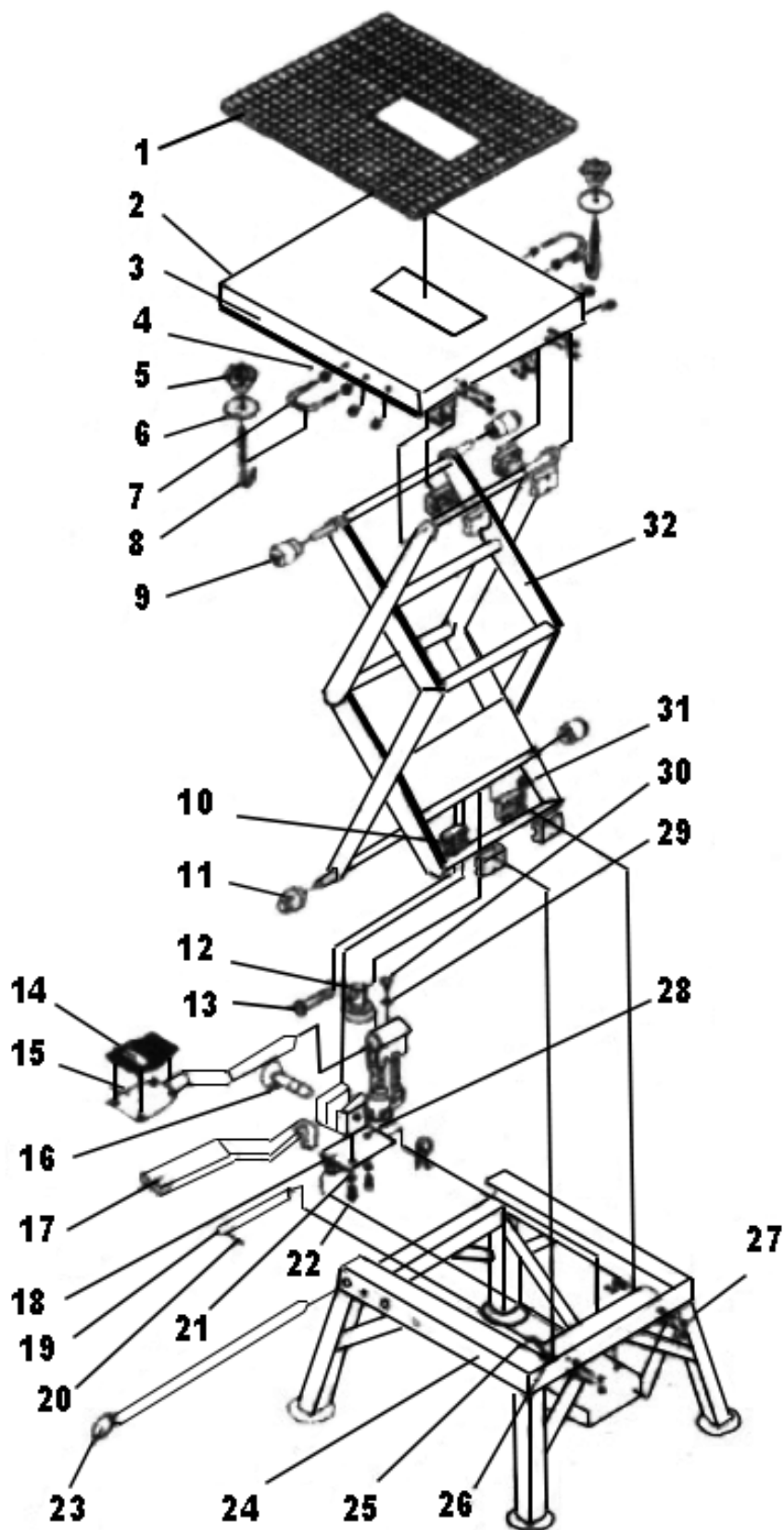

# MAINTENANCE

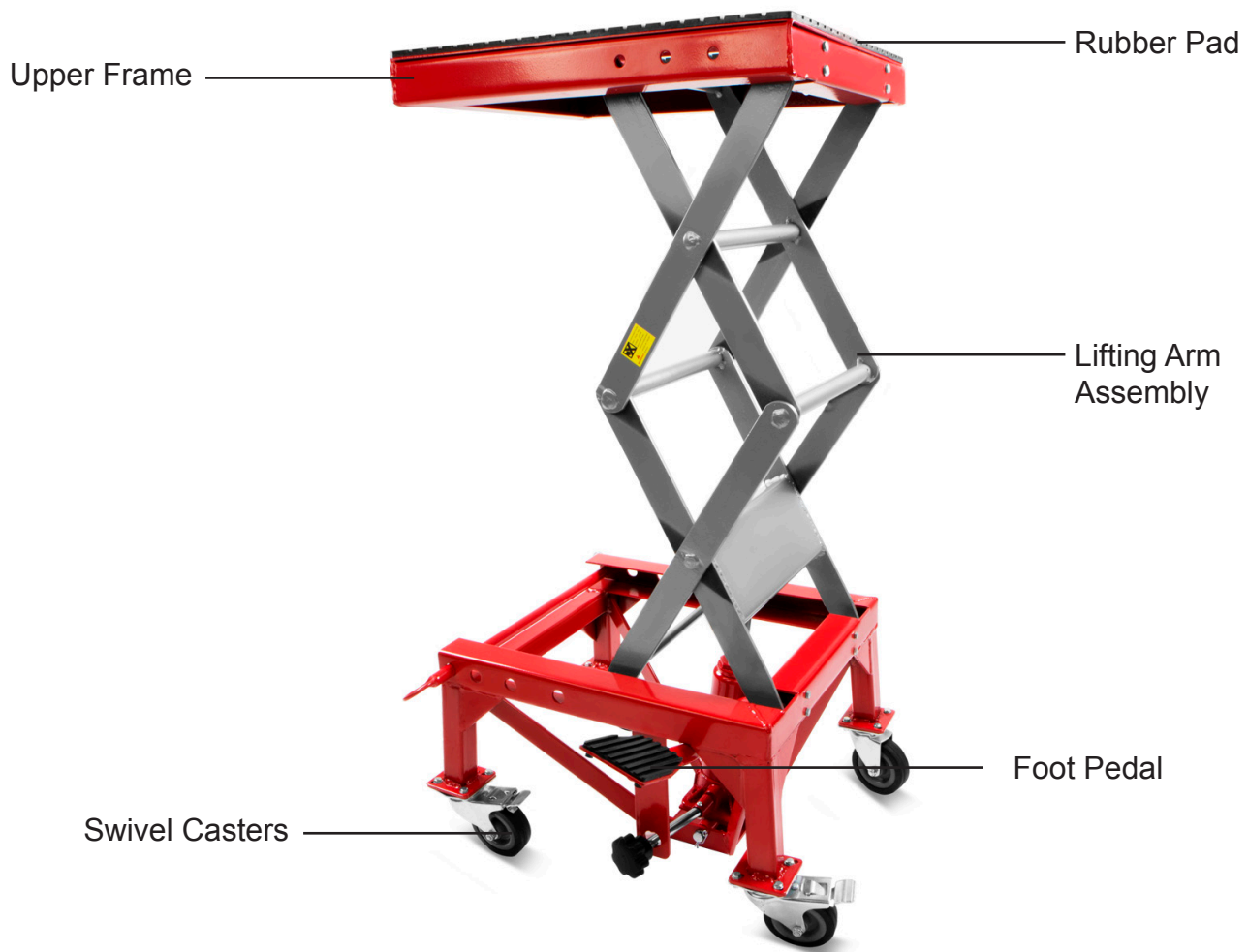

- When not in use, the lift must be stored in the lowest position in a dry location to minimize ram and piston corrosion.
- Keep the lift clean and wipe off any oil or grease.
- Prior to using the lift, lubricate all moving parts.
- Periodically check the ram and piston for signs of corrosion. Clean exposed areas with a clean, oiled cloth.
- Periodically check the ram and piston for signs of corrosion. Clean exposed areas with a clean, oiled cloth.
- Before each use, check that all parts are in working order. If any part is damaged or suspect, remove the lift from service and take necessary action to repair it BEFORE using the lift.
- When the lift efficiency drops, open the release valve and pump the foot pedal rapidly 15 to 20 times to purge out any air from the hydraulic system.

# DISCLAIMER

## PLEASE READ THE FOLLOWING CAREFULLY

THE MANUFACTURER AND/OR DISTRIBUTOR HAS PROVIDED THE PARTS LIST AND ASSEMBLY DIAGRAM IN THIS MANUAL AS A REFERENCE TOOL ONLY. NEITHER THE MANUFACTURER OR DISTRIBUTOR MAKES ANY REPRESENTATION OR WARRANTY OF ANY KIND TO THE BUYER THAT HE OR SHE IS QUALIFIED TO MAKE ANY REPAIRS TO THE PRODUCT, OR THAT HE OR SHE IS QUALIFIED TO REPLACE ANY PARTS OF THE PRODUCT. IN FACT, THE MANUFACTURER AND/OR DISTRIBUTOR EXPRESSLY STATES THAT ALL REPAIRS AND PARTS REPLACEMENTS SHOULD BE UNDERTAKEN BY CERTIFIED AND LICENSED TECHNICIANS, AND NOT BY THE BUYER. THE BUYER ASSUMES ALL RISK AND LIABILITY ARISING OUT OF HIS OR HER REPAIRS TO THE ORIGINAL PRODUCT OR REPLACEMENT PARTS THERETO, OR ARISING OUT OF HIS OR HER INSTALLATION OF REPLACEMENT PARTS THERETO.

**Record Product's Serial Number Here:** \_\_\_\_\_

**Note:** If product has no serial number, record month and year of purchase instead.

**Note:** Some parts are listed and shown for illustration purposes only and are not available individually as replacement parts.



**SAVE THESE INSTRUCTIONS.**

The material in this manual is for informational purposes only. The product(s) it describes are subject to change without prior notice, due to the manufacturer's continuous development program. Stark Tools makes no representations or warranties with respect to this manual or with respect to the products described herein. Stark Tools shall not be liable for any damages, losses, costs or expenses, direct, indirect or incidental, consequential or special, arising out of, or related to the use of this material or the products described herein.

## Questions, issues or missing parts?

Before returning to your retailer, our customer service team is here to help.



**Call Us: 909.628.4900**

**Email Us: [info@starktoolsusa.com](mailto:info@starktoolsusa.com)**

**Hours of Operation: 9am - 3pm PST Monday - Friday**

MADE IN CHINA